

OWNER'S STATEMENT

PACIFIC PENINSULA GROUP, A CALIFORNIA CORPORATION, HAVING RECORD TITLE INTEREST IN THE HEREON SUBDIVIDED LANDS DOES HEREBY CONSENT TO THE PREPARATION AND RECORDATION OF THIS MAP, AND DOES HEREBY OFFER FOR DEDICATION, FOR THE HEREINAFTER DESCRIBED PURPOSES, THE FOLLOWING EASEMENTS:

1. INGRESS, EGRESS, SUPPORT AND PUBLIC UTILITIES.

HAWK RIDGE, AS SHOWN ON THE MAP, FOR PUBLIC UTILITY PURPOSES, AND FOR INGRESS, EGRESS, SUPPORT AND USE BY ALL PUBLIC UTILITIES, LAW ENFORCEMENT, FIRE PROTECTION, WELFARE AND OTHER RELATED PUBLIC OR COUNTY AGENCIES, THEIR VEHICLES AND PERSONNEL, FOR THE SOLE PURPOSE OF PERFORMING OFFICIAL BUSINESS.

2. UTILITIES.

EASEMENTS FOR INSTALLATION, MAINTENANCE AND REPAIR OF ALL UTILITIES CONSTRUCTED OVER, ON, ACROSS AND UNDER THE PUBLIC UTILITY EASEMENTS (P.U.E) AND LOT 'A', AS SHOWN ON THE MAP, WITH THE RIGHT TO TRIM AND REMOVE, AS OFTEN AS NECESSARY, TREES, LIMBS AND BRUSH FOR THE SOLE PURPOSE OF INSTALLING, MAINTAINING, AND/OR REPAIRING SAID UTILITIES.

LOT 'A', AS SHOWN ON THE MAP, WILL BE GRANTED TO THE COMMON USE AND ENJOYMENT OF THE OWNERS OF WHITEHAWK RANCH PHASE IX UNIT 3A FOR THE PROTECTION OF LIGHT, SPACE, NATURAL ENVIRONMENT AND HABITAT, AND FOR RECREATION USES TO THE EXTENT SUCH USES ARE CONSISTENT WITH THE ABOVE-DESCRIBED EASEMENTS. SAID LOT 'A' WILL BE MAINTAINED BY THE WHITEHAWK RANCH HAWK RIDGE OWNERS' ASSOCIATION.

HAWK RIDGE, AS SHOWN ON THE MAP, WILL BE GRANTED TO THE WHITEHAWK RANCH HOMEOWNERS' ASSOCIATION AS PRIVATE ACCESS AREAS FOR THE COMMON USE OF THE OWNERS OF LOTS 1 THROUGH 22 OF WHITEHAWK RANCH PHASE IX UNIT 3A AND OWNERS OF LOTS IN ANY OTHER PHASE OF WHITEHAWK RANCH. SAID PRIVATE ACCESS AREAS WILL BE MAINTAINED BY THE WHITEHAWK RANCH HOMEOWNERS' ASSOCIATION.

EASEMENT NO. 3 WHICH INCLUDES THE ENTIRETY OF LOT A, AS SHOWN ON THE MAP, IS RESERVED FOR FUTURE PRIVATE ROADS, DRAINAGE AND PUBLIC UTILITY PURPOSES. THIS EASEMENT WILL NOT BECOME EFFECTIVE UNLESS AND UNTIL A RESERVATION IS INCLUDED IN THE GRANT OF LOT A TO THE WHITEHAWK RANCH HAWK RIDGE OWNERS' ASSOCIATION.

PACIFIC PENINSULA GROUP, A CALIFORNIA CORPORATION

BY: Christopher E. Wuthmann TITLE: PRINCIPAL AND SECRETARY
CHRISTOPHER E. WUTHMANN

STATE OF CALIFORNIA
COUNTY OF San Mateo

ON 4/22 2002, BEFORE ME Susan E Burnett PERSONALLY APPEARED CHRISTOPHER E. WUTHMANN PERSONALLY KNOWN TO ME (OR PROVED TO ME ON THE BASIS OF SATISFACTORY EVIDENCE) TO BE THE PERSON WHOSE NAME IS SUBSCRIBED TO THE WITHIN INSTRUMENT AND ACKNOWLEDGED TO ME THAT HE EXECUTED THE SAME IN HIS AUTHORIZED CAPACITY, AND THAT BY HIS SIGNATURE ON THE INSTRUMENT THE PERSON, OR THE ENTITY UPON BEHALF OF WHICH THE PERSON ACTED, EXECUTED THE INSTRUMENT.

WITNESS MY HAND AND OFFICIAL SEAL

[Signature]
COMM exp 5/6/02
COMM # 1178910

COUNTY BOARD CLERK'S CERTIFICATE

I, NANCY DaFORNO, CLERK TO THE PLUMAS COUNTY BOARD OF SUPERVISORS, HEREBY CERTIFY THAT THE HEREIN EMBODIED MAP WAS APPROVED BY SAID BOARD OF SUPERVISORS CONVENED IN A REGULAR MEETING UPON THE DAY OF July 2002. THE OFFER OF DEDICATION FOR HAWK RIDGE, LOT 'A' AND THE PUBLIC UTILITY EASEMENTS AS SHOWN ON THE MAP WERE ACCEPTED FOR THE USES NOTED.

DATED: 7/23/02

Nancy DaForno
NANCY DaFORNO
CLERK TO THE BOARD OF SUPERVISORS

TRUSTEE'S CERTIFICATE

FIDELITY NATIONAL TITLE INSURANCE COMPANY, A CALIFORNIA CORPORATION AS TRUSTEE UNDER DEEDS OF TRUST DATED SEPTEMBER 5, 2001 AND RECORDED IN DOCUMENT NO. 2001-8311 OF OFFICIAL RECORDS, PLUMAS COUNTY RECORDS, DOES HEREBY CONSENT TO THE PREPARATION AND RECORDING OF THIS MAP, AND TO THE DEDICATION OF HAWK RIDGE, LOT 'A' AND THE PUBLIC UTILITY EASEMENTS (P.U.E.), AS SHOWN ON THE MAP FOR THE PURPOSES NOTED.

DATED: 4-24-02

BY: Helen M. Strain
HELEN M. STRAIN
ASST. VICE-PRESIDENT

STATE OF CALIFORNIA
COUNTY OF PLUMAS

ON APRIL 24 2002, BEFORE ME MARY W. LEWIS PERSONALLY APPEARED HELEN STRAIN PERSONALLY KNOWN TO ME (OR PROVED TO ME ON THE BASIS OF SATISFACTORY EVIDENCE) TO BE THE PERSON WHOSE NAME IS SUBSCRIBED TO THE WITHIN INSTRUMENT AND ACKNOWLEDGED TO ME THAT SHE EXECUTED THE SAME IN HER AUTHORIZED CAPACITY, AND THAT BY HER SIGNATURE ON THE INSTRUMENT THE PERSON, OR THE ENTITY UPON BEHALF OF WHICH THE PERSON ACTED, EXECUTED THE INSTRUMENT.

WITNESS MY HAND AND OFFICIAL SEAL.

Mary W. Lewis
Commission Expires Nov. 27, 2005
Commission # 1163401

*A Trustee's Certificate
Consenting to the preparation
and recording of this map is
on file with the County
Recorder in Document
No. 2002-7185 of Official
Records.*

ENGINEER'S STATEMENT

THIS MAP WAS PREPARED BY ME OR UNDER MY DIRECTION AND IS BASED UPON A FIELD SURVEY IN CONFORMANCE WITH THE REQUIREMENTS OF THE SUBDIVISION MAP ACT AND LOCAL ORDINANCE AT THE REQUEST OF PACIFIC PENINSULA GROUP, INC., IN FEBRUARY 2002. I HEREBY STATE THAT THIS FINAL MAP SUBSTANTIALLY CONFORMS TO THE CONDITIONALLY APPROVED TENTATIVE MAP. THE SURVEY IS TRUE AND COMPLETE AS SHOWN. ALL OF THE MONUMENTS SHOWN HEREON ARE OF THE CHARACTER AND OCCUPY THE POSITIONS INDICATED, OR THEY WILL BE SET IN SUCH POSITIONS ON OR BEFORE ONE YEAR AFTER RECORDATION OF THIS MAP BY THE PLUMAS COUNTY RECORDER. THE MONUMENTS ARE, OR WILL BE SUFFICIENT TO ENABLE THE SURVEY TO BE RETRACED.

DATED: 4/25/02



Daniel B. Bastian
DANIEL B. BASTIAN
L.S. 7045

LICENSE EXP. DATE: 12/31/02

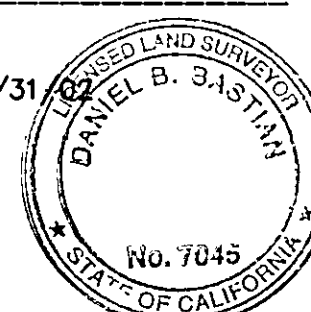
**COUNTY SURVEYOR'S STATEMENT**

I HAVE EXAMINED THIS MAP AND FIND IT IS SUBSTANTIALLY THE SAME AS IT APPEARED ON THE TENTATIVE MAP AND ANY APPROVED ALTERATIONS THEREOF. ALL PROVISIONS OF THE SUBDIVISION MAP ACT AND ANY LOCAL ORDINANCES APPLICABLE AT THE TIME OF APPROVAL OF THE TENTATIVE MAP HAVE BEEN COMPLIED WITH; AND I AM SATISFIED THAT THE MAP IS TECHNICALLY CORRECT.

DATED: 7/23/02

R. Tom Hunter
R. TOM HUNTER, R.C.E. 30515
PLUMAS COUNTY SURVEYOR
LICENSE EXP. DATE: 3/31/04

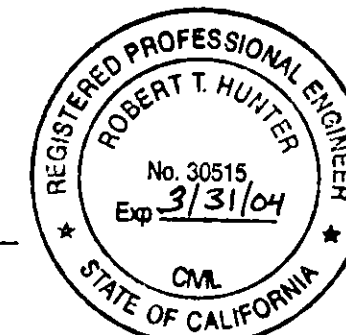
**COUNTY TAX COLLECTOR'S CERTIFICATE**

I, BARBARA J. COATES, TAX COLLECTOR OF THE COUNTY OF PLUMAS, STATE OF CALIFORNIA, DO HEREBY CERTIFY THAT THERE ARE NO TAX LIENS AGAINST THE LOTS, AS SHOWN HEREON, FOR UNPAID STATE, COUNTY, MUNICIPAL, OR LOCAL TAXES OR SPECIAL ASSESSMENTS COLLECTED AS TAXES, EXCEPT TAXES OR ASSESSMENTS NOT YET PAYABLE. TAXES OR ASSESSMENTS WHICH ARE A LIEN BUT NOT YET PAYABLE, ARE ESTIMATED TO BE IN THE AMOUNT OF \$ 14,028.00.

DATED: 5-20-02

Barbara J. Coates
BARBARA J. COATES
PLUMAS COUNTY TAX COLLECTOR

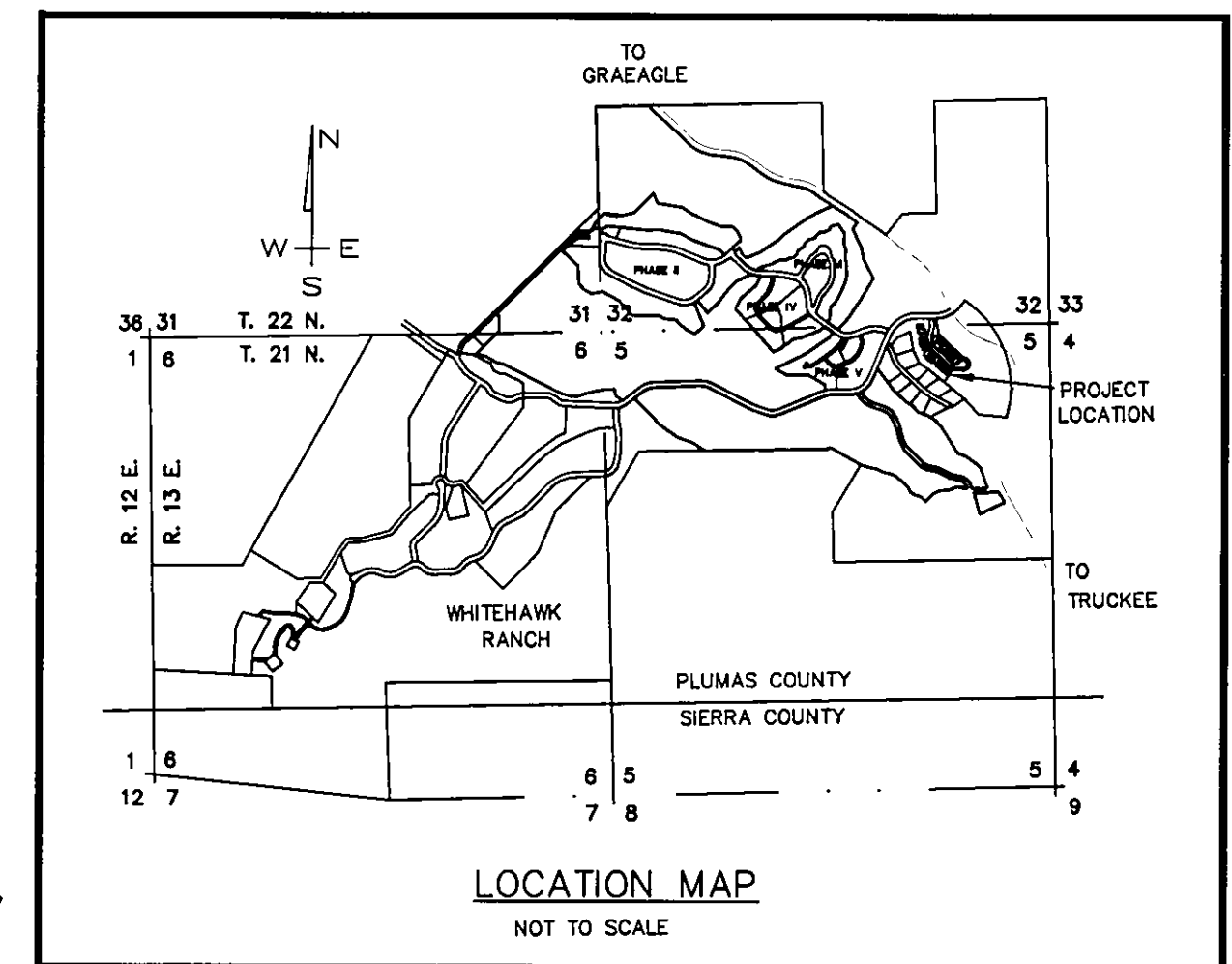
**COUNTY RECORDER'S CERTIFICATE**

FILED THIS 26 DAY OF July 2002, AT 3:28 PM. IN BOOK 9 OF MAPS, AT PAGE 64-66 AT THE REQUEST OF THE COUNTY SURVEYOR.

FEE: \$12.00

DOC. NO. 2002-7185

JUDITH WELLS
COUNTY RECORDER

BY: Cathy Samuel
DEPUTY

AREA TABULATION

LOTS 1 THROUGH 22 ----- 1.88 AC.
LOT A (COMMON AREA) -- 4.42 AC.
HAWK RIDGE ----- 1.05 AC.
TOTAL ----- 7.35 AC.

WHITEHAWK RANCH PHASE IX, UNIT NO. 3A A PLANNED DEVELOPMENT

FOR
PACIFIC PENINSULA GROUP,
A CALIFORNIA CORPORATION
WITHIN PORTIONS OF SECTION 5, T. 21 N., R. 13 E., M.D.M.
AND SECTION 32, T. 22 N., R. 13 E., M.D.M.
PLUMAS COUNTY, CALIFORNIA

PREPARED BY:
BASTIAN ENGINEERING
P.O. BOX 280
GRAEAGLE, CALIFORNIA 96103
L.S. 7045

FEBRUARY 2002

SHEET 1 OF 3