

LEGEND
 o Indicates 3/4" Pipe Set and Tagged L.S. 2322
 SCALE 1" = 100'

SURVEYOR'S CERTIFICATE

This map correctly represents a survey made by me or under my direction in conformance with the requirements of the Land Surveyors Act in June 1966 at the request of Tom N. Tibbs.

Loren J. Sargent
 L.S. 2322
 STATE OF CALIFORNIA
 LAND SURVEYOR
 2322

COUNTY SURVEYOR'S CERTIFICATE

This map has been examined for conformance with the requirements of the Land Surveyors Act this 12th day of July, 1967

Lawrence J. Brock
 COUNTY SURVEYOR

RECORDER'S CERTIFICATE

Filed for record this 17 day of July, 1967 at 11:45 A.M. in Book L of Parcel Maps at pg 83 at the request of *Loren J. Sargent*

Ida Hogan Gronwald
 COUNTY RECORDER

PARCEL MAP

A SURVEY OF A PARCEL OF LAND AND AN EASEMENT IN THE SW 1/4 OF THE NW 1/4 OF SECTION 27, T.28N. R.8E. M.D.M. IN THE UNINCORPORATED TERRITORY OF PLUMAS COUNTY, CALIFORNIA

FOR
 TOM N. TIBBS
 LOREN J. SARGENT L.S. 2322
 SHEET 1 OF 1 SHEET

SCALE 1" = 100'

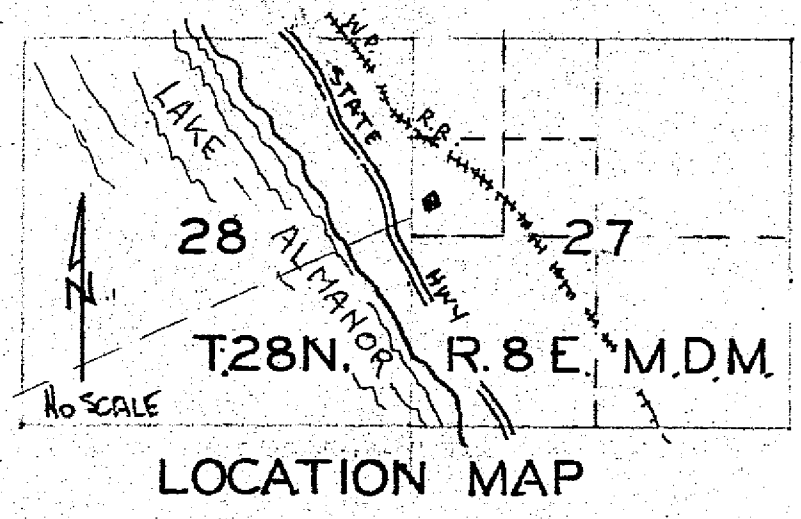

28 0 27
 1/4 602
 T28N R.8E