

LEGEND  
 o Indicates 3/4" Pipe Set and Tagged L.S. 2322  
 SCALE 1"=100'

SURVEYOR'S CERTIFICATE

This map correctly represents a survey made by me or under my direction in conformance with the requirements of the Land Surveyors Act in June 1966 at the request of Tom N. Tibbs.

*Loren J. Sargent*  
 L.S. 2322  
 2322  
 STATE OF CALIFORNIA

COUNTY SURVEYOR'S CERTIFICATE

This map has been examined for conformance with the requirements of the Land Surveyors Act this 12<sup>th</sup> day of July, 1967

*Lawrence J. Brock*  
 COUNTY SURVEYOR

RECORDER'S CERTIFICATE

Filed for record this 17 day of July, 1967 at 11:45 A.M. in Book L of Parcel Maps at pg 83 at the request of *Loren J. Sargent*

*Ida Hogan Gronwald*  
 COUNTY RECORDER

PARCEL MAP

A SURVEY OF A PARCEL OF LAND AND AN EASEMENT IN THE SW 1/4 OF THE NW 1/4 OF SECTION 27, T28N, R.8E, MDM. IN THE UNINCORPORATED TERRITORY OF PLUMAS COUNTY, CALIFORNIA

FOR  
 TOM N. TIBBS  
 LOREN J. SARGENT L.S. 2322  
 SHEET 1 OF 1 SHEET

SCALE 1"=100'

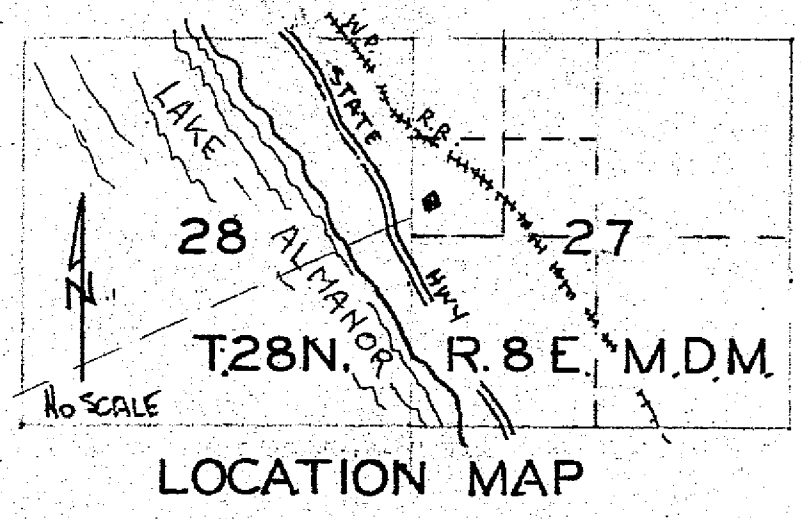

28 0 27  
 1/4 6 2  
 T28N, R.8E