

BASIS OF BEARINGS:

SW COR. OF NE 1/4 OF NE 1/4 OF SEC. 29 PER R1

PT A TO PT B AS N61°55'09" E, 1460.69' meas. (1460.25') AS CALCULATED PER 2 MAPS 88.

EGGERT DOC. NO. 2005-0005267

LEGEND

- FND. 3/4" IRON PIPE AS NOTED
- ✕ FND. REBAR RCE 22836 IN ROCK MOUND SET PER 8 R/S 44
- ⊕ FND. 1/2" IP IN FENCE LINE AS NOTED
- △ SET REBAR & CAP PLS 5296
- ▲ SET RAILROAD SPIKE W/CROSS WITNESS CORNER
- SFNF SEARCHED FOR NOT FOUND
- NT NO TAG
- NTS NOT TO SCALE

NOTES

1. PARCEL AREA: 19.93 ACRES
2. ALL DIMENSIONS ARE IN FEET AND DECIMALS THEREOF.

SURVEYOR'S STATEMENT

THIS MAP CORRECTLY REPRESENTS A SURVEY MADE BY ME OR UNDER MY DIRECTION IN CONFORMANCE WITH THE REQUIREMENTS OF THE PROFESSIONAL LAND SURVEYORS' ACT AT THE REQUEST OF JAMASON IN APRIL, 2020.

Steven H. Jacobs
STEVEN H. JACOBS
PLS 5296 EXP. 12-31-21



AN EASEMENT FOR INGRESS, EGRESS PUBLIC UTILITIES AND INCIDENTAL PURPOSES INSTR. NO. 2001-5856

APPURTENANT TO LOT 7

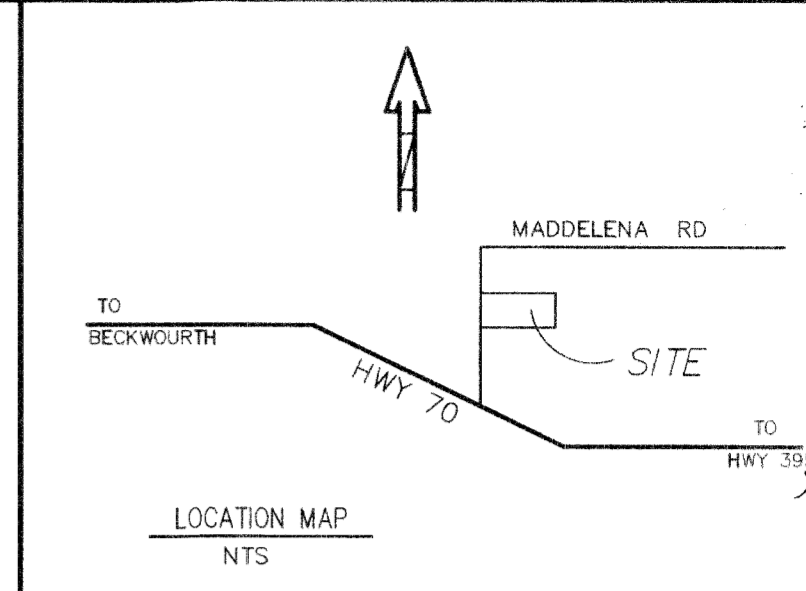

PURPOSE OF SURVEY NOTE:

THE PURPOSE OF THIS SURVEY WAS TO RECOVER ANY EXISTING PROPERTY CORNERS OF LOT 2 AND TO MONUMENT THE SIDELINES OF THE THIRTY FOOT STRIPS EXTENDING FROM LOTS 6 AND 7 TO MADDELEENA ROAD.

RECORDER'S STATEMENT

FILED THIS 15 DAY OF September 2020, AT 1:11 PM IN BOOK 16 OF MAPS AT PAGE 77 AT THE REQUEST OF THE COUNTY SURVEYOR.

FEE: \$83.00

KATHLEEN WILLIAMS
COUNTY RECORDER

DOCUMENT NO. 2020-0005425

BY: *Julie Hayward*
DEPUTY

COUNTY SURVEYOR'S STATEMENT

THIS MAP HAS BEEN EXAMINED IN ACCORDANCE WITH SECTION 8766 OF THE PROFESSIONAL LAND SURVEYORS' ACT THIS 15th DAY OF SEPTEMBER, 2020.

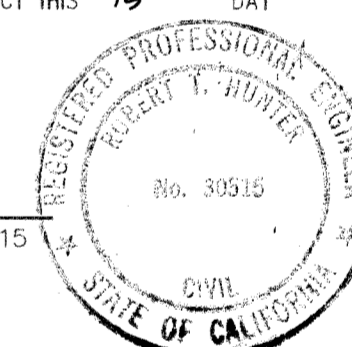

R. Tom Hunter
ROBERT THOMAS HUNTER RCE 30515
PLUMAS COUNTY SURVEYOR
LIC. EXP. DATE 3/31/2022

RECORD OF SURVEY

THE LANDS OF JAMASON

DOC. No. 2000-08461
LOT 2 OF 2 MAPS 88

AND A PORTION OF THE SOUTHERLY LINE OF LOT 6, BEING THE LANDS OF GOLDSMITH DOC. No. 2003-002449

AND A PORTION OF LOT 7 BEING THE LANDS OF GOLDSMITH/JAMASON DOC. No. 2019-0001575

LYING WITHIN SECTIONS 28 & 29, T23N, R15E, M.D.B.&M.

APN 010-040-02, -03, & -04
APRIL, 2020 SCALE: 1"=150'

PLUMAS COUNTY ~ CALIFORNIA

JACOBS LAND SURVEYING
P.O. BOX 7829
COTATI, CA. 94931
707-795-0733

JOB NO. 19-1500-M FB#32
DWG FILE: 2020\DWGS\APRIL\JAMASON

16 RS 77