

**BASIS OF BEARINGS**

FOR THIS SURVEY IS NORTH 71°15'00" EAST BEING THE CALCULATED BEARING BETWEEN TWO FOUND MONUMENTS ON THE SOUTH LINE OF STATE HIGHWAY 40 ALTERNATE PER R-2.

REASONS FOR MANDATORY FILING ARE PER LAND SURVEYORS ACT SECTION 8762 (B)(4)

**LEGEND**

- FOUND MONUMENT AS NOTED
- SET 5/8" REBAR W/PLASTIC CAP LS 5571
- R-1 3 RS 61
- R-2 2 M 31-33
- R-3 10 RS 39
- DD-1 VOL 466 PAGE 516 O.R.
- ( ) RECORD INFORMATION
- S.F. SQUARE FEET
- CF CALCULATED FROM
- RAD RADIAL
- O.R. OFFICIAL RECORDS, PLUMAS COUNTY
- INT INTERSECTION
- L HELD 90°
- SURVEYED PROPERTY LINE
- - - CENTERLINE
- - - - RIGHT OF WAY LINE

KEN WILSON, LS 5571  
 WILSON LAND SURVEYS, INC.  
 805-703-0273  
 KENW@WILSONLANDSURVEYS.COM  
 261 CARLTON COURT  
 LOS GATOS, CA 95032

**SURVEYOR'S STATEMENT**

THIS MAP CORRECTLY REPRESENTS A SURVEY MADE BY ME OR UNDER MY DIRECTION IN CONFORMANCE WITH THE REQUIREMENTS OF THE PROFESSIONAL LAND SURVEYOR'S ACT AT THE REQUEST OF PORTOLA CONGREGATION OF JEHOVAH'S WITNESSES IN JANUARY 2018.

*Kenn D Wilson* 10-18-19

KENNETH D. WILSON LS 5571

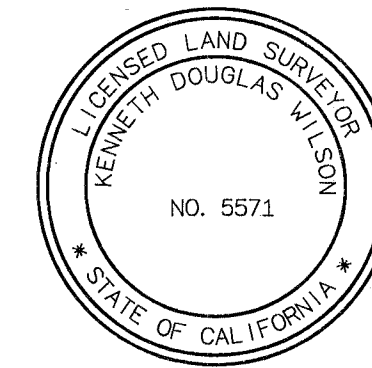

**COUNTY SURVEYOR'S STATEMENT**

THIS MAP HAS BEEN EXAMINED IN ACCORDANCE WITH SECTION 8766 OF THE PROFESSIONAL LAND SURVEYORS ACT THIS 22 DAY OF NOVEMBER 2019.

*R Tom Hunter*

TOM HUNTER RCE 30515  
 PLUMAS COUNTY SURVEYOR  
 LICENSE EXPIRATION DATE: 03/31/2020

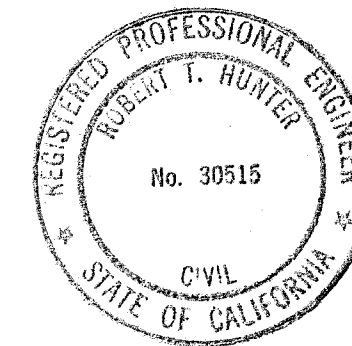

**RECORDER'S STATEMENT**

FILED THIS 20th DAY OF November 2019 AT 3:45 P.M. IN BOOK 16 OF RECORD OF SURVEYS AT PAGE 66 AT THE REQUEST OF PLUMAS COUNTY SURVEYOR.

DOCUMENT NO. 2019-0006131 FEE \$83.00

KATHLEEN WILLIAMS  
 COUNTY CLERK RECORDER  
 BY: *Kathleen Williams*  
 DEPUTY

**RECORD OF SURVEY**

AS REQUESTED BY:  
**PORTOLA CONGREGATION OF JEHOVAH'S WITNESSES**

LEGAL DESCRIPTION: PARCEL OF LAND IN SECTION 30, TOWNSHIP 23 NORTH, RANGE 14 EAST, MOUNT DIABLO MERIDIAN IN THE COUNTY OF PLUMAS, STATE OF CALIFORNIA AS DESCRIBED IN VOLUME 466 PAGE 516 OF OFFICIAL RECORDS.

APN: 125-332-003  
 DATE: JANUARY 2018  
 FILENAME: USA2360 RECORD OF SURVEY  
 SITE ADDRESS: 76501 ROCKY POINT ROAD PORTOLA, CA 96122

DRAWN BY: KDW	SCALE: 1"=80'	PROJECT: USA2360	SHEET: 1 OF 1
------------------	------------------	---------------------	------------------

16 RS 66

