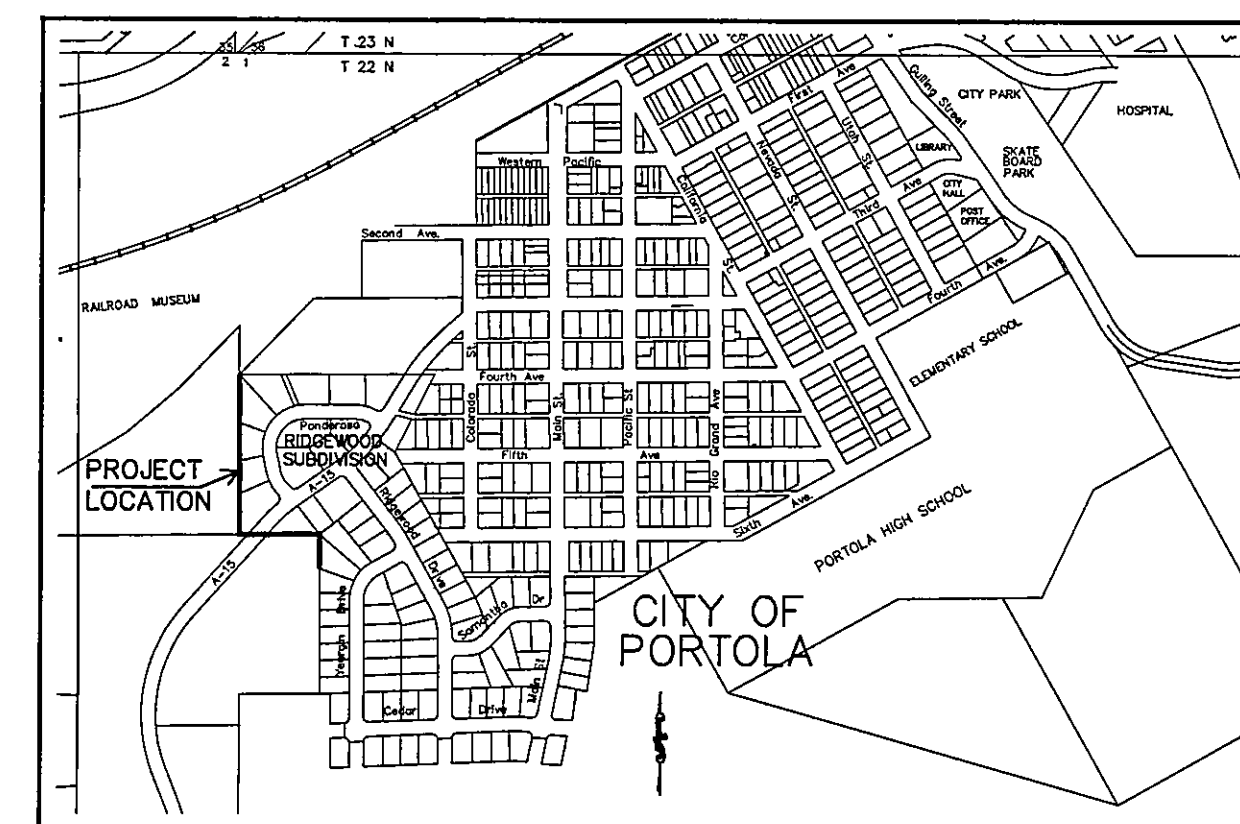
**LEGEND**

- FOUND 1/2" REBAR WITH PLASTIC CAP
STAMPED L.S. 3297 PER 5 M 45.
- SET 1/2" REBAR WITH ALUMINUM
CAP STAMPED LS 7045
- + COMPUTED POINT, NOTHING FOUND OR SET
- ⊥ RECORD MONUMENTS NOT SEARCHED FOR.
- () RECORD DATA PER 5 M 45
- ()R1 RECORD DATA PER 10 RS 118
- 5 M 45 RECORD MAP, BOOK AND PAGE
- (C) INDICATES CALCULATED DATA PER 5 M 45.

NOTE:

1. THE BASIS OF BEARINGS FOR THIS MAP IS THE WEST LINE OF LOT 39, BETWEEN TWO FOUND MONUMENTS SHOWN ON THE MAP OF RIDGEWOOD SUBDIVISION UNIT NO. 1, IN BOOK 5 OF MAPS AT PAGE 45, PLUMAS COUNTY RECORDS, AND SHOWN AS NORTH 00°52'29" WEST.

**LOCATION MAP**

NTS

SURVEYOR'S STATEMENT

THIS MAP CORRECTLY REPRESENTS A SURVEY MADE BY ME OR UNDER MY DIRECTION IN CONFORMANCE WITH THE REQUIREMENTS OF THE PROFESSIONAL LAND SURVEYORS' ACT, AT THE REQUEST OF MARCEL CHANG IN DECEMBER 2011.

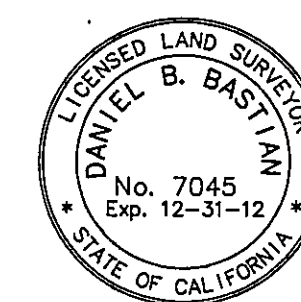

Daniel B. Bastian
DANIEL B. BASTIAN
L.S. 7045
LICENSE EXP. DATE: 12/31/12

COUNTY SURVEYOR'S STATEMENT

THIS MAP HAS BEEN EXAMINED IN ACCORDANCE WITH SECTION 8766 OF THE PROFESSIONAL LAND SURVEYORS' ACT, THIS 29th DAY OF August, 2012.

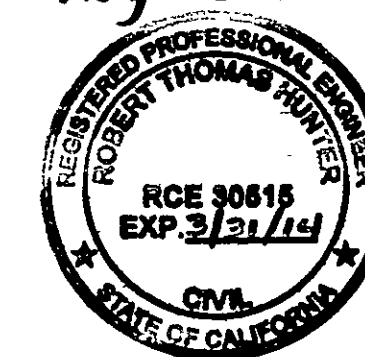

R. Tom Hunter
R. TOM HUNTER, R.C.E. 30515
PLUMAS COUNTY SURVEYOR
LICENSE EXP. DATE: 3/31/2014

COUNTY RECORDER'S STATEMENT

FILED THIS 12 DAY OF September, 2012, AT 8:34 A.M. IN BOOK 15 OF RECORDS OF SURVEY, AT PAGE 121, AT THE REQUEST OF THE COUNTY SURVEYOR.

KATHLEEN WILLIAMS
COUNTY RECORDER

FEE: NO FEEDOC. NO. 2012-0006212

BY: *Laura L. Foster*
DEPUTY

RECORD OF SURVEY

FOR
THE CITY OF PORTOLA

WITHIN A PORTION OF SECTION 1, T. 22 N., R. 13 E., M.D.M.,
IN THE CITY OF PORTOLA
PLUMAS COUNTY, CALIFORNIA

PREPARED BY:
BASTIAN ENGINEERING
213 POPLAR VALLEY ROAD
BLAIRSDEN, CALIFORNIA 96103
L.S. 7045

JANUARY 2012

SHEET 1 OF 1