

BASIS OF BEARINGS
 MEASURED BEARINGS AND DISTANCES ARE GRID BASED ON THE CALIFORNIA COORDINATE SYSTEM OF 1983 (CCS83), ZONE 1.
 @ AT THE SE CORNER OF SECTION 11 IS 0°50'54" TO GET TO TRUE NORTH ROTATE TO RIGHT 0°50'54" MULTIPLY GRID DISTANCES BY .9998356477 TO GET GROUND DISTANCES.

CONTROL WAS ESTABLISHED WITH G.P.S., TOPCON HIPER, DUAL FREQUENCY. CONTROL WAS ESTABLISHED USING THE FOLLOWING STATIONS:

"HPGN CA 02 27" (KS2012) (EPOCH DATE 2007)
 LATITUDE: 39°51'14.41797" N 1832871.45 N
 LONGITUDE: 120°41'06.41349" W 6930833.08 E

"QUINCY NCMN RM 3" (AE2770) (EPOCH 2007)
 LATITUDE: 39°58'29.74784" N 1875934.67 N
 LONGITUDE: 120°56'40.40623" W 6857465.53 E

LATITUDES AND LONGITUDES AS PUBLISHED BY NATIONAL GEODETIC SURVEYS (NGS) IN JANUARY 17, 2011

SHEET INDEX

| | |
|-----------------------------------|----------|
| SECTION 11 T23NR11E MDM..... | 1 OF 11 |
| SECTION 6 & 7 T23NR12E MDM..... | 2 OF 11 |
| SECTION 2 T22NR11E MDM..... | 3 OF 11 |
| SECTION 12 T23NR11E MDM..... | 4 OF 11 |
| SECTION 27 & 26 T23NR11E MDM..... | 5 OF 11 |
| SECTION 10 T23NR11E MDM..... | 6 OF 11 |
| CORNER NOTES S11..... | 7 OF 11 |
| CORNER NOTES S6 S7 S12 S2..... | 8 OF 11 |
| CORNER NOTES S27 S26..... | 9 OF 11 |
| CORNER NOTES S10..... | 10 OF 11 |
| BLM FIELD NOTES S27 S26..... | 11 OF 11 |

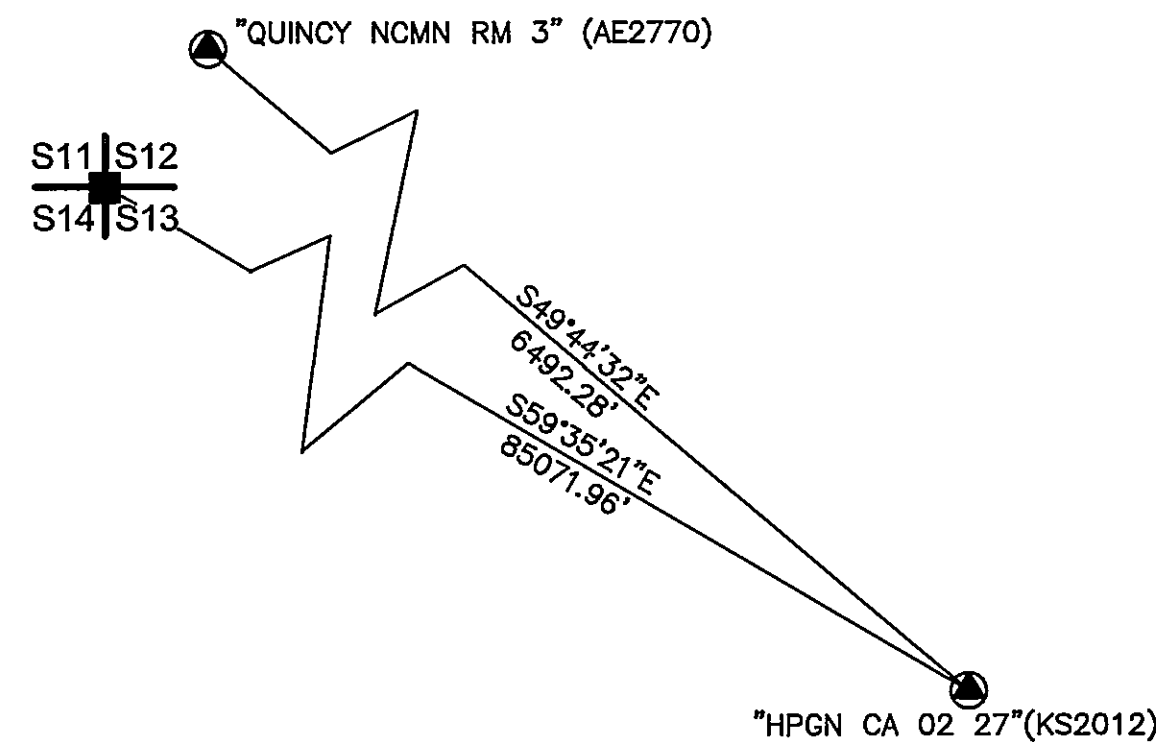

- LEGEND**
- ◆ FOUND BLM CORNER
 - ┆ CALCULATED CORNER
 - ⑩ CORNER NOTE
 - SET STANDARD U.S. FOREST SERVICE DRIVE-IN MONUMENT (BEARING TREES AS NOTED)
 - PROPERTY BOUNDARY MARKED AND POSTED
 - FD CORNER AS NOTED
- (R2) 10PM97

GENERAL NOTES

A STANDARD UNITED STATES FOREST SERVICE (USFS) DRIVE-IN MONUMENT IS A 5/8" DIAMETER ALUMINUM ROD WITH A 3-1/4" ALUMINUM CAP EDGE-MARKED WITH THE USFS LOGO.
 A STANDARD BUREAU OF LAND MANAGEMENT (BLM) MONUMENT IS A 2-1/2" DIAMETER STEEL PIPE, 28" LONG WITH A 3-1/2" BRASS CAP EDGE-MARKED WITH THE BLM LOGO.
 CORNER COORDINATES FOR S11 ARE SHOWN ON PAGE 7 OF 11.
 ALL BLM CORNERS USED ON THIS SURVEY WERE VERIFIED AND ACCEPTED BY ME, HOWEVER, THE BLM BEARING TREES WERE NOT TIED BUT WERE CHECKED IN THE FIELD.



SURVEYOR'S STATEMENT

THIS MAP CORRECTLY REPRESENTS A SURVEY MADE BY ME OR UNDER MY DIRECTION IN CONFORMANCE WITH THE REQUIREMENTS OF THE PROFESSIONAL LAND SURVEYORS' ACT AT THE REQUEST OF PLUMAS NATIONAL FOREST IN MAY 10, 2012.
 William G. Snow
 WILLIAM G. SNOW LS 5623

COUNTY SURVEYOR'S STATEMENT

THIS MAP HAS BEEN EXAMINED IN ACCORDANCE WITH SECTION 8766 OF THE PROFESSIONAL LAND SURVEYORS' THIS 18TH DAY OF MAY 2012.
 Robert Thomas Hunter
 RCE 30515
 EXP. 3-31-2014
 BY Robert Thomas Hunter
 ROBERT THOMAS HUNTER
 PLUMAS COUNTY SURVEYOR RCE 30515

RECORDER'S STATEMENT

FILED THIS 29 DAY OF May, 2012 AT 5:57 P.M. IN BOOK 15 OF RECORDS OF SURVEYS, AT PAGE 91-104 AT THE REQUEST OF THE COUNTY SURVEYOR.
 FEE: \$28.00
 KATHLEEN WILLIAMS
 COUNTY RECORDER
 DOC. No: 2012-003340 BY: Raura Foster
 DEPUTY

DGA&V LAND SURVEYOR'S

11448 SMITH RD.
 MARYSVILLE, CA. 95901
 530-671-6375

BILL SNOW 775-787-8420

RECORD OF SURVEY

SECTIONS 11,10,12,26,27 T23NR11E,MDM
 SECTIONS 6,7, T23NR12E,MDM
 SECTION 2, T22NR11E MDM
 PLUMAS COUNTY, CALIFORNIA
 FOR
 U.S.D.A. PLUMAS NATIONAL FOREST
 159 LAWRENCE ST
 QUINCY, CA. 95971

DRAWN BY: B. SNOW DATE: DECEMBER, 2011 SHEET 1 OF 11