

**Record of Survey**  
**Diamond Cadastral Survey**  
**Plumas National Forest**

**Location Map of Survey Areas and Control Stations**

SCALE: 1" = ±4000'

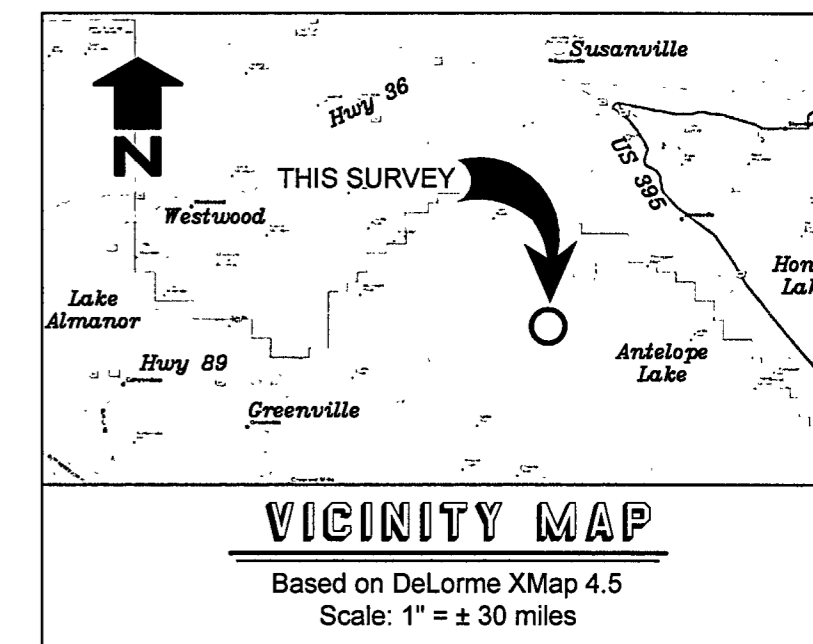

**CONTROL STATIONS**

NOT ON VICINITY MAP

**PT 1528-50**  
 Lat. 40°09'01.830"N  
 Long. 120°47'31.305"W  
 N 1940441.18 sft  
 E 6899328.83 sft  
 Set a spike, 10 ins. long, 5 ins. deep in top of 6 ins. squared vertical fence post.

**▲ PT 1528-51**  
 Lat. 40°11'55.694"N  
 Long. 120°46'51.169"W  
 N 1958075.87 sft  
 E 6902200.32 sft  
 Set a 5/8 in. diam. by 30 ins. long rebar with PNF YPC, 30 ins. in the ground.

**▲ PT 1528-52**  
 Lat. 40°14'09.878"N  
 Long. 120°41'38.794"W  
 N 1972001.61 sft  
 E 6926233.70 sft  
 Set a 5/8 in. diam. by 30 ins. long rebar with PNF YPC, 30 ins. in the ground.

**▲ PT 1528-53**  
 Lat. 40°13'53.190"N  
 Long. 120°40'54.676"W  
 N 1970364.36 sft  
 E 6929680.08 sft  
 Set a 5/8 in. diam. by 30 ins. long rebar with PNF YPC, 30 ins. in the ground.

**CORS STATIONS:**

NOT ON VICINITY MAP  
**QUIN (NAD83 (CORS96))**  
 Lat. 39°58'28.379"N  
 Long. 120°56'39.887"W  
 Ellip. Ht. 3629.7 sft

NOT ON VICINITY MAP  
**GARL (NAD83 (CORS96))**  
 Lat. 40°24'59.479"N  
 Long. 119°21'19.592"W  
 Ellip. Ht. 5383.4 sft

NOT ON VICINITY MAP  
**GABB (NAD83 (CORS96))**  
 Lat. 38°58'13.180"N  
 Long. 117°54'58.958"W  
 Ellip. Ht. 5088.6sft

**NOTES**

(See **NOTES** on Sheet 3)

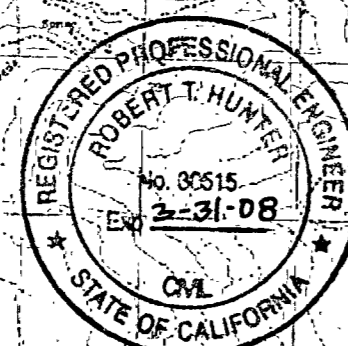
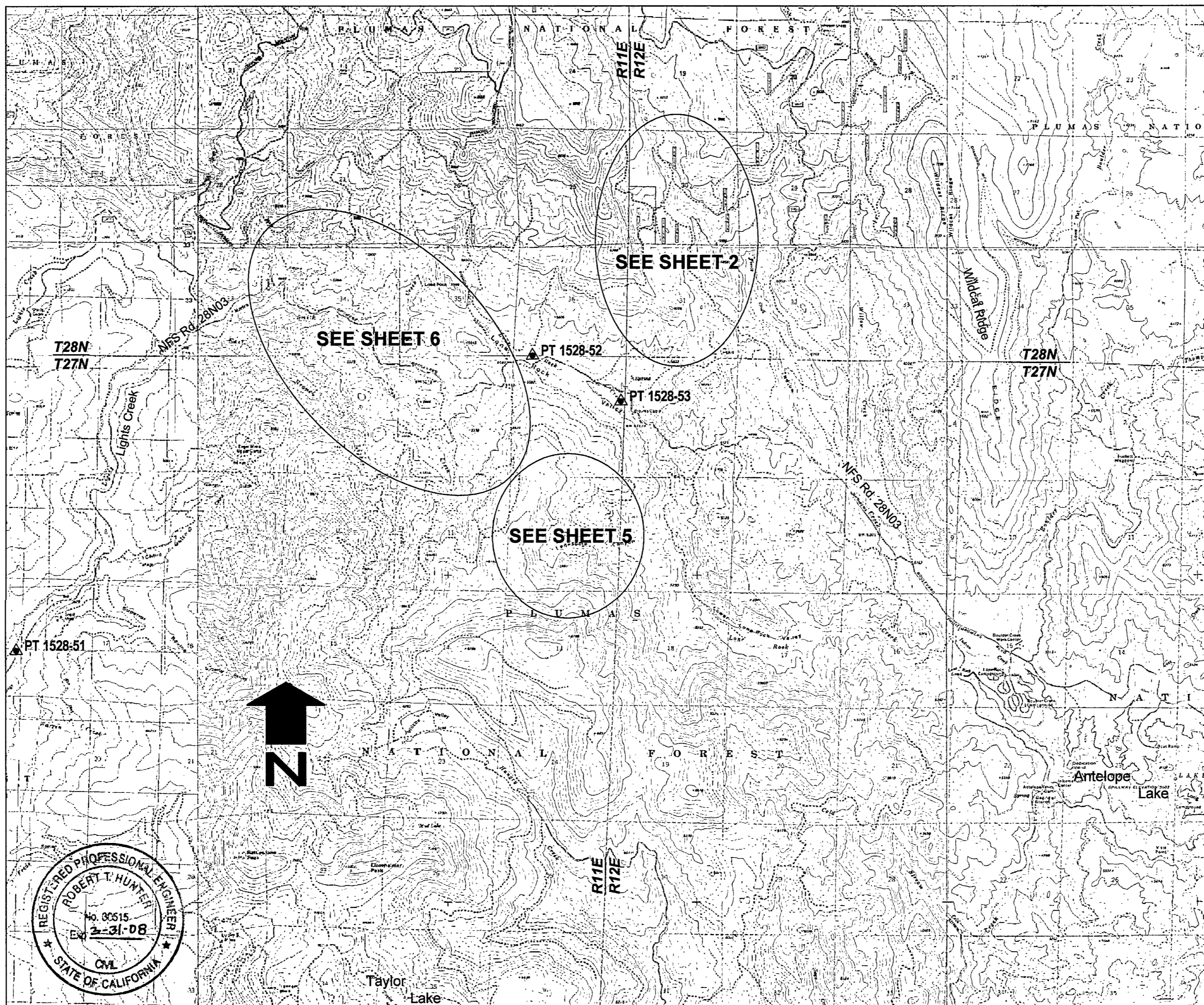

**RECORDER'S STATEMENT**

Filed this 25<sup>th</sup> day of June, 20 07, at 10:46 a. m. in book 14 of Record of Surveys at page(s) 70-79, at the request of the Plumas County Surveyor.

Fee: 24<sup>00</sup>  
 Document No.: 2007-0005140

Kathleen Williams County Clerk - Recorder  
 By: *Amanda Davis* Deputy

**COUNTY SURVEYOR'S STATEMENT**

This map has been examined in accordance with Section 8766 of the Professional Land Surveyor's Act this 21<sup>st</sup> day of June, 20 07.

*R Tom Hunter*  
 Tom Hunter RCE 30515  
 License Exp. Date: 3/31/2008



This map correctly represents a survey made by me or under my direction in conformance with the requirements of the Professional Land Surveyor's Act at the request of the U.S.D.A. Forest Service in May, 2006 to November, 2006.

*Ron C. Walter*  
 Ron C. Walter  
 L.S. 6501  
 License Exp. Date: June 30, 2007

**SURVEYOR'S STATEMENT**

**ABBREVIATIONS**

- abv. - above
- alum. - aluminum
- BLM - Bureau of Land Management
- BT - bearing tree
- BO - bearing object
- ch - chains (1 ch = 66 ft)
- cor. - corner
- CR - Corner Record
- desc. - described
- diam. - diameter
- fld. - found
- ft / sft - U.S. Survey Foot
- galv. - galvanized
- GLO - General Land Office
- gnd. - ground
- GPS - global positioning system
- lks - links (100 lks = 1 ch)
- LSM - land survey monument sign
- M - meters
- NFSL - National Forest System Lands
- NOAA - National Oceanic & Atmospheric Admin.
- PB - property boundary
- PNF - Plumas National Forest
- proj. - projecting
- RoS - Record of Survey
- sec. - section
- USDI - U.S. Dept. of the Interior
- USDA - U.S. Dept. of Agriculture
- ypc - yellow plastic cap

**NARRATIVE**

**Purpose**

The purpose of this survey is to monument and post portions of the boundary of the Plumas National Forest. This survey was performed under U.S.D.A. Forest Service Contract No. 53-9SCP-05-0167, and Task Order No. AG-9JNE-D-05-0079. John Schmidt, LS, is the Contracting Officer's Representative (COR). The Contracting Officer (CO) is Charlotte Carter.

**History**

See individual section map for specific history information.

**Procedure**

See individual section map for the procedure that was specific to each area.

This survey was performed as defined in the Department of Interior, Bureau of Land Management, Manual of Survey Instructions '73 (Manual), USFS Cadastral Survey Specifications, California Business and Professions Code, and followed the "Standards and Guidelines for Cadastral Surveys using Global Positioning System Methods, Version 1.0, March 31, 2001, as adopted by the USDA Forest Service". Lines shown as Posted were posted with six foot galvanized channel posts, with property boundary signs attached, at intervals not exceeding 250 feet.

This survey was performed by a combination of NAVSTAR GPS and conventional ground survey methods. Trimble and Ashtech dual frequency carrier-phase receivers were used to establish control and monument positioning. A Nikon Total Station (3 sec. angular, 2mm+2ppm EDM) and TDS data collector were utilized for conventional ground surveys. All monumented positions are within closed GPS networks, a conventional closed traverse, or with benefit of redundant measurements. Trimble Geomatics Office software was used for least squares adjustment, at the two sigma level, of survey data.

The geographic positions, NAD'83 (CORS'96, epoch 2002), shown hereon were derived by static GPS methods and controlled by carrier-phase observation data downloaded from the U.S. National Geodetic Survey (NGS) Continuously Operating Reference Stations (CORS); QUINCY (QUIN), GARLIC (GARL) and GABBS (GABB).

**Basis of Bearing**

The Basis of Bearing is the True Meridian and was derived from GPS observations. Local Plane Coordinates were calculated on a false meridian, and zero convergence angle, at the quarter-section corner of secs. 1 and 2, T27N, R11E, MDM, CA, and converted to ground bearing and distances with a project scale factor of 1.0002493469. Additionally, State Plane Coordinates (CCS83 Zone 1) were calculated and shown hereon for informational purposes.

**Be Advised:** This mapping, and digital copy of same, are protected by contract stipulations of product ownership and copyright laws.

<b>Diamond Cadastral Survey</b> Plumas National Forest		
LOCATED WITHIN Sec. 34, T. 28 N., R. 11 E., Secs. 30 & 31, T. 28 N., R. 12 E., Secs. 2 & 12, T. 27 N., R. 11 E., Mount Diablo Meridian, California		
<b>Wallowa Associates</b> 303 S.E. Alamo Street Enterprise, Oregon 97828 (541) 426-9049		
SCALE 1" = ±4000'	SHEET No. 1 of 9	DATE OF SURVEY Beginning: May, 2006 Ending: November, 2006
DRAWN BY RCW	CHECKED RCW	PROJECT No. WA G401-02/1528
DATE 3/07		

Certificate of Correction 2007-0007205