

13 R/S 92

SET 3 1/4" USFS ALUM. CAP ON A 5/8" ALUM. ROD. IN A MOUND OF STONE. CORNER FALLS ON A STEEP NORTHEAST SLOPE IN TIMBER.

SCRIBED AN 11" WHITE FIR, N9°W, 7.7'
"CW 1/16 S3 BT"
SCRIBED A 14" WHITE FIR, S55°W, 21.1'
"CW 1/16 S3 BT"
FD. AN OLD 1" PIPE, N86°W, 59.6'
NO RECORD

P.G.&E. W 1/16
C—C
S3
LS 4753
2006

P.G.&E.

U.S.A.

13 R/S 92

P.G.&E.

P.G.&E.

SET 3 1/4" USFS ALUM. CAP ON A 5/8" ALUM. ROD. IN A MOUND OF STONE. CORNER FALLS IN AN OPEN FLAT AT THE WEST END OF "T" OF HASKIN'S BAY.

NO TREES AVAILABLE FOR ACCESSORIES

13 R/S 92

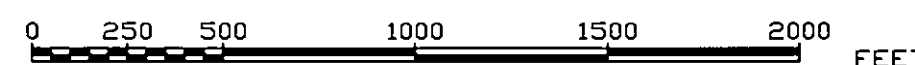

BASIS OF BEARINGS

CALIFORNIA ZONE 1, NAD 83 GRID BEARINGS
BASED ON FOUND MONUMENTS AT CORNERS 19
AND 20 PER 13 RS 92 TAKEN TO BE
NORTH 88° 19' 58" EAST.
ALL DISTANCES SHOWN AS MEASURED ARE GRID
DISTANCES. TO CONVERT TO GROUND, DIVIDE
DISTANCES SHOWN BY 0.9997725.

LEGEND

- SET MONUMENT AS DESCRIBED.
- FOUND FD A 3 1/4" USFS ALUM CAP ON A 5/8" ALUM. ROD PER ()1
- (XX) CORNER NUMBER PER ()1
- LINES MARKED AND POSTED
- ()1 RECORD PER 13 R/S 92

SURVEYOR'S STATEMENT

THIS MAP CORRECTLY REPRESENTS A SURVEY MADE BY ME OR UNDER MY DIRECTION IN CONFORMANCE WITH THE REQUIREMENTS OF THE PROFESSIONAL LAND SURVEYORS' ACT AT THE REQUEST OF PACIFIC GAS & ELECTRIC CO. ON AUGUST, 2006

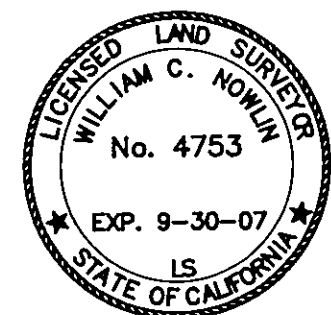

SIGNED William C Nowlin
WILLIAM C. NOWLIN L.S. 4753

COUNTY SURVEYOR'S STATEMENT

THIS MAP HAS BEEN EXAMINED IN ACCORDANCE WITH SECTION 8766 OF THE PROFESSIONAL LAND SURVEYORS' ACT THIS 18th DAY OF October, 2006.

SIGNED Tom Hunter
Tom Hunter, County Surveyor
R.C.E. 30515
License expires 3-31-2008

COUNTY RECORDER'S STATEMENT

FILED THIS 18th DAY OF October, 2006, AT 3:54 P. M., IN BOOK 14 OF RECORD OF SURVEYS AT PAGE(S) 44, AT THE REQUEST OF THE PLUMAS COUNTY SURVEYOR.

PLUMAS COUNTY RECORDER
KATHLEEN WILLIAMS

BY Kyle Hancock
DEPUTY

FEE \$800 DOC.# 2006-0009238

RECORD OF SURVEY

FOR

PACIFIC GAS & ELECTRIC
COMPANY

"BUCKS LAKE"

IN THE SOUTHWEST ONE-QUARTER OF
SECTION 3, T. 23 N., R. 7 E., MDM,
IN THE UNINCORPORATED AREA OF
PLUMAS COUNTY,
STATE OF CALIFORNIA



SCALE: 1" = 500' DATE: AUGUST, 2006
SHEET 1 OF 1