

## BASIS OF BEARINGS

The Basis of Bearings of this map is the West line of Parcel 4A & 4B shown as N 1° 02' 00" E, between found monuments of Record, in Book 4 of Parcel Maps at Page 54, Plumas County Records.

## LEGEND

- FOUND point as described
- SET 5/8" Rebar & Aluminum Cap LS 5620
- (R1) RECORD per 4 PM 54
- (R2) RECORD per Document 2005-3106
- (M) Measured Data

## SURVEYOR'S STATEMENT

This map correctly represents a survey made by me or under my direction in conformance with the requirements of the Professional Land Surveyors' Act at the request of Scott Summitt in August, 2005.

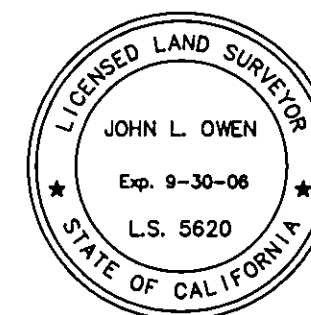

*John L. Owen*  
John L. Owen LS 5620  
License Exp. 9-30-06

## COUNTY SURVEYOR'S STATEMENT

This map has been examined in accordance with Section 8766 of the Professional Land Surveyors' Act this 18<sup>th</sup> day of May, 2006.

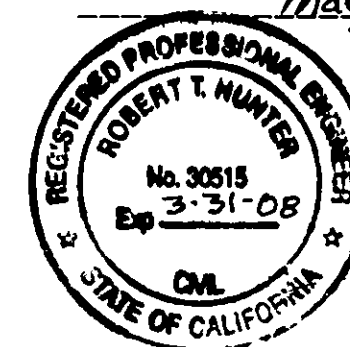

*R. Tom Hunter*  
R. Tom Hunter RCE 30515  
PLUMAS COUNTY SURVEYOR  
License Expiration Date 3/31/08

## RECORDER'S STATEMENT

Filed this 18<sup>th</sup> day of May, 2006 at 11:00 A.M. in Book 14 of Record of Surveys, at page 35, at the request of the County Surveyor.

Fee: \$ 8.00  
Document No. 2006-0004085  
Kathleen Williams  
County Recorder  
By: *Laura L. Davis*  
Deputy

# RECORD OF SURVEY for Scott Summitt

A portion of Parcel 4A, Book 4 Parcel Maps Page 54  
being a portion of the SE 1/4 of Section 3  
Township 22 North, Range 13 East, M.D.B. & M.

Plumas County ~ California  
Scale 1" = 60' January, 2006

Hamby Surveying Inc.  
P.O. Box 1209  
Portola, CA 96122  
(530) 832-5571