

GRAEAGLE LAND AND WATER CO.  
220 O.R. 370

LEGEND

- - FOUND 1/2" IRON PIPE WITH BRASS TAG  
STAMPED LS 3297, PER 4 RS 53.
- - SET 1/2" REBAR WITH ALUM. CAP  
STAMPED LS 7045.
- + - COMPUTED POINT; NOTHING FOUND OR  
SET.
- (C) - CALCULATED DATA
- (R1) - RECORD DATA PER 4 RS 53.
- (R2) - RECORD DATA PER BOOK 813 PAGE 1 OF  
PLUMAS COUNTY OFFICIAL RECORDS.
- (R3) - RECORD DATA PER DOCUMENT NO. 2001-05428.  
OF PLUMAS COUNTY RECORDS.

WATER TANK - EASEMENT 3  
DOC. NO. 2001-05428

CENTERLINE OF  
20' WIDE - EASEMENT NO. 1  
DOC. NO. 2001-05428

N89°06'39"E 50.00'  
(EAST 50.00' R3)  
(S50°48'36"E 38.71' R3)  
S49°55'15"E 38.71'

S00°53'21"E 25.00'  
(SOUTH 25.00' R3)

0.27 ACRES

N29°06'39"E 140.00'  
(N30°00'00"E 140.00' R3)

N87°48'27"E 110.03'  
(N88°41'48"E 110.03' R3)

N29°06'39"E 80.00'  
(N30°00'00"E 80.00' R3)

N87°48'27"E 154.91' (C)  
(N88°41'48"E 154.91' R2)

L1: (S01°18'12"E 10.00' R3)  
S02°11'33"E 10.00' (C)

L2: (N88°41'48"E 47.94' R3)  
N87°48'27"E 47.94' (C)

Δ=26°26'34"  
R=200.00'  
L=92.30'(C)  
(Δ=26°26'34"  
R=200.00'  
L=92.30' R2)

CENTERLINE OF WATER PIPELINE  
AND ACCESS EASEMENT;  
20' STRIP; 813 O.R. 1

NOTES:

1. THE BASIS OF BEARINGS FOR THIS MAP IS THE WEST LINE OF THE  
SOUTHWEST QUARTER OF THE NORTHEAST QUARTER OF SECTION 10,  
TOWNSHIP 22 NORTH, RANGE 12 EAST, M.D.M., SHOWN AS N00°33'58"W  
IN BOOK 4 OF RECORDS OF SURVEY AT PAGE 53, PLUMAS COUNTY RECORDS.
2. THIS MAP IS BEING FILED FOR THE PURPOSE OF MONUMENTING  
"EASEMENT 3" AS DESCRIBED IN DOCUMENT NO. 2001-05428,  
PLUMAS COUNTY RECORDS.

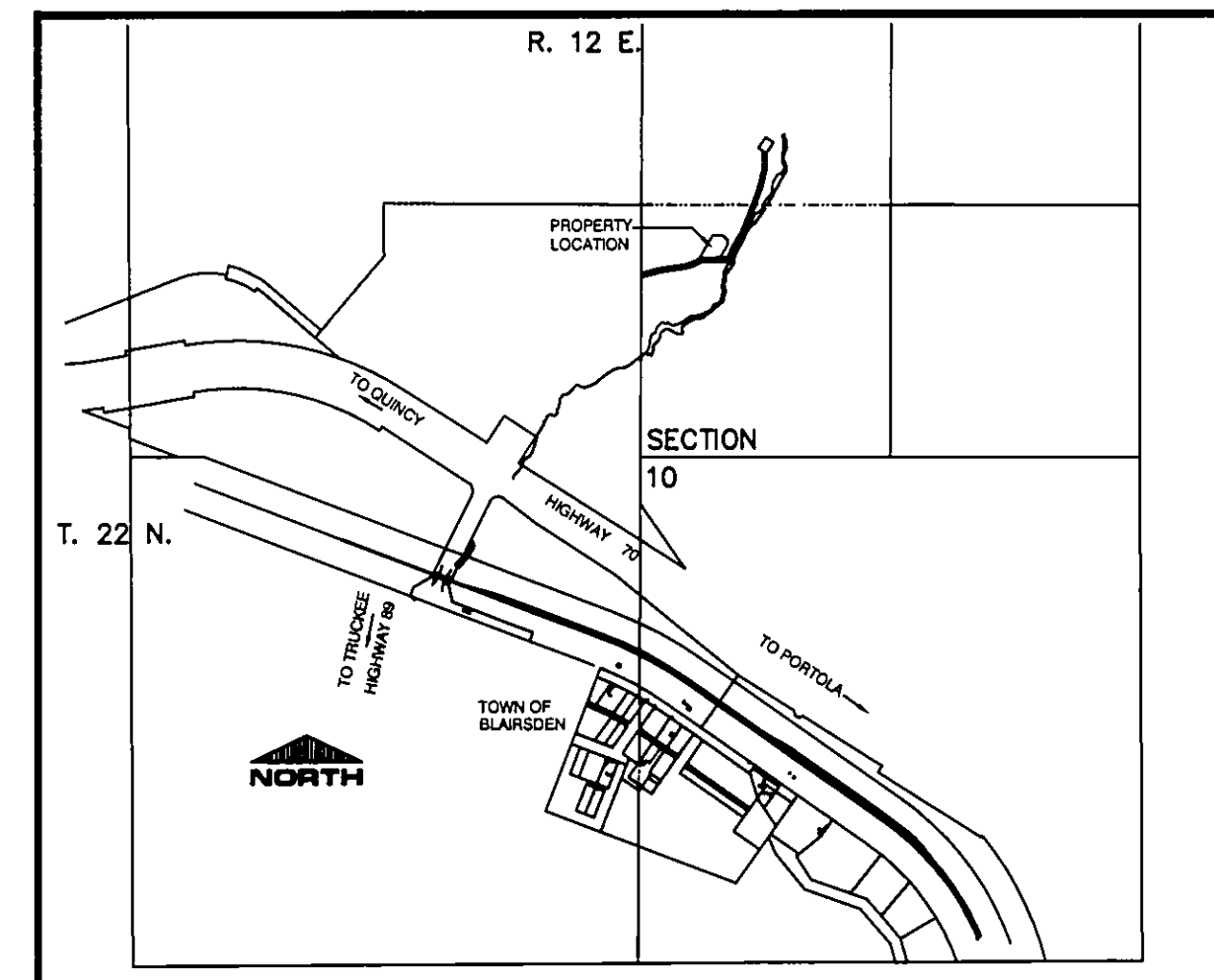

LOCATION MAP  
N.T.S.

SURVEYOR'S STATEMENT

THIS MAP CORRECTLY REPRESENTS A SURVEY MADE BY ME OR UNDER MY DIRECTION IN  
CONFORMANCE WITH THE REQUIREMENTS OF THE PROFESSIONAL LAND SURVEYORS' ACT  
AT THE REQUEST OF THE BLAIRSDEN WATER USERS ASSOCIATION IN JANUARY 2003.

DATED: 5/29/03

DANIEL B. BASTIAN  
L.S. 7045  
LICENSE EXP. DATE: 12/31/06

COUNTY SURVEYOR'S STATEMENT

THIS MAP HAS BEEN EXAMINED IN ACCORDANCE WITH SECTION 8766 OF THE PROFESSIONAL  
LAND SURVEYORS' ACT THIS 6<sup>th</sup> DAY OF June, 2003.

DATED: 6/6/03

R. Tom Hunter  
R. TOM HUNTER, R.C.E. 30515  
PLUMAS COUNTY SURVEYOR  
LICENSE EXP. DATE: 3/31/04

COUNTY RECORDER'S STATEMENT

FILED THIS 6<sup>th</sup> DAY OF June, 2003, AT 3:10 P.M. IN  
BOOK 12 OF RECORDS OF SURVEYS, AT PAGE 133, AT THE REQUEST  
OF THE COUNTY SURVEYOR.

FEE: \$ 8.00

DOC. NO. 2003-6163

KATHLEEN WILLIAMS  
COUNTY RECORDER  
BY: Kathy Small  
DEPUTY

RECORD OF SURVEY

FOR  
BLAIRSDEN WATER USERS ASSOCIATION  
WITHIN A PORTION OF SECTION 10, T. 22 N., R. 12 E., M.D.M.  
PLUMAS COUNTY, CALIFORNIA

PREPARED BY:  
BASTIAN ENGINEERING  
P.O. BOX 280  
GRAEAGLE, CALIFORNIA 96103  
L.S. 7045

JANUARY 2003

SHEET 1 OF 1