

PROJECT LOCATION & CONTROL SCHEME

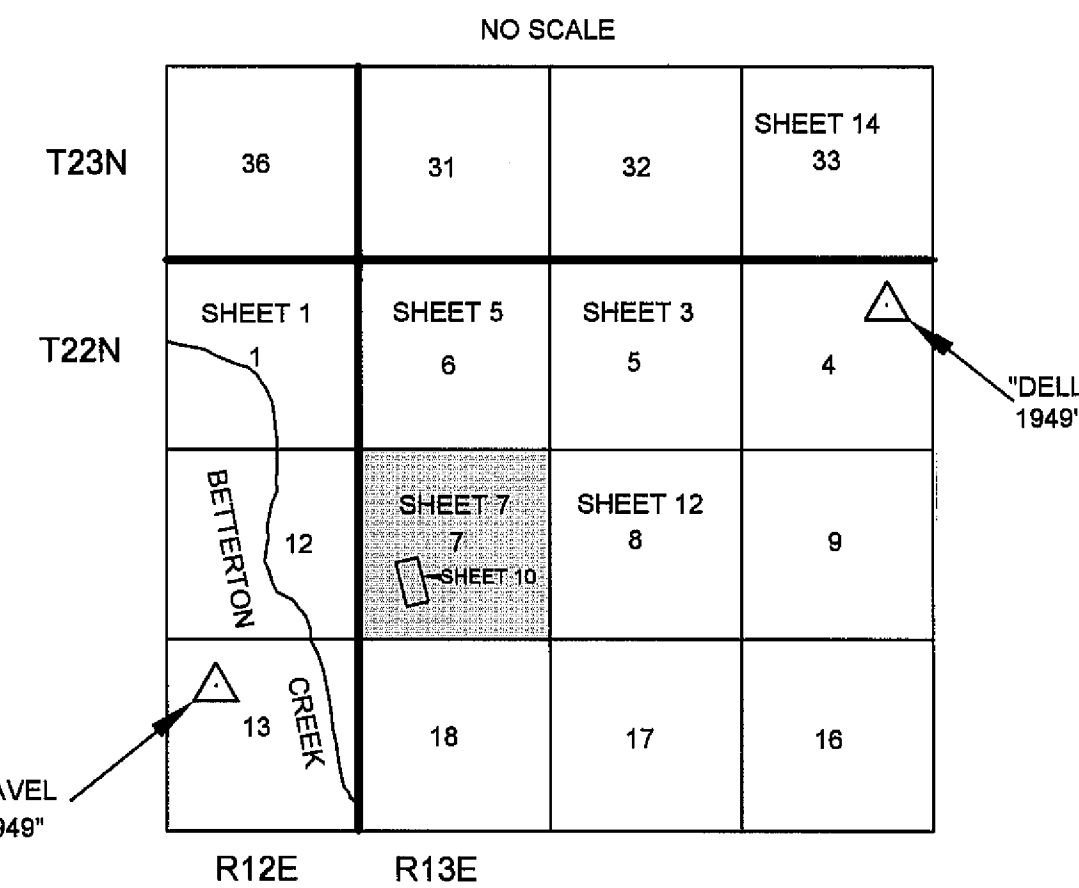

GENERAL NOTES

A STANDARD UNITED STATES FOREST SERVICE (USFS) DRIVE-IN MONUMENT IS A 5/8" DIAMETER ALUMINUM ROD WITH A 3-1/4" ALUMINUM CAP EDGE-MARKED WITH THE USFS LOGO.

A STANDARD BUREAU OF LAND MANAGEMENT (BLM) MONUMENT IS A 2-1/2" DIAMETER STEEL PIPE, 28" LONG WITH A 3-1/2" BRASS CAP EDGE-MARKED WITH THE BLM LOGO.

SURVEY HISTORY OF LAURA QUARTZ MINE

R11	A. KEDDIE	1877	GLO

CALIFORNIA COORDINATE SYSTEM OF 1983 (CCS83), ZONE 1

CORNER	NORTHING	EASTING
49	1805453.922	6963646.5710

N

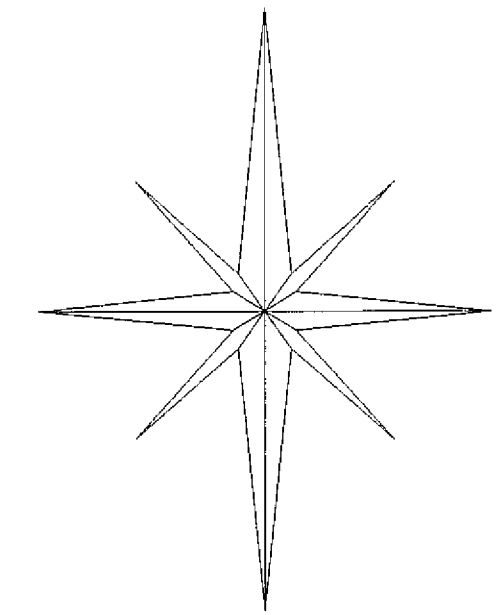

SCALE

1 INCH = 200 FEET



BASIS OF BEARING

MEASURED BEARINGS AND DISTANCES ARE GRID. THEY ARE BASED ON THE CALIFORNIA COORDINATE SYSTEM OF 1983 (CCS83), ZONE 1.

Θ AT THE SW CORNER SECTION 7 IS 00°58'07". MULTIPLY GRID DISTANCES BY 1.000174 TO GET GROUND DISTANCES.

CONTROL WAS DONE WITH GPS, TRIMBLE NAVIGATION, 4000 ST, SINGLE FREQUENCY RECEIVERS. CONTROL WAS BROUGHT IN USING THE FOLLOWING STATIONS:

"GRAVEL 1949"
LATITUDE: 39°46'22.92395" N 1803819.4802 N
LONGITUDE: 120°35'03.32548" W 6959824.0422 E

"DELL 1949"
LATITUDE: 39°48'03.87786" N 1814345.3519 N
LONGITUDE: 120°31'02.11293" W 6978283.7269 E

LATITUDES AND LONGITUDES AS PUBLISHED BY NATIONAL GEODETIC SURVEYS (NGS) IN FEBRUARY 1987.

LEGEND

- FOUND CORNER
- SET CORNER
- PROPERTY BOUNDARY MARKED AND POSTED

RECORD OF SURVEY

SECTION 1 T22N R12E, SECTIONS 5,6,7&8 T22N R13E, SECTION 33 T23N R13E MDM

M.S. 663 LAURA QUARTZ CLAIM
PLUMAS COUNTY, CALIFORNIA

FOR
PLUMAS NATIONAL FOREST
PO BOX 11500 QUINCY, CALIFORNIA 95971

CREW:

B.SNOW J.SCHMIDT
D.GREENWELL R.KNOETTGEN

DRAWN BY:

R.KNOETTGEN & B.SNOW

SHEET 10 OF 15