

Corner Notes

Monuments set by this survey were provided by the US Forest Service. They consist of a 5/8" aluminum rod with a 3 1/4" aluminum cap stamped as shown below.

Bearing trees and bearing objects were marked in accordance with USFS and BLM specification. Bearings and distances were measured to the apparent center of the trees, or to the X on the objects.

Where noted, non-Forest Service corners were monumented with a 5/8" rebar with 2" aluminum cap stamped BURGESS LAND SURVEYS LS 4790 and the corner information as shown below.

- 1 T23N R10E
1 S30
4 S31
LS4790
1992
Found original 15"x11"x4" marked stone in small mound of stone and remains of original BTs:
red fir stump bears N32°W 17.0' w/axe face, no marks
red fir dead and rotted bears S56°W 40±, no marks
Set USFS drive monument, rebuilt mound of stone and marked new BTs:
14" white fir bears S74°W 8.9' marked 1/4S31 BT
13" white fir bears N32°W 12.3' marked 1/4S30 BT
- 2 T23N R10E
S30|S29
S31|S32
LS4790
1992
Found mound of stone and original BT:
21" red fir bears N62°30'E 43.6', w/ scribing visible
Set USFS drive monument, rebuilt mound of stone and marked new BTs:
8" red fir bears S3°E 32.8' marked T23NR10ES32 BT
24" red fir bears S69°W 22.5' marked T23NR10ES31 BT
22" red fir bears N50°W 20.6' marked T23NR10ES30 BT
16" red fir bears N74°E 26.4' marked T23NR10ES29 BT
- 3 T23N R10E
1 S29
4 S32
LS4790
1992
Found original 11"x8"x6" marked stone and original BTs:
52" ponderosa pine bears N27°E 38.3', w/ scribing visible
34" ponderosa pine snag bears S35°30'E 35.6', no marks
Set USFS drive monument, rebuilt mound of stone and marked new BT:
9" red fir bears S35°E 12.7' marked 1/4S32 BT
- 4 N1/16
S31|S32
LS4790
1992
Set USFS drive monument, in a mound of stone and marked new BTs:
12" white fir bears N33°E 89.9' marked N1/16S32 BT
9" white fir bears N20°W 48.7' marked N1/16S31 BT
- 5 NW1/16 S32
LS4790
1992
Set USFS drive monument, in a mound of stone and marked new BTs:
11" white fir bears N44°45'W, 41.1' marked NW1/16S32 BT
20" red fir bears N2°30'E 14.8' marked NW1/16S32 BT
- 6 T23N
R9E|R10E
S36|S31
LS5623
1992
Found a std. USFS drive monument in a mound of stone and BTs per 9 RS 110-111
- 7 E1/16
C-C
S31
LS4790
1992
Set rebar with aluminum cap in a mound of stone

- 8 T23N R10E
1/4
S31|S32
LS4790
1992
Found original 14"x8"x5" marked stone in mound of stone
Set USFS drive monument, rebuilt mound of stone and marked new BTs:
9" white fir bears S31°E 30.4' marked 1/4S32 BT
15" white fir bears S39°30'W 44.7' marked 1/4S31 BT
- 9 W1/16
C-C
S32
LS4790
1992
Set USFS drive monument, in a mound of stone and marked new accessories:
18" white fir bears N57°45'E 13.8' marked CW1/16S32 BT
5'x4'x3' granite boulder bears S64°30'E 21.6' marked BXO
- 10 C-S-SE
1/64
S31
LS4790
1992
Set USFS drive monument, in a mound of stone and marked new BTs:
19" white fir bears S85°E 298.1' marked CSSE1/64S31 BT
29" red fir bears S39°45'E 179.1' marked CSSE1/64S31 BT
- 11 S-S 1/64
S31|S32
LS4790
1992
Set USFS drive monument, in a mound of stone and marked new BTs:
10" white fir bears S7°E 11.7' marked SS1/64S32 BT
31" red fir bears S84°W 12.8' marked SS1/64S31 BT
- 12 C-S-SW
1/64
S32
LS4790
1992
Set USFS drive monument, in a mound of stone and marked new BTs:
10" red fir bears S88°W 40.6' marked CSSW1/64S32 BT
8" white fir bears S40°30'W 57.0' marked CSSW1/64S32 BT
- 13 T23N
R9E R10E
S36|S31
S1|S6
T22N
LS4790
1992
Found mound of stone and original BTs:
25" ponderosa pine bears N73°E 18.6', no marks
49" Douglas fir bears S35°W 39.6', w/ healed blaze
22" incense cedar bears N19°W 5.3', w/ healed blaze
Set USFS drive monument, rebuilt mound of stone and marked new BT:
14" pondrosa pine bears S28°E 28.0' marked T22NR10ES6 BT
- 14 T23N R10E
1 S31
4 S6
T22N
LS4790
1992
No original evidence found. At single proportion position set USFS drive monument, rebuilt mound of stone and marked new BT:
64" incense cedar bears S34°W 22.2', marked 1/4S6 BT
11" white fir bears S61°E 34.9', marked 1/4S6 BT

- 15 T23N R10E
S31|S32
S6|S5
LS4790
1992
Found mound of stone and original BTs:
44" red fir bears S69°W 44.8', w/ scribing found
stumphole bears N22°W 55±, no marks
Set USFS drive monument, rebuilt mound of stone and marked new BTs:
20" red fir bears S35°W 43.9' marked T22NR10ES6 BT
27" red fir bears N14°W 6.3' marked T23NR10ES31 BT
17" white fir bears S38°E 43.9' marked T22NR10ES5 BT
8" white fir bears N38°E 42.8' marked X BT
- 16 T23N R10E
1 S32
4 S5
T22N
LS4790
1992
Found mound of stone and original BT:
26" red fir bears S47°E 25.1', verified by Joe Edgerton of the USFS in 1976
Set USFS drive monument, rebuilt mound of stone and marked new BTs:
16" red fir bears N60°E 13.1' marked 1/4S32 BT
- 17 T23N R10E
S20|S21
S28|S28
LS4790
1998
Found original 14"x7"x6" marked stone and original BTs:
16" red fir bears S79°30'W 9.2', w/ scribing visible
Set Aluminum Capped Aluminum pipe. rebuilt stone mound and marked BTs:
15" white fir, N88°E, 80.6' mkd T23NR10E S21 BT
16" white fir, S44°30'E, 3.2 mkd T23NR10E S28 BT
17" red fir, N28°W, 42.2 mkd T23NR10E S20 BT
- 18 T23N R10E
S35|S36
S21|S1
LS5326
1994
Found USFS drive monument in a mound of stone and original BTs:
34" jeffrey pine snag bears S42°E 37.6' w/ open blaze
40" incense cedar bears S59°30'W 36.0' w/ healed blaze
40" Douglas fir bears N7°30'W 87.1' w/ healed blaze

Record of Survey
for
Shaffer-Ulch and USDA-Plumas National Forest
Sections 31 and 32 T23N R10E MDM
in the unincorporated territory of Plumas County California

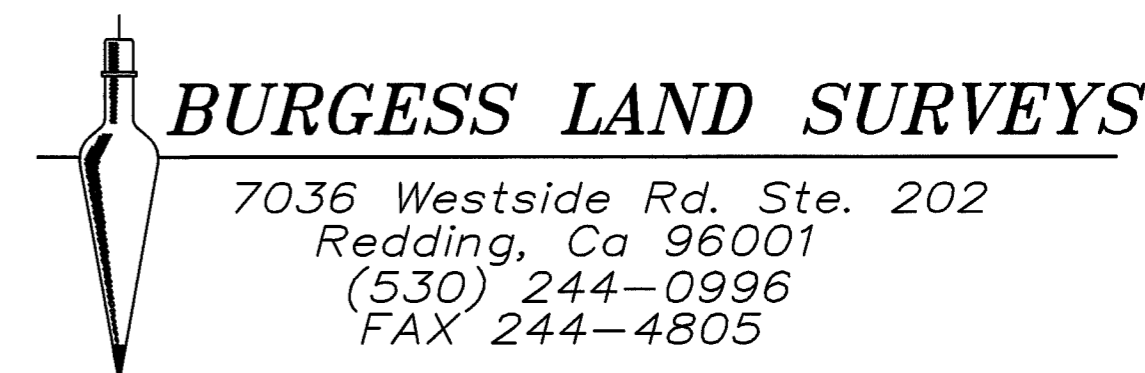
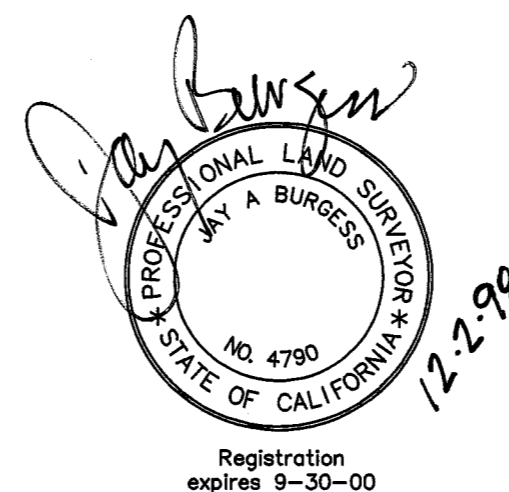

7036 Westside Rd. Ste. 202
Redding, Ca 96001
(530) 244-0996
FAX 244-4805