

IN THE STATE OF CALIFORNIA RECORD OF SURVEY

STATE OF ARIZONA

IN THE COUNTIES OF ALAMEDA, CONTRA COSTA, LOS ANGELES, MARIN, MONTEREY,
ORANGE, PLUMAS, RIVERSIDE, SAN BERNARDINO, SAN DIEGO, SANTA BARBARA, TUOLUMNE
AND VENTURA, ALL WITHIN THE STATE OF CALIFORNIA.
RIVERSIDE COUNTY FLOOD CONTROL AND WATER CONSERVATION DISTRICT
JULY 1996

SURVEYORS NOTES:

1. THE PURPOSE OF THIS MAP IS TO SHOW THE RELATIVE LOCATIONS OF THE CONTINUOUSLY OPERATING REFERENCE STATIONS (C.O.R.S.) IN CALIFORNIA AS OF THE DATE OF THIS SURVEY, ON BEHALF OF THE CALIFORNIA C.O.R.S. COMMITTEE.
2. THE DATA SHOWN FOR EACH SITE WERE TAKEN FROM THE NATIONAL GEODETIC SURVEY VALUES FOR NAD 83, EPOCH 1995.5.
3. DUE TO SECURITY CONCERNS, THE EXACT LOCATIONS OF THESE C.O.R.S. SITES HAVE BEEN OMITTED. FOR FURTHER INFORMATION, CONTACT THE SITE ADMINISTRATOR.

NATIONAL GEODETIC SURVEY

ON BEHALF OF THE NATIONAL GEODETIC SURVEY, I HEREBY AUTHORIZE THE MAKING OF AND CONSENT TO THE FILING OF THIS MAP.

DONALD D'ONOFRIO
N.G.S. ADVISOR TO CALIFORNIA

Donald D'Onofrio

CALIFORNIA C.O.R.S. COMMITTEE

ON BEHALF OF THE CALIFORNIA CONTINUOUSLY OPERATING REFERENCE STATIONS (C.O.R.S.) COMMITTEE, I HEREBY AUTHORIZE THE MAKING OF AND CONSENT TO THE FILING OF THIS MAP.

WILLIAM H. YOUNG
CHAIRMAN, CALIFORNIA C.O.R.S. COMMITTEE

W. H. Young
P.L.S. 3364 EXP. DATE JUNE 30, 2000

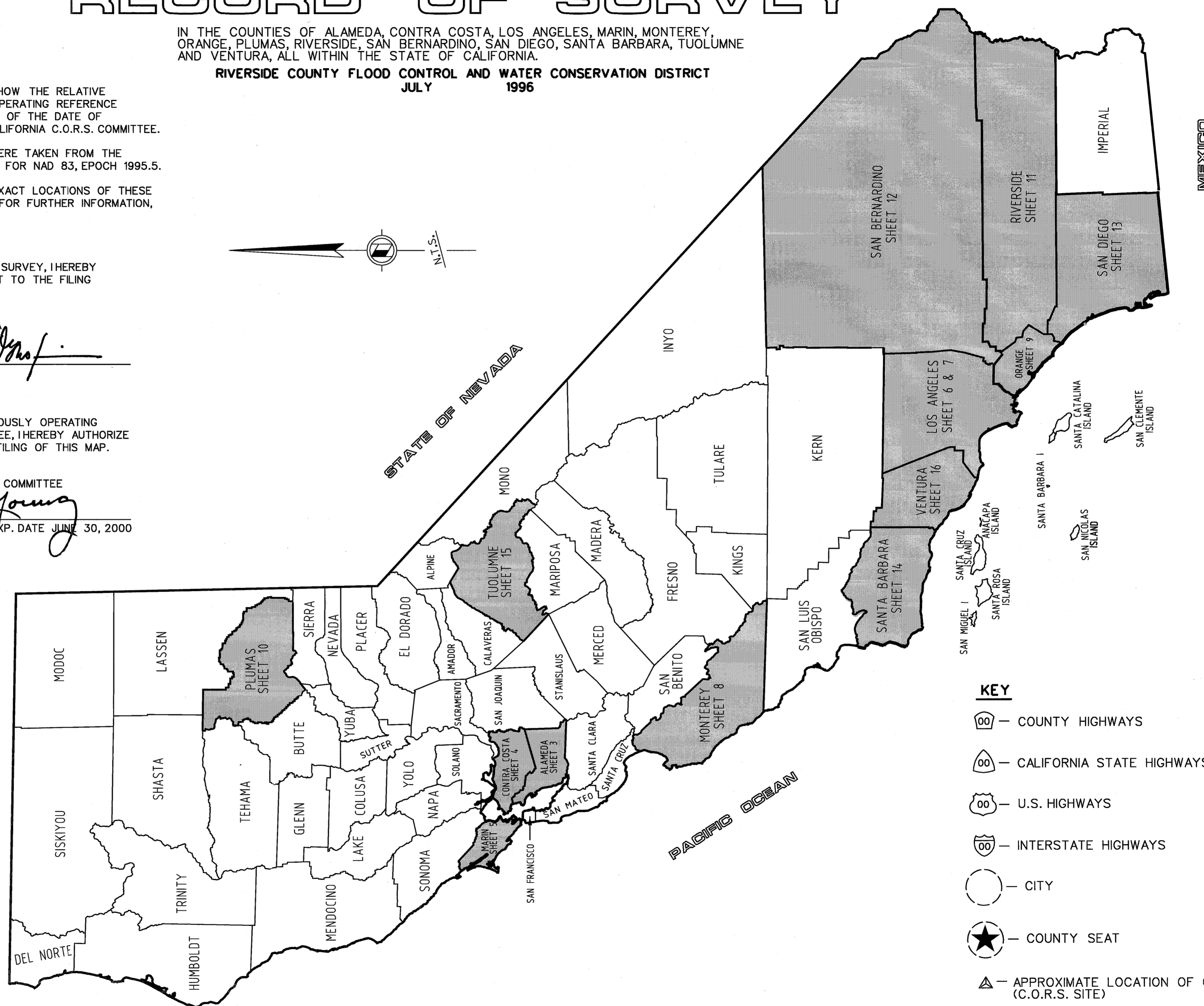
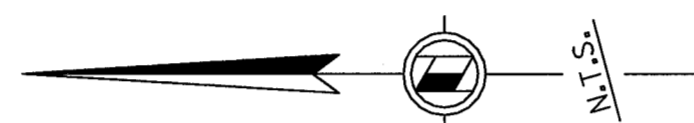
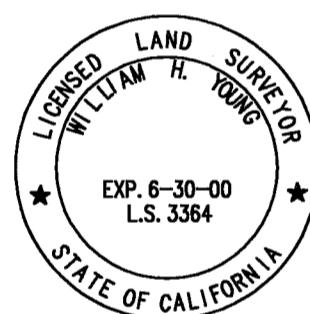

KEY

- COUNTY HIGHWAYS
- CALIFORNIA STATE HIGHWAYS
- U.S. HIGHWAYS
- INTERSTATE HIGHWAYS
- CITY
- COUNTY SEAT
- APPROXIMATE LOCATION OF G.P.S. SITE (C.O.R.S. SITE)