

SURVEYOR'S STATEMENT

This map correctly represents a survey made by me or under my direction in conformance with the requirements of the Land Surveyors' Act at the request of J. R. Mastelotto in November, 1996.

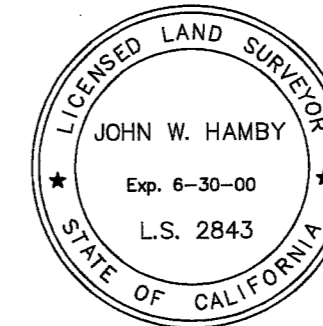

John W. Hamby
John W. Hamby LS 2843

COUNTY SURVEYOR'S STATEMENT

This map has been examined in accordance with Section 8766 of the Land Surveyors' Act on the 23rd day of JANUARY, 1997.

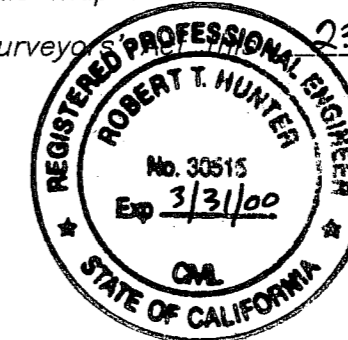

R. Tom Hunter
R. Tom Hunter RCE 30515
PLUMAS COUNTY SURVEYOR
License Expiration Date 3/31/00

RECORDER'S STATEMENT

Filed this 23rd day of JANUARY, 1997 at 3:40 p.m. in Book 10 of Record of Surveys, at page 144, at the request of the County Surveyor.

Fee \$8.00
File No. 380

Judith Wells
County Recorder
by *Judith Wells*
Deputy

Basis of Bearings

The Basis of Bearings of this map is the calculated Bearing between the found monuments shown as N73°00'58"E which was rotated 00°44'48" from 9 PM 13 and 9 PM 115 to show Highway 70 as record N73°01'00"E to match records used.

RECORD OF SURVEY
for
J. R. Mastelotto

A portion of the NW 1/4 of Section 3
T. 22 N., R. 13 E., M.D.M.

Plumas County ~ California
Scale 1" = 50' December, 1996

Hamby Surveying Inc.
P.O. Box 1209
Portola, CA 96122
(916) 832-5571

LEGEND

- RECORD 1/4 corner per 9 PM 115, 2" IP LS 2843
- FOUND point as shown
- FOUND 1/2" rebar with Aluminum Cap LS 2843 per 9 PM 115
- SET 5/8" rebar with Aluminum Cap LS 2843
- Computed point
- (R1) RECORD per 9 PM 115
- (R2) RECORD per 76 DEEDS 341
- (R3) RECORD per 255 O.R. 630
- (R4) RECORD per 142 O.R. 186