

SURVEYOR'S STATEMENT

This map correctly represents a survey made by me or under my direction in conformance with the requirements of the Land Surveyors' Act at the request of Jim & Juila Holcomb in June, 1993.

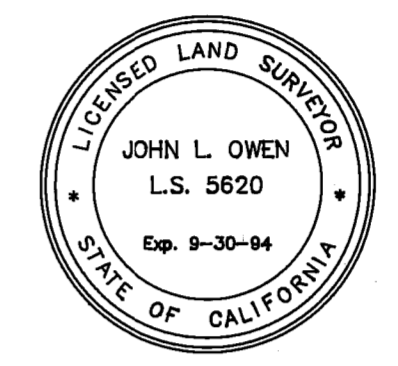

John L. Owen
John L. Owen LS 5620

COUNTY SURVEYOR'S STATEMENT

This map has been examined in accordance with Section 8766 of the Land Surveyors' Act on this 17th day of September, 1993

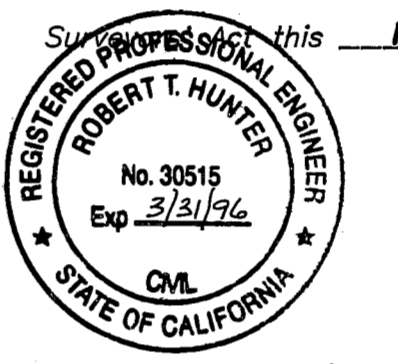

R. Tom Hunter
R. Tom Hunter RCE 30515
PLUMAS COUNTY SURVEYOR
License Expiration Date 3/31/96

RECORDER'S STATEMENT

Filed this 20th day of September, 1993 at 2:15 P.m. in Book 9 of Record of Surveys, at page 125, at the request of the County Engineer.

Fee \$500
File No. 7305
Judith Wells
County Recorder
by *Judith Wells*
Deputy

RECORD OF SURVEY
for
Jim & Juila Holcomb

Lots 1 & 9, 7 M 70, Lakeview Subdivision
Located in Section 11, T. 23 N., R. 13 E., M.D.M.
PLUMAS COUNTY - CALIFORNIA
SCALE 1" = 100' JUNE, 1993

HAMBY SURVEYING INC.
P.O. Box 1209
PORTOLA, CA. 96122
Phone 916-832-5571

Basis of Bearings
The Basis of Bearing of this map is the Easterly line of Lot 1 of Lakeview Subdivision shown as N 00°28'43" E in Book 7 of Maps at page 69, Plumas County Records.

- NOTES:**
- This Map reflects a Lot Line adjustment of Lots 9 & 1 as shown on 7 M 69 Plumas County, California. Said Lot Line adjustment was Recorded in the office of the Recorder of Plumas County in Book OR at page
 - All bearings and distances shown are record per 7 M 69 unless shown otherwise.

LEGEND

- FOUND 1/2" Rebar with Plastic Cap RCE 22836
- ⊗ FOUND 5/8" Rebar & Aluminum Cap LS 2843
- FOUND 5/8" Rebar & Plastic Cap LS 2843
- SET 5/8" Rebar & Aluminum Cap LS 2843
- (R1) RECORD per 193 OR 534
- (R2) RECORD per 3 RS 108
- (R3) RECORD per 5 M 73

