

LOCATION MAP

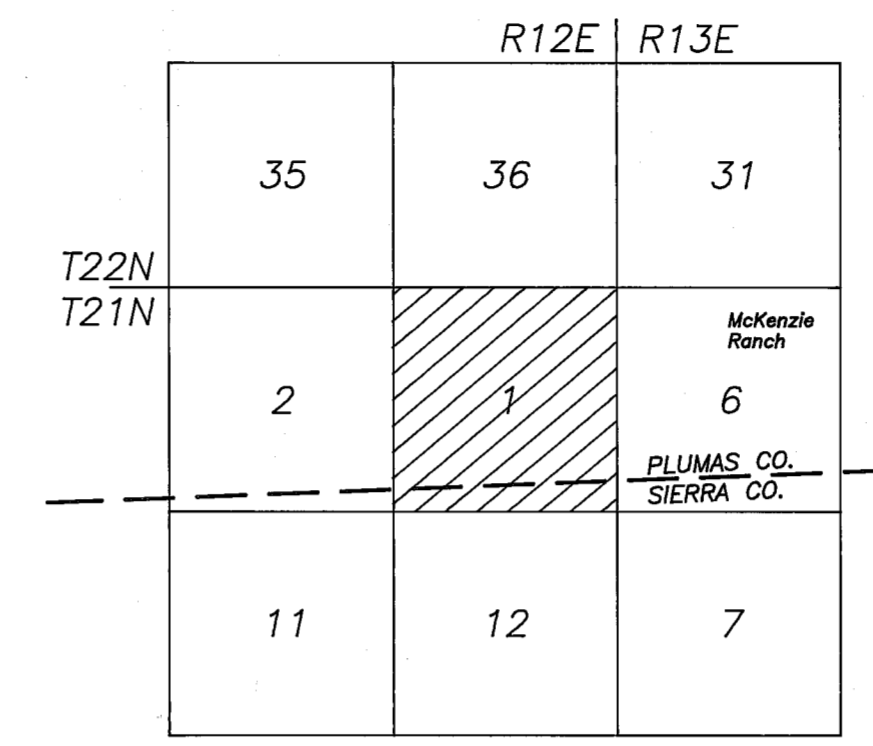

SCALE: 1" = 600'

NOTES

A STANDARD USFS DRIVE-IN MONUMENT IS A 5/8" DIAMETER ALUMINUM ROD WITH A 3 1/4" DIAMETER ALUMINUM CAP EMBOSSED WITH THE USFS LOGO.
 A STANDARD USFS MONUMENT IS A 2 1/2" O.D. ALUMINUM PIPE 26" LONG, WITH A 3 1/4" O.D. ALUMINUM CAP STAMPED WITH USFS LOGO.

SURVEY HISTORY

DATE	NAME	REG. NO.	AGENCY
R1 1870	A. KEDDIE	N/A	GLO
R2 1878	L. BOND	N/A	GLO
R3 1972	J. SIMPSON	R.C.E. 11173	PRIVATE
WEST BOUNDARY: 4RS9			

BASIS OF BEARING

THE BASIS OF BEARING IS THAT BEARING FROM THE WEST 1/4 OF SEC 6 T21N R13E TO THE NW COR OF SAME SECTION BEING N00°03'14"E AS SHOWN ON 9RS54 WHICH WAS BASED ON A SOLAR OBSERVATION.

LEGEND

- FOUND CORNER
- SET CORNER
- PROPERTY BOUNDARY MARKED AND POSTED



SURVEYOR'S STATEMENT

This map correctly represents a survey made by me or under my direction in conformance with the requirements of the Land Surveyors' Act at the request of Plumas National Forest in MARCH, 7, 1993.
 William Glenn Snow
 William Glenn Snow L.S. 5623
 License Exp. Date 12/31/94

COUNTY SURVEYOR'S STATEMENT

This map has been examined in accordance with Section 8766 of the Land Surveyors' Act this 4th day of March, 1993.
 R. Tom Hunter
 R. Tom Hunter R.C.E. 30515
 Plumas County Surveyor
 License Exp. Date 03/31/96

RECORDER'S STATEMENT

Filed this 5th day of MARCH, 1993 at 10:20 A.M. in Book 9 of Records of Surveys, at page 107, at the request of the County Surveyor.
 Fee: \$ 9.00
 File No: 1435
 Judith Wells
 County Recorder
 By: William L. Payne
 Deputy

RECORD OF SURVEY

LOCATED IN SECTION 1 T21N R12E MDM, COUNTY OF PLUMAS, STATE OF CALIFORNIA, FOR THE PLUMAS NATIONAL FOREST P.O. BOX 11500 QUINCY, CA. 95971.
 SURVEY CREW: R. Knoettgen, D. Hobbs, L. Gross, J. Schmidt
 DRAWN BY: S. Sasser
 SHEET: 1 OF 3