

16

LANDS OF PRICE
634.70 AC.

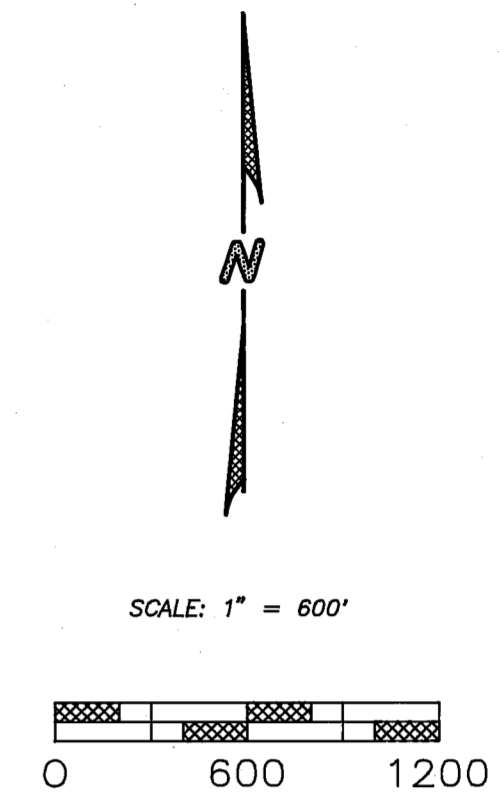
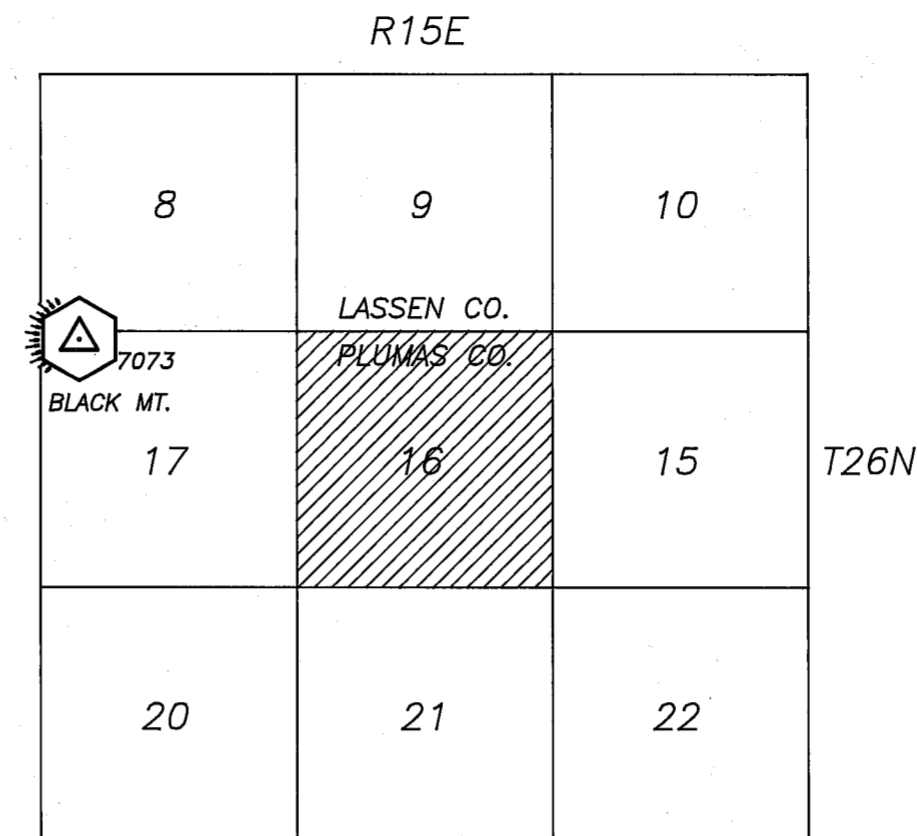

NONSTANDARD ABBREVIATIONS

FWB	FROM WHICH BEARS
BT	BEARING TREE
MOS	MOUND OF STONE
DWR	DEPARTMENT OF WATER RESOURCES
JUN	JUNIPER
DF	DOUGLAS FIR
WF	WHITE FIR
RF	RED FIR
PP	PONDEROSA PINE
SP	SUGAR PINE
JP	JEFFREY PINE
IC	INCENSE CEDAR
MON	MONUMENT
RP	REFERENCE POINT

NOTES

A STANDARD USFS MONUMENT IS A 2-1/2" O.D. ALUMINUM PIPE 26" LONG, W/ 3-1/4" O.D. ALUMINUM CAP STAMPED W/ USFS LOGO WITH A MAGNET UNDER CAP AND A 3-1/4" LONG BY 5" PLASTIC BASE WITH A MAGNET.

A STANDARD USFS DRIVE-IN MONUMENT IS A 5/8" DIAMETER ALUMINUM ROD WITH A 3 1/4" DIAMETER ALUMINUM CAP MARKED WITH THE USFS LOGO.

A STANDARD DWR MONUMENT IS A 2" O.D. GALVANIZED STEEL PIPE WITH A 2-1/2" BRASS CAP STAMPED WITH THE DEPARTMENT OF WATER RESOURCES LOGO.

SURVEY HISTORY			
DATE	NAME	REG. NO.	AGENCY
R1 1879	MILTON SANTEE		GLO
R2 1925	F. W. CHAPIN		GLO

BASIS OF BEARING

THE BASIS OF BEARING IS A SOLAR OBSERVATION FROM THE SOUTH WEST SECTION CORNER OF SECTION 16, T26N R15E MDM.

LEGEND

- FOUND CORNER
- SET CORNER
- PROPERTY BOUNDARY MARKED AND POSTED

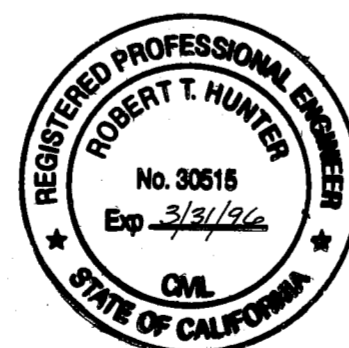

SURVEYOR'S STATEMENT

This map correctly represents a survey made by me or under my direction in conformance with the requirements of the Land Surveyors' Act at the request of Plumas National Forest in FEB 7, 1993.

William Glenn Snow
William Glenn Snow L.S. 5623
License Exp. Date 12/31/94

COUNTY SURVEYOR'S STATEMENT

This map has been examined in accordance with Section 8766 of the Land Surveyors' Act this 4th day of February, 1993.

R Tom Hunter
R. Tom Hunter R.C.E. 30515
Plumas County Surveyor
License Exp. Date 03/31/96

RECORDER'S STATEMENT

Filed this 18th day of February, 1993 at 11:10 A.m. in Book 9 of Records of Surveys, at page 103, at the request of the County Surveyor.

Fee: \$ 700
File No: 1076
Judith Wells
County Recorder
By *Judith Wells*
Deputy

RECORD OF SURVEY

LOCATED IN SECTION 16 T26N R15E MDM, COUNTY OF PLUMAS, STATE OF CALIFORNIA, FOR THE PLUMAS NATIONAL FOREST. P.O. BOX 11500 QUINCY, CA. 95971.

SURVEY CREW
B. Snow
T. Wadnizak
J. Schmidt

DRAWN BY S. Sasser

SHEET: 1 OF 2