

RECORD: SET A POST 5 FEET LONG AND 4 INCHES DIAMETER, 2 FEET DEEP IN A MOUND 4 1/2 FEET IN DIAMETER AT BASE AND 2 FEET HIGH WITH PITS 24X18X12 FOR CORNER TO SECTIONS 8,9,16,17.
 FOUND: STD DWR MON 12" ABOVE GROUND, (NO OFFICIAL RECORD) ACCEPTED POSITION AS BEST AVAILABLE EVIDENCE OF ORIGINAL SECTION CORNER LOCATION.
 SET: NOTHING

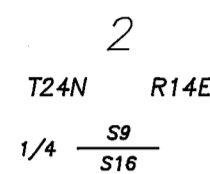

RECORD: SET A POST 4 FEET LONG AND 4 INCHES DIAMETER, 2 FEET DEEP IN A MOUND 4 1/2 FEET IN DIAMETER AT BASE AND 2 FEET HIGH WITH PITS 24X18X12 FOR QUARTER SECTION CORNER.
 FOUND: NOTHING
 SET: NOTHING, CALCULATED POSITION ONLY

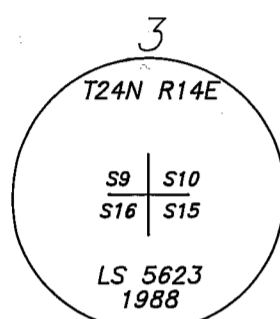

RECORD: SET A POST 5 FEET LONG AND 5 INCHES DIAMETER, 2 FEET DEEP IN A MOUND 4 1/2 FEET IN DIAMETER AT BASE AND 2 FEET HIGH WITH PITS 24X18X12 FOR CORNER TO SECTIONS 9,10,15,16.
 FOUND: 1" OD STEEL PIPE (NO RECORD) ACCEPTED AS BEST AVAILABLE EVIDENCE OF ORIGINAL SECTION CORNER LOCATION
 SET: REPLACED FOUND MON W/STD USFS MON 6" ABOVE GROUND IN A 12"x12"x6" MOS BURIED FOUND MON ALONGSIDE.

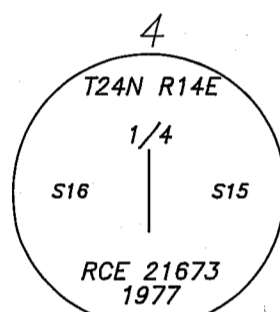

RECORD: SET A POST 4 FEET LONG AND 4 INCHES DIAMETER 2 FEET DEEP IN A MOUND 4 1/2 FEET DIAMETER AT BASE AND 2 FEET HIGH WITH PITS 24X18X12 FOR QUARTER SECTION CORNER.
 FOUND: STD USFS MON 8" ABOVE GROUND IN A 36"x36"x6" MOS (5RS80)
 SET: NOTHING

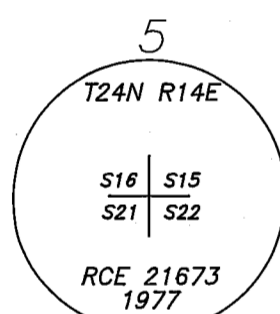

RECORD: SET A POST 5 FEET LONG, 4 INCHES DIAMETER AND 2 FEET DEEP IN A MOUND 4 1/2 FEET IN DIAMETER AT BASE AND 2 FEET HIGH FOR CORNER TO SECTIONS 15,16,21,22 WITH PITS 24X18X12.
 FOUND: STD USFS MON 8" ABOVE GROUND IN A 36"x36"x7" MOS (5RS80)
 SET: NOTHING

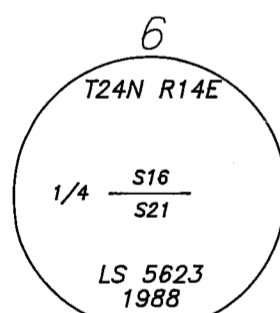

RECORD: SET A POST 4 FEET LONG AND 4 INCHES DIAMETER 2 FEET DEEP IN A MOUND 4 1/2 FEET IN DIAMETER AT BASE, 2 FEET HIGH WITH PITS 24X18X12 FOR QUARTER SECTION CORNER.
 FOUND: 1/2" REBAR 4" W/1 1/2" ALUM CAP LS 2843. 4" ABOVE GROUND (5RS97) ACCEPTED AS 1/4 CORNER, HAMBY PRORATE
 SET: REPLACED WITH A STD USFS DRIVE-IN MON 6" ABOVE GROUND IN A 18"x18"x6" MOS AND BURIED FOUND MON ALONGSIDE.

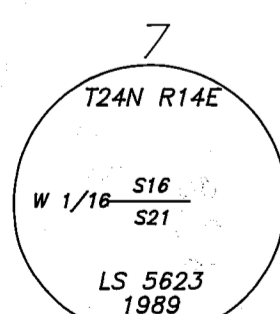

RECORD: NOTHING SET (GLO)
 FOUND: NOTHING
 SET: STD USFS DRIVE-IN MON 24" OF ROD 18"x18"x6" MOS.
 FWB: 11" JP S 09'22" W 4.7 FT SCRIBED "W1/16 S21BT"
 10" JP S 85'22" W 9.0 FT SCRIBED "W1/16 S21BT"

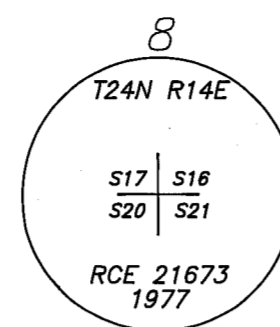

RECORD: SET A STONE 24X15X6 IN A STONE MOUND 4 1/2 FEET IN DIAMETER AT BASE AND 2 FEET HIGH FOR CORNER TO SECTIONS 16,17,20,21 ON A BED OF ROCKS.
 FOUND: STD USFS MON 4" ABOVE GROUND IN A 36"x36"x6" MOS (5RS80)
 FWB: 11" JP S 44' E 68.5 FT (5RS80)
 16" JP N 86" W 24.8 FT (5RS80)
 16" JP N 06" W 52.0 FT (5RS80)
 SET: NOTHING

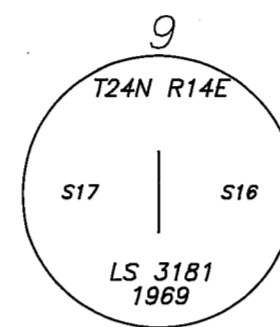

RECORD: SET A POST 4 FEET LONG AND 4 INCHES IN DIAMETER, 2 FEET DEEP IN A MOUND 4 1/2 FEET IN DIAMETER AT BASE AND 2 FEET HIGH WITH PITS 24X18X12 FOR QUARTER SECTION CORNER.
 FOUND: STD DWR MON 9" ABOVE GROUND IN A 42"x30"x8" MOS (NO OFFICIAL RECORD), ACCEPTED AS BEST AVAILABLE EVIDENCE OF ORIGINAL 1/4 CORNER LOCATION
 FWB: 26" JP S 30 1/2' E 60.7 FT W/CLOSED FACE AND BT TAG (NO RECORD).
 32" JP N 58' W 77.9 FT W/CLOSED FACE AND BT TAG (NO RECORD).
 SET: NOTHING

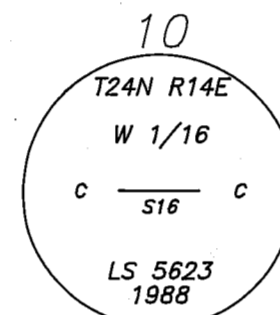

RECORD: NOTHING SET (GLO)
 FOUND: NOTHING
 SET: STD USFS DRIVE-IN MON 3" ABOVE GROUND 30"x24"x3" MOS.

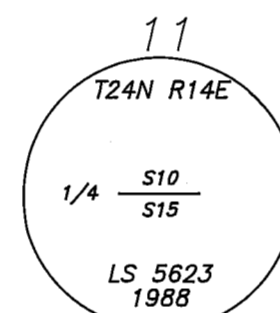

RECORD: SET A POST 4 FEET LONG AND 4 INCHES DIAMETER 2 FEET DEEP IN A MOUND 4 1/2 FEET IN DIAMETER AT BASE AND 2 FEET HIGH WITH PITS 24X18X12 FOR QUARTER SECTION CORNER.
 FOUND: 24"x24"x6" MOS (NO RECORD) ACCEPTED AS BEST AVAILABLE EVIDENCE OF ORIGINAL 1/4 CORNER LOCATION.
 FWB: 33" JP S 28 1/2' W 13.6 FT (NO RECORD) W/1952 LOCATION POSTER AND A 1971 RP BEARING TREE TAG READING "ASSUMED CORNER"
 SET: STD USFS MON 6" ABOVE GROUND 24"x24"x4" MOS.
 FWB: NEW BT'S
 33" JP S 28 1/2' W 13.6 FT SCRIBED "1/4 S15BT"
 28" JP N 06 1/2' W 37.8 FT SCRIBED "1/4 S10BT"

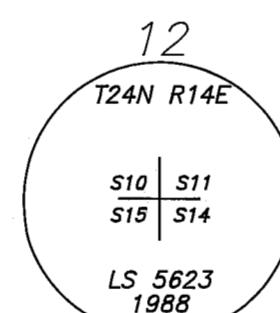

RECORD: SET VOLCANIC STONE 20X15X10 IN STONE MOUND 5 FEET IN DIAMETER AT BASE AND 2 FEET HIGH FOR CORNER TO SECTIONS 10,11,14,15.
 FOUND: MOS W/BT TAGS IN MOUND, ACCEPTED AS BEST AVAILABLE EVIDENCE OF ORIGINAL SECTION CORNER LOCATION.
 SET: STD USFS DRIVE-IN CAP ON A STAR DRILL SHAFT 10" LONG, 6" ABOVE GROUND 24"x24"x6" MOS.
 FWB: NEW BT'S
 22" JUN N 56'29" E 65.4 FT SCRIBED "T24NR14ES11BT"
 9" JUN S 40'31" E 59.1 FT SCRIBED "T24NR14ES14BT"
 7" JUN S 30'48" E 62.7 FT SCRIBED "T24NR14ES15BT"
 22" JUN N 56'14" W 106.2 FT SCRIBED "T24NR14ES10BT"

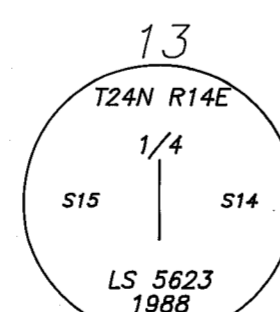

RECORD: SET A STONE 15X12X6 IN A STONE MOUND 4 1/2 FEET IN DIAMETER AT BASE AND 2 FEET HIGH FOR QUARTER SECTION CORNER ON A BED OF ROCKS.
 FOUND: MOS W/BT TAG IN MOUND ACCEPTED AS BEST AVAILABLE EVIDENCE OF ORIGINAL 1/4 CORNER LOCATION
 SET: STD USFS DRIVE-IN CAP ON A STAR DRILL SHAFT 10" LONG, 6" ABOVE GROUND 24"x24"x6" MOS.
 FWB: NEW BT'S
 23" JP N 18 1/2' E 48.1 FT SCRIBED "1/4 S14BT"
 18" JP N 88 1/2' W 69.3 FT SCRIBED "1/4 S15BT"

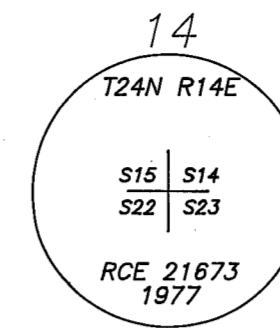

RECORD: SET A POST 5 FEET LONG AND 4 INCHES DIAMETER AND 2 FEET DEEP FOR CORNER TO SECTIONS 14,15,22,23 FROM WHICH FWB:
 A YELLOW PINE 24 INCHES DIAMETER BEARS N.64'E 41 LINKS
 A BLACK PINE 18 INCHES DIAMETER BEARS S.80'W 35 LINKS
 A FIR 12 INCHES DIAMETER BEARS S.53'E 76 LINKS.
 FOUND: STD USFS MON 12" ABOVE GROUND IN A 36"x36"x6" MOS (5RS80)
 FWB: 24" PINE N 62'35" E 27.5 FT (GLO)
 10" IC N 63'55" W 18.6 FT (5RS80)
 10" WF N 80'22" E 16.8 FT (5RS80)
 SET: NOTHING

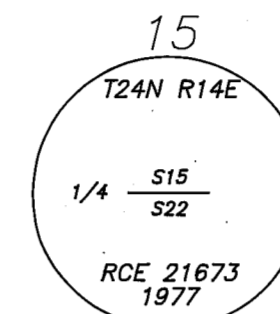

RECORD: SET A POST 4 FEET LONG 4 INCHES DIAMETER 2 FEET DEEP IN A MOUND 4 1/2 FEET IN DIAMETER AT BASE AND 2 FEET HIGH WITH PITS 24X18X12 FOR QUARTER SECTION CORNER.
 FOUND: STD USFS MON 6" ABOVE GROUND IN A 36"x36"x6" MOS (5RS80)
 FWB: 13" PINE N 15' W 105.8 FT SCRIBED "1/4 S15BT" (5RS80)
 18" PINE S 18' E 45.3 FT SCRIBED "1/4 S22BT" (5RS80)
 SET: NOTHING

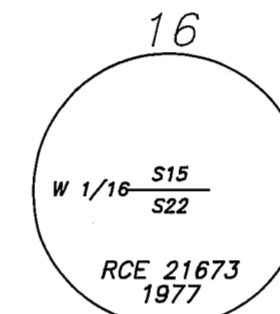

RECORD: NOTHING SET (GLO)
 FOUND: STD USFS MON 3" ABOVE GROUND (5RS80)
 SET: NOTHING

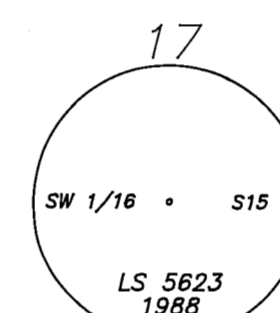

RECORD: NOTHING SET (GLO)
 FOUND: NOTHING
 SET: STD USFS ROCK CAP MORTARED INTO A 30"x30"x6" MOS
 FWB: NEW BT'S
 12" JUNIPER (MULTIPLE TRUNKS) S 76 1/2' E
 77.6 FT SCRIBED "SW 1/16 S15BT"

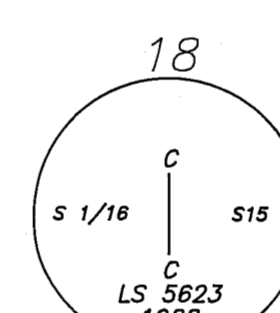

RECORD: NOTHING SET (GLO)
 FOUND: NOTHING
 SET: STD USFS DRIVE-IN MON ON 36" LENGTH OF ROD, 6" ABOVE GROUND IN A 36"x36"x5" MOS.
 FWB: NEW BT'S
 19" JP N 25 1/2' E 32.7 FT SCRIBED "CS 1/16 S15BT"
 13" JP S 62 1/2' E 37.9 FT SCRIBED "CS 1/16 S15BT"

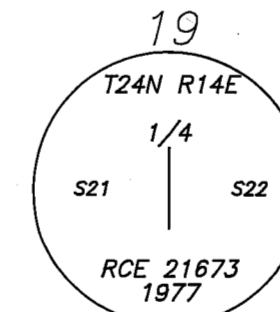

RECORD: SET STONE 20X15X12 IN A STONE MOUND 4 1/2 FEET IN DIAMETER AT BASE AND 2 FEET HIGH FOR QUARTER SECTION CORNER.
 FOUND: STD USFS MON 10" ABOVE GROUND IN A 48"x48"x6" MOS (5RS80)
 FWB: 15" JP N 74'38" E 57.0 FT (5RS80)
 14" JP S 29'40" W 76.7 FT (5RS80)
 SET: NOTHING

RECORD OF SURVEY

LOCATION IN SECTION 15,16,AND 21. T24N R14E MDM COUNTY OF PLUMAS, STATE OF CALIFORNIA FOR THE PLUMAS NATIONAL FOREST.

SURVEY CREW: R.KNOETTGEN	D.HOBBS
J.SCHMIDT	L.GROSS
H.STOKES	B.WILLARD

DRAWN BY: J.HARTSFIELD SHEET 2 OF 3