

SURVEYOR'S STATEMENT
 This map correctly represents a survey made by me or under my direction in conformance with the requirements of the Land Surveyors' Act at the request of Wayne Shumate in April, 1991.

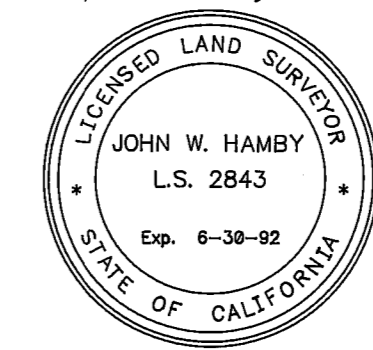

John W. Hamby
 John W. Hamby LS 2843

COUNTY SURVEYOR'S STATEMENT
 This map has been examined in accordance with Section 8766 of the Land Surveyors' Act this 22nd day of August, 1991

Lawrence J. Brock
 Lawrence J. Brock RCE 13528
 PLUMAS COUNTY SURVEYOR
 License Expiration Date 3/31/93

RECORDER'S STATEMENT
 Filed this 22nd day of August, 1991 at 2:25 p.m. in Book 9 of Record of Surveys, at page 22, at the request of the County Engineer.

Fee \$500
 File No. 6326
 Judith Wells
 County Recorder
 Deputy *Beth Ammark*

BASIS OF BEARING
 The Basis of Bearings of this map is the North line of Parcel 1 of 5 PM 150 Plumas County records, which is shown as S 88°28'00" W.

RECORD OF SURVEY
 for
 Wayne Shumate
 A portion of the NE 1/4 of Section 17
 T. 23 N., R. 14 E., M.D.M.
 PLUMAS COUNTY - CALIFORNIA
 SCALE 1" = 100' APRIL, 1991

HAMBY SURVEYING INC.
 P.O. Box 1209
 PORTOLA, CA. 96122
 Phone 916-832-5571

LINE	DIRECTION	DISTANCE
L1	N 87°36'34" E	272.24' (N 87°41' E 272.08' R6)
L2	N 87°37'30" E	232.16' (N 86°40'10" E 232.00' R5)

(Record Per R5)

CURVE	RADIUS	LENGTH	DELTA	RADIUS	LENGTH	DELTA
C1	500.00'	93.40'	10°42'09"	500.00'	93.85'	10°45'15"
C2	500.00'	124.17'	14°13'42"	500.00'	124.17'	14°13'42"

- LEGEND**
- FOUND point as described
 - FOUND Rebar with Aluminum Cap LS 2843
 - SET 5/8" Rebar & Aluminum Cap LS 2843
 - (R1) RECORD per 2 RS 9
 - (R2) RECORD per 5 PM 150
 - (R3) RECORD per 8 PM 9
 - (R4) RECORD per 8 PM 20
 - (R5) RECORD per 241 OR 600
 - (R6) RECORD per 2 M 11
 - (R7) RECORD per 344 OR 165
 - (R8) RECORD per 178 OR 453