

73  
1317

(N. 89° 58' 15" W., 1331.16')<sup>1</sup>  
N. 89° 59' 14" W., 1330.66'

One-Sixteenth Corner.  
Fnd. 3/4" I.P. tagged L.S. 3202  
per Bk. 4 of Records of Survey,  
Page 128.

Section Corner, Sec. 7, 8, 17, 18,  
Twp. 36N., Rge. 10E., M.D.B.M.  
Fnd. 1-3/4" I.P. tagged L.S. 3202 in rock  
mnd. per Book 4 of Records of Survey, Page  
128.  
Fnd. 8' section of rotten pine tree bole  
with blazes and defaced scribing. See note 5.

U.S.A., ADMINISTERED BY B.L.M.

BASIS OF BEARINGS

Due S., 1319.78' (Due S., 1320.00')<sup>1</sup>

Due W., 90.59'

Due N.,  
156.67'

Fnd 3/4" I.P. tagged L.S. 3202  
per Book 4 of Records of Survey,  
Page 128, 4" below road surface.

N-S blazed line. See Note 4.

fence monument set at intersection of  
blazed line and fence line.

S. 25° 07' 54" W., 26.96'

S. 04° 01' 42" W., 199.09'

S. 11° 19' 41" W., 25.39'

S. 00° 15' 50" W., 71.79'

S. 04° 39' 22" E., 53.65'

S. 00° 55' 43" W., 129.37'

S. 00° 48' 22" W., 135.30'

S. 03° 50' 03" W., 96.45'

S. 02° 57' 47" E., 81.50'

S. 02° 16' 05" W., 46.73'

S. 00° 23' 07" E., 51.78'

S. 01° 17' 21" W., 159.22'

S. 01° 11' 08" W., 70.58'

S. 03° 35' 08" W., 52.56'

S. 07° 37' 06" W., 109.61'

Southerly terminus of bdry. fence line.

N 41° 40' 15" W., 48.66'

Due North, 348.02'

Corner set on Southerly end of  
adjudicated boundary. See figure  
3.

N. 74° 45' 00" W., 2071.74'

BASIS OF BEARINGS: The West line of the northeast  
quarter of the Northeast quarter of Section 18 per  
Book 4 of Records of Surveys, Page 128, taken as  
Due South.



Gorbet ownership as shown  
at Book 4 of Records of  
Survey, Page 128. Not  
surveyed here.

N. 89° 59' 14" W., 1330.66'

73  
1317

S. 90° 00' 00" E., 1321.98'

Boundary of S & O Survey

U.S.A.  
ADMINISTERED BY B.L.M.

LANDS OF WARREN GORBET (PORTION)  
179 O.R. 586

LANDS OF SAM KINGDON

S. 47° 15' 00" E., 1751.64'  
Calc. only

S. 05° 30' 00" E., 2183.28'  
Calc. only

N. 71° 15' 00" W., 2230.80'  
Calc. only

S. 08° 08' 00" W., 1075.80'  
Calc. only

N. 74° 45' 00" W., 2071.74'  
Calc. only

FIGURE 2. DETAIL SHOWING MONUMENTS  
SET ALONG FENCE LINE, THE ADJUDICATED  
BOUNDARY BETWEEN LANDS OF GORBET AND  
KINGDON.

SCALE 1" : 200'

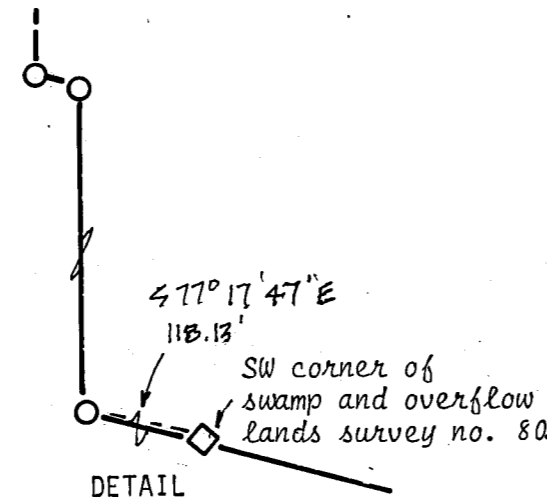

Note: This point established by  
calculating record courses from  
the point of beginning as shown  
on sheet 1.

SW corner S.O L. 80,  
Calif. grid coordinates (Zone 1)  
285,328.537  
2,308,971.919

LEGEND

- ... Fnd. monument as noted.
- ... Set 1-1/2" aluminum monument on  
5/8" x 18" rebar stamped L.S. 4342.
- ... Section corner or quarter Section  
corner as noted.
- ... Boundary line.
- ◇ ... Calculated point, nothing set.

PURPOSE OF SURVEY

Note: The purpose of this survey is to describe and  
locate the adjudicated boundary between lands of  
Warren Gorbet and Alva S. Kingdon, et. ux. according  
to that Judgement rendered in Plumas County Superior  
Court, No. 11256.

FIGURE 3. THE UNADJUSTED BOUNDARIES  
OF SWAMP AND OVERFLOW SURVEY NO. 80.

SCALE 1" : 500'

A RECORD OF SURVEY

OF CERTAIN LINES IN SECTION 17 AND 18, TWP. 26N.,  
RGE. 10E., M.D.B.M. IN THE UNINCORPORATED TERRITORY  
OF PLUMAS COUNTY, CALIFORNIA FOR:

WARREN A. GORBET

179 O.R. 586

MARCH 1985

THOMAS M. WULFERT  
LAND SURVEYOR

SHEET 2 OF 2

L.S. 4342  
RED BLUFF, CALIF.

SCALE: AS NOTED