

NOTE:
 THE GRID DISTANCES SHOWN IN 263 O.R. 54 WERE CONVERTED TO GROUND DISTANCES AS SHOWN ON R/S BK. 3, PAGE 87, BY MULTIPLYING BY 1.0002675

LEGEND

- FOUND MONUMENTS PER 1 R.S. 136 OR 2 R.S. 126, OR AS NOTED
- FOUND 6" x 6" CONCRETE HIGHWAY MONUMENTS
- FOUND 1/4" I.P. TAGGED "L.S. 2322" PER UNRECORDED SURVEY FOR T.S. WALKER, DATED DECEMBER, 1955, EXCEPT AS NOTED
- SET 1/2" REBAR W/CAP STAMPED "L.S. 3989"

BASIS OF BEARINGS

THE BASIS OF BEARINGS FOR THIS MAP IS THE NORTHWESTERLY RIGHT OF WAY LINE OF STATE HIGHWAY 36, SHOWN AS N. 30° 46' E. IN BOOK 2 OF RECORDS OF SURVEYS ON PAGE 126.

COUNTY SURVEYOR'S STATEMENT

THIS MAP HAS BEEN EXAMINED IN ACCORDANCE WITH SECTION 8760 OF THE LAND SURVEYOR'S ACT THIS 7TH DAY OF July, 1990.

Lawrence J. Brock
 LAWRENCE J. BROCK R.C.E. 13528

SURVEYOR'S STATEMENT

THIS MAP CORRECTLY REPRESENTS A SURVEY MADE BY ME OR UNDER MY DIRECTION IN CONFORMANCE WITH THE REQUIREMENTS OF THE LAND SURVEYOR'S ACT AT THE REQUEST OF KEN WILLIS IN JUNE, 1990.

Fred R. Nagel
 FRED R. NAGEL, L.S. 3989

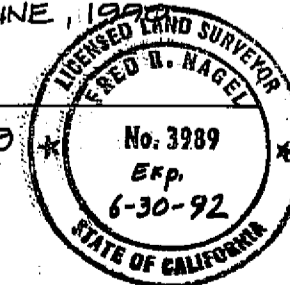

COUNTY RECORDER'S STATEMENT

FILED THIS 31ST DAY OF July, 1990, AT 9:47 AM, IN BOOK 8 OF RECORDS OF SURVEYS, AT PAGE 130, AT THE REQUEST OF THE COUNTY ENGINEER.

FEE: \$ 500
 FILE NO: 5095

ILA DIGGS
 COUNTY RECORDER
Arlene A. Perry
 BY DEPUTY

RECORD OF SURVEY

FOR
KEN WILLIS

A PORTION OF THE NW 1/4, AND THE NW 1/4 OF THE SW 1/4 OF SECTION 18, T. 28N., R. 7E. MDM PLUMAS COUNTY, CALIFORNIA
 SCALE: 1"=200' JUNE, 1990

NST Engineering Associates, Inc.
 45 South Roop Street
 Susanville, California
 916-257-5173 SHEET 1 of 1

