

MONUMENTATION

SCHEDULE

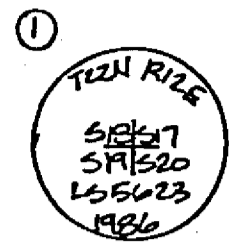

FOUND: NOTHING  
SET: STANDARD U.S.F.S. MONUMENT, UP 10", IN 3'x3'x10" M.O.S.  
F.W.B.: 15" FIR N61°16'W 48.6 FT. MKD. 'T22N RIZE S16 BT'  
11" PINE S67°27'W 25.2 FT. MKD. 'T22N RIZE S18 BT'  
16" FIR S02°41'W 37.8 FT. MKD. 'T22N RIZE S18 BT'  
NOTE: SET BY DOUBLE PROCRATION

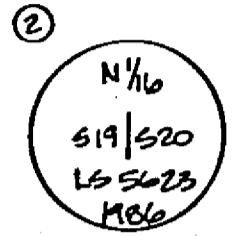

FOUND: NOTHING  
SET: STANDARD U.S.F.S. MONUMENT, UP 8", IN 3'x3'x8" M.O.S.  
F.W.B.: 9" CEDAR N73°27'E 10.8 FT. MKD. 'N 1/16 S20 BT'  
10" D. FIR S53°25'W 13.2 FT. MKD. 'N 1/16 S18 BT'



FOUND: NOTHING  
SET: STANDARD U.S.F.S. MONUMENT UP 7" IN 3'x3'x7" M.O.S.  
F.W.B.: 15" PINE N31°03'W 23.8 FT. MKD. '1/4 S18 BT'  
13" CEDAR S23°40'E 21.6 FT. MKD. '1/4 S20 BT'  
NOTE: SET BY SINGLE PROCRATION

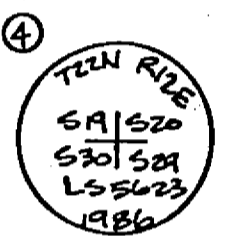

FOUND: 12"x9"x6" STONE WITH 2 NOTCHES ON THE SOUTH EDGE AND 5 NOTCHES ON THE EAST EDGE (REC: 12"x9"x6" STONE)  
SET: STANDARD U.S.F.S. MONUMENT, UP 6", IN 36" M.O.S. PLACED ORIGINAL STONE ON NORTH SIDE OF MONUMENT.  
F.W.B.: 18" W. FIR N70°32'W 59.5 FT. MKD. 'T22N RIZE S20 BT'  
20" W. FIR S7°01'E 26.4 FT. MKD. 'T22N RIZE S29 BT'  
15" W. FIR N31°29'W 6.8 FT. MKD. 'T22N RIZE S19 BT'  
15" W. FIR S62°22'W 6.8 FT. MKD. 'T22N RIZE S30 BT'



FOUND: NOTHING  
SET: STANDARD U.S.F.S. MONUMENT, UP 6", IN 24" M.O.S.  
F.W.B.: 14" W. FIR N67°42'E 12.1 FT. MKD. 'E 1/16 S18 BT'  
13" W. FIR S12°20'W 7.8 FT. MKD. 'E 1/16 S30 BT'

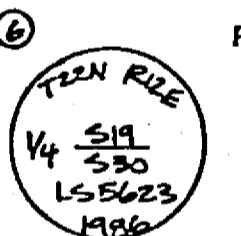

FOUND: 14"x8"x4" STONE WITH 1/4" MARKED ON FACE IN 26"x28"x9" M.O.S. (REC: 14"x9"x6" STONE MKD. '1/4" ON WEST SIDE)  
SET: STANDARD U.S.F.S. MONUMENT, UP 10", IN 30" M.O.S.; PLACED ORIGINAL STONE ON NORTH SIDE OF MONUMENT.  
F.W.B.: PINE STUMP S 21°26'W 56.7 FT. WITH SCRIBING VISIBLE (REC: 40" PINE S 11°W 85.1 Ks.)  
13" D. FIR S31°E 13.8 FT. MKD. '1/4 S30 BT'  
22" S. PINE N47°W 87.0 FT. MKD. '1/4 S18 BT'

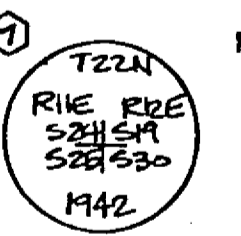

FOUND: STANDARD BLM MONUMENT, UP 8", IN 36" M.O.S.  
F.W.B.: 37" PINE SNAG N80°E 27.5 FT. WITH SCRIBING VISIBLE (REC: 35" PINE N80°E 42.1 Ks.)  
36" PINE S23°W 14.4 FT. WITH SCRIBING VISIBLE (REC: 30" PINE S15°40'W 20.1 Ks.)  
11" PINE S50°W 50.5 FT. WITH A HEALED BLAZE (1942 BLM REC: 8" PINE S49°W 77.1 Ks.)  
13" PINE N14°W 45.6 FT. WITH A HEALED BLAZE (1942 BLM REC: 6" PINE N14°W 51.1 Ks.)  
9" PINE S03°E 35.3 FT. WITH HEALED BLAZE (1942 BLM REC: 4" PINE S3°40'E 53.1 Ks.)

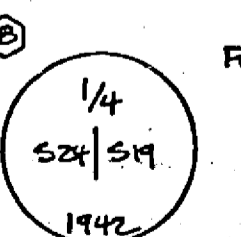

FOUND: STANDARD BLM MONUMENT, UP 12", IN 36" M.O.S.  
F.W.B.: 16" L. PINE N60°50'E 49.1 FT. (1942 BLM REC: 10" PINE N50°10'E 75.1 Ks.)  
22" L. PINE S79°30'W 42.5 FT. (1942 BLM REC: 18" PINE S78°W 64.1 Ks.)



FOUND: STANDARD BLM MONUMENT, UP 9"; BUILT 24" M.O.S.  
F.W.B.: 19" W. FIR N37°47'E 17.5 FT. (1951 BLM REC: 12" FIR N36°1/2°E 27.1 Ks.)  
22" W. FIR S07°20'W 20.7 FT. (1951 BLM REC: 10" FIR S6°W 30.1 Ks.)



FOUND: STANDARD B.L.M. MONUMENT, UP 12"  
F.W.B.: 19" FIR N16°14'E 46.3 FT. (1942 BLM REC: 6" FIR N15°1/4°E 70.1 Ks.)  
16" FIR S32°01'E 95.0 FT. (1942 BLM REC: 9" FIR S31°3/4°E 146.1 Ks.)  
16" FIR N25°59'W 67.6 FT. (1942 BLM REC: 9" FIR N25°W 104.1 Ks.)

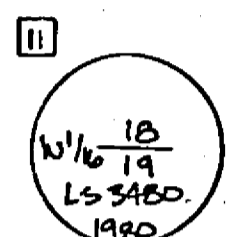

FOUND: 1" IRON PIPE WITH 2 1/4" PARKS AND RECREATION CAP, UP 7", WITH A 6" STEEL POST ALONG SIDE  
F.W.B.: 5" PINE S05°47'E 13.8 FT. MKD. 'W 1/16 S18 BT'  
18" PINE N61°12'E 77.8 FT. MKD. 'W 1/16 S18 BT'

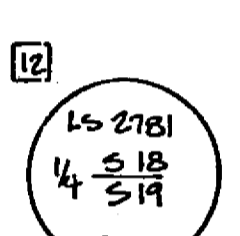

FOUND: 3/4" IRON PIPE WITH 2 1/2" BEACHES AND PARKS CAP, UP 12", IN A 36" M.O.S. (REC: 2 R.S. 77)  
F.W.B.: 18" FIR S68°49'W 25.7 FT.  
21" FIR N08°11'W 23.1 FT.  
49" PINE S88°42'E 58.6 FT. (LINE TREE) (REC: 36" PINE S89°37'E 88.1 Ks.)

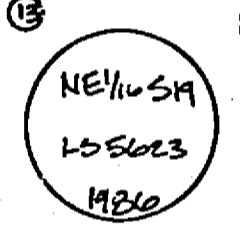

FOUND: NOTHING  
SET: STANDARD U.S.F.S. MONUMENT, UP 6", IN 24"x36"x12" M.O.S.  
F.W.B.: 14" W. FIR S43°35'E 97.3 FT. MKD. 'NE 1/16 S18 BT'  
25" PINE S24°33'W 126.6 FT. MKD. 'NE 1/16 S18 BT'

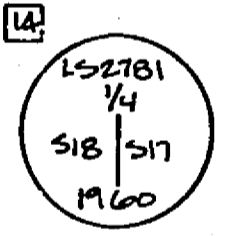

FOUND: 3/4" IRON PIPE WITH 2 1/2" BEACHES AND PARKS CAP (REC: 2 R.S. 77)  
F.W.B.: 30" PINE S86°30'W 53.3 FT. (2 R.S. 77: 30" PINE S84°30'W 52.2 FT.)  
18" PINE S46°30'E 71.5 FT. (2 R.S. 77: 14" PINE S84°18'E 73.3 FT.)  
36" PINE S78°W 80.5 FT. (2 R.S. 77: 24" PINE S78°30'W 50 FT.) (REC: 24" PINE S77°W 70.1 Ks.)

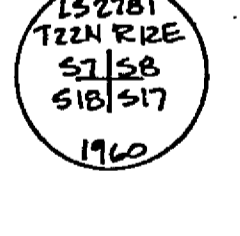

FOUND: 1 1/2" IRON PIPE WITH 2 1/2" BEACHES AND PARKS CAP, UP 6", IN A 24"x24"x4" M.O.S.  
F.W.B.: 50" PINE N53°49'W 172.8 FT. (2 R.S. 77: 40" PINE N55°30'W 171.2 FT.)  
14" FIR S34°35'W 82.0 FT. (2 R.S. 77: 14" FIR S32°30'W 81.8 FT.)  
29" S. PINE S17°11'E 72.4 FT. (2 R.S. 77: 15" S.P. S18°30'E 71.9 FT.)



FOUND: NOTHING, CORNER POSITION FALLS IN JOHNSVILLE ROAD  
SET: STANDARD U.S.F.S. MONUMENT AS A WITNESS CORNER, UP 6", IN 24" M.O.S. WHICH LIES N89°38'23"W 164.40 FEET FROM THE TRUE W 1/16 CORNER POSITION  
F.W.B.: 5" J. PINE N78°54'W 32.6 FT. MKD. 'X' BT'  
9" D. FIR N03°58'E 73.0 FT. MKD. 'X' BT'

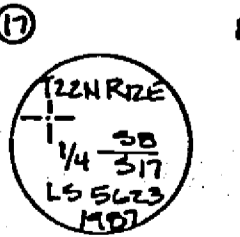

FOUND: BURIED 3/4" IRON PIPE PROTECTED BY 4"x12" RAILROAD RAIL  
SET: STANDARD U.S.F.S. MONUMENT, UP 6", IN 18"x18"x6" M.O.S. OVER EXISTING PIPE  
F.W.B.: 29" PINE S02°38'E 60.1 FT. MKD. '1/4 S17 BT'  
8" PINE S30°47'E 29.4 FT. MKD. '1/4 S17 BT'

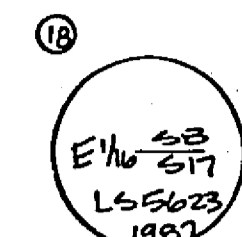

FOUND: 3/4" IRON PIPE UNTAGGED, UP 8", BENT AT BASE, OUT OF POSITION, S55°23'41"W 6.93 FT.; DID NOT ACCEPT.  
SET: STANDARD U.S.F.S. PIPE, UP 6", IN 18"x18"x4" M.O.S.; BURIED 3/4" PIPE ALONGSIDE  
F.W.B.: 18" PINE N62°23'W 22.2 FT. MKD. 'E 1/16 S28 BT'  
7" CEDAR S38°01'E 20.6 FT. MKD. 'E 1/16 S17 BT'

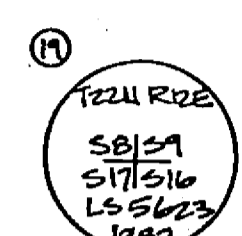

FOUND: 1" IRON BOLT WITH SQUARE HEAD, TAGGED R.C.E. 15265, UP 2"  
SET: STANDARD U.S.F.S. PIPE, UP 8", IN 18" M.O.S., BURIED BOLT ALONGSIDE  
F.W.B.: 26" PINE S25°27'E 110 FT. MKD. 'T22N RIZE S16 BT'  
14" PINE S28°49'W 27.8 FT. MKD. 'T22N RIZE S17 BT'  
28" PINE N05°10'W 29.1 FT. MKD. 'T22N RIZE S28 BT'  
7" PINE N33°51'E 60.7 FT. MKD. 'T22N RIZE S18 BT'

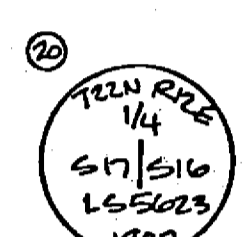

FOUND: 1/2" REBAR WITH DECAYED PLASTIC CAP, UP 4", IN 36" M.O.S.  
SET: STANDARD U.S.F.S. MONUMENT, UP 8", IN 24"x30" M.O.S., BURIED REBAR ALONGSIDE  
F.W.B.: DOWN AND DECAYED LOG WITH VISIBLE SCRIBING N78°30'E 26.4 FT. (REC: 7" P. PINE N72°4'E 27.1 Ks.)  
DOWN AND DECAYED LOG WITH VISIBLE SCRIBING S52°24'W 38.1 FT. (REC: 8" W. PINE S51°1/2°W 67.1 Ks.)  
8" J. PINE N76°39'E 14.6 FT. MKD. '1/4 S16 BT'  
14" J. PINE S40°51'W 14.8 FT. MKD. '1/4 S17 BT'

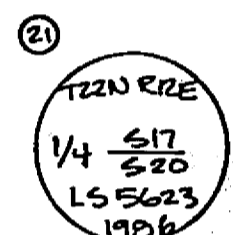

FOUND: 20"x15"x3" SLATE STONE MKD. '1/4' ON THE NORTH FACE IN A 18" M.O.S. (REC: SAME)  
SET: STANDARD U.S.F.S. MONUMENT, UP 6", IN 36"x30" M.O.S. PLACED ORIGINAL STONE IN M.O.S.  
F.W.B.: ROTTED PINE STUMP S40°W 7.6 FT. (REC: 14" PINE S49°W 11.1 Ks.)  
12" CEDAR N61°11'W 48.0 FT. MKD. '1/4 S17 BT'  
10" PINE S45°E 12.9 FT. MKD. '1/4 S20 BT'

RECORD OF SURVEY

THE U.S.D.A.-PLUMAS NATIONAL FOREST

LOCATED IN SECTIONS 17 AND 19 TOWNSHIP 22 NORTH, RANGE 12 EAST, MOUNT DIABLO MERIDIAN, PLUMAS COUNTY, CALIFORNIA.

WILLIAM G. SNOW L5 5623