

CORNER NOTES

(FROM SHEET 2)

① MS5779
S#9
LS4753 1988
Fd. Post in M.O.S. and
35" Ponderosa Pine N 36° E 35.5'
Stump S 21° E 40.0'
Set A.C.A.P. in M.O.S. and marked
6" White Fir S 61° E 13.4' (XBT)

② MS5779
S#9 1/1 S#6
LS4753 1988
Fd. Post in M.O.S. and
19" Ponderosa Pine S 83° E 21.8'
15" Ponderosa Pine N 18° W 17.1'
Set A.C.A.P. in M.O.S.

③ MS5779 MS4753
S#6 1/1 S#1
LS4753 1988
Fd. Post in M.O.S. and
22" Ponderosa Pine S 75° E 16.5'
Set A.C.A.P. in M.O.S. and marked
6" Cedar S 44° W 5.5'

④ MS4753
S#1 1/4 R#1
LS4753 1988
Fd. Post in M.O.S.
Set A.C.A.P. in M.O.S. and marked
8" White Fir N 82° E 8.8'
6" White Fir S 10° E 5.1'

⑤ MS4753
R#1 1/4 A#1
LS4753 1988
Fd. M.O.S. and
17" Double Black Oak N 2° E 20.5'
Set A.C.A.P. in M.O.S. and marked
13" Black Oak N 37° E 14.7'

⑥ MS4753
A#1 1/1 IC#1
LS4753 1988
Fd. 2 Douglas Fir Stumps
S 81° W 18.0' and S 60° E 52.0'
Set A.C.A.P. in M.O.S. and marked
12" Douglas Fir S 16° W 15.7'
11" Ponderosa Pine S 77° E 23.4'

⑦ MS4753
IC#1 A#1
LS4753 1988
Fd. Post in M.O.S. and
Pine Stump S 23° W 24.2'
Pine Stump S 68° W 39.7'
Set A.C.A.P. in M.O.S. and marked
4" White Fir N 66° W 5.8' (XBT)
6" Ponderosa Pine S 2° E 15.5' (XBT)

⑧ MS5779
S#3 1/4 S#9
S#7
LS4753 1988
Fd. Post in M.O.S. and
24" Ponderosa Pine N 49° W 19.3'
20" Ponderosa Pine S 47° W 44.9'
Set A.C.A.P. in M.O.S.

⑨ MS5779
S#3 1/2 S#6
S#7 1/2 S#5
LS4753 1988
Fd. Post in M.O.S.
Set A.C.A.P. in M.O.S. and marked
20" Ponderosa Pine N 20° E 15.9'
12" Ponderosa Pine S 77° W 7.7'

⑩ IC#1
IC#2 1/10
LS4753 1988
Fd. Post in M.O.S.
Set A.C.A.P. in M.O.S. and marked
7" Douglas Fir N 11° E 10.9'
15" Douglas Fir N 73° E 8.1'

⑪ S#7
2 1/4 S#5
MS5779
LS4753 1988
Fd. Post in M.O.S. and
20" Douglas Fir N 50° W 40.9 (50.8)
Set A.C.A.P. in M.O.S. and marked
12" Douglas Fir S 13° W 45.0'
11" Douglas Fir N 62° E 31.5'

⑫ S#5
2 1/2 S#2
MS5779 MS4753
LS4753 1988
Fd. Post in M.O.S. and
24" Douglas Fir Snag N 30° W 12.2'
Set A.C.A.P. in M.O.S. and marked
3" Douglas Fir S 35° E 9.2' (XBT)
32" Ponderosa Pine S 78° 43' W 107.3'

⑬ MS4753
S#2 1/2 R#2
LS4753 1988
Fd. 43" Douglas Fir S 37° W 35.2' and
21" Ponderosa Pine N 81° E 22.2'
Set A.C.A.P. in M.O.S.

⑭ R#2
2 1/3 A#2
MS4753
LS4753 1988
Fd. 15" Douglas Fir N 84° W 11.0' and
Fir Stump S 13 1/2° E 6.0'
Set A.C.A.P. in M.O.S. and marked
9" Douglas Fir N 30° E 29.6'

⑮ A#2
2 1/2 IC#2
MS4753
LS4753 1988
Fd. Post in M.O.S. and
21" Ponderosa Pine S 88° W 52.2'
Fir Stump S 17° W 15.0'
Set A.C.A.P. in M.O.S. and marked
8" Ponderosa Pine S 44° E 5.3'

⑯ IC#2
3
MS4753
LS4753 1988
Fd. Post in M.O.S. and
24" Cedar N 38° E 1.0'
22" Sugar Pine S 64° E 2.0'
Set A.C.A.P. in M.O.S. and marked
10" Cedar N 75° W 10.4'

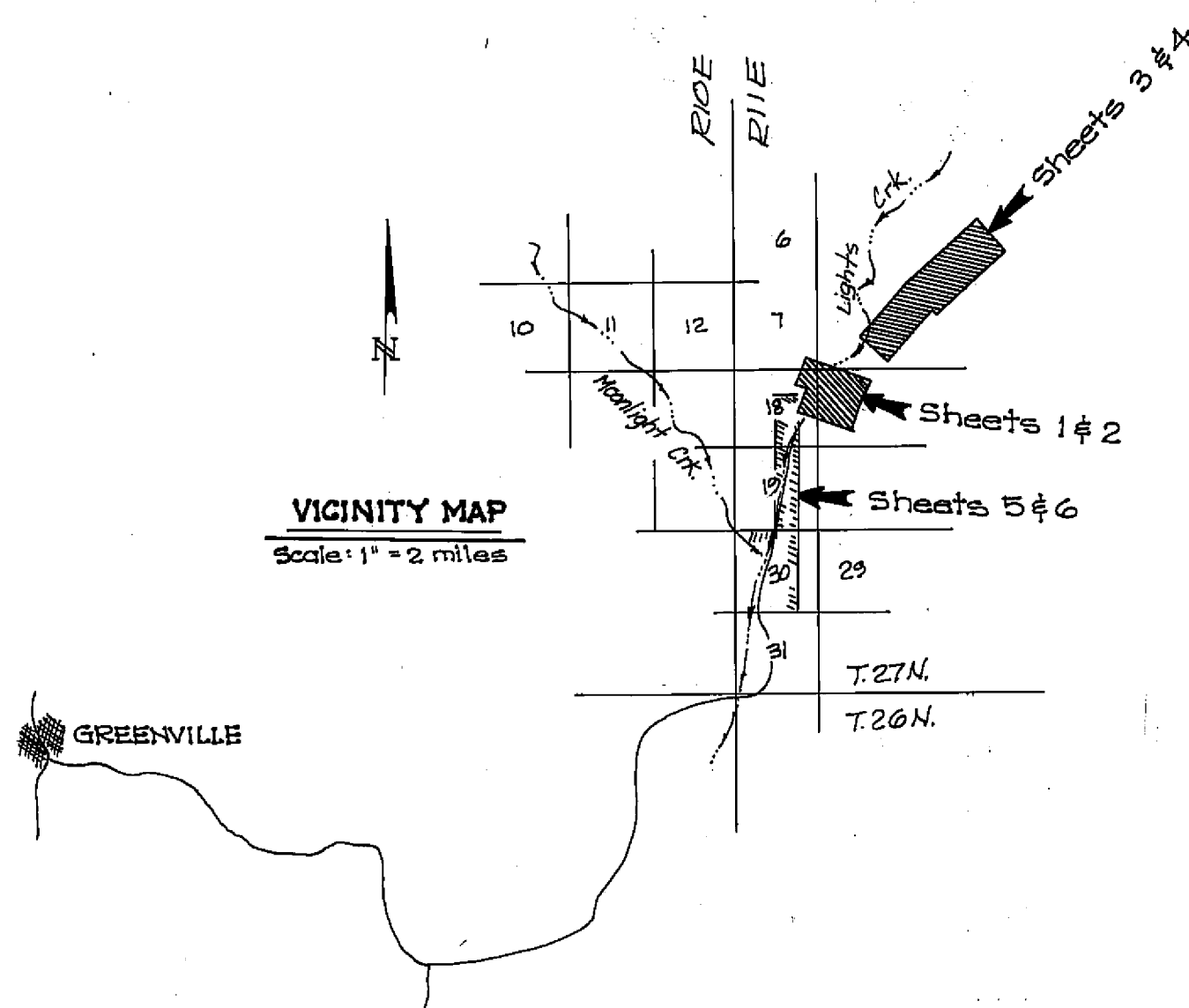

SURVEYOR'S STATEMENT

This map correctly represents a survey made by me, or under my direction in conformance with the requirements of the Land Surveyors' Act at the request of U.S.D.A. Plumas National Forest in July 1988.

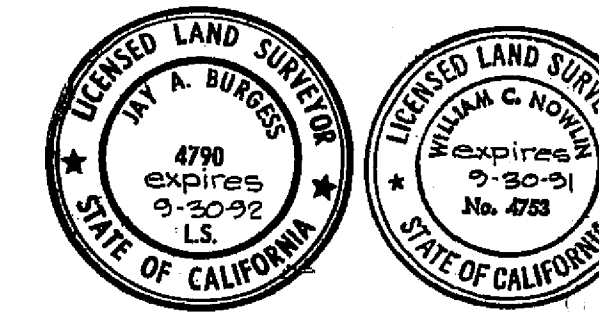

Jay Burgess
Jay A. Burgess L.S. 4790
William C. Nowlin
William C. Nowlin L.S. 4753

COUNTY SURVEYOR'S STATEMENT

This map has been examined in accordance with Section 8766 of the Land Surveyors' Act this 24 day of June, 1989.

Lawrence J. Brock
Lawrence J. Brock R.C.E. 13528

COUNTY RECORDER'S STATEMENT

Filed this 9th day of June, 1989 in Book 8 of Record of Surveys at Page 71-80, Plumas County Records at the request of the County Engineer.

Fee: \$ 15.00
File No. 3421

JoAnn Van Gelder
Deputy
Ila Diggs
County Recorder

= NOTE =
All corners or accessories to corners were found and accepted by this survey on sheets one and two.

RECORD OF SURVEY
FOR
PLUMAS NATIONAL FOREST
"EAST ZONE CADASTRAL SURVEY"
MINERAL SURVEYS No 5256, 5780,
4753 & 5779

Being a portion of sections 3, 4, 5, 8, 9, 18, 19, 30 & 31, T. 27 N., R. 11 E., M.D.M. in the unincorporated territory of Plumas County, California.



May, 1989