

32 + 33 N 89° 47' 31" E 2656.38 (B)

**BASIS OF BEARINGS**

The basis of bearings shown on this map is the line from the Northeast corner of the Southeast 1/4 of the Southwest 1/4 of Section 4, Township 22 North, Range 13 East, Mount Diablo Meridian, to the center 1/4 corner of said Section 4, recorded as N 0° 24' 25" E, in the field notes of the Bureau of Land Management Dependent Resurvey, and Subdivision of Section 4, special instructions Group No. 906, 1985.

**LEGEND**

- Set 1/2" rebar and plastic cap R.C.E. 22836
- Found 3 1/2" Dia. U.S. Forest Service aluminum cap monument marked as shown on 7 RS 84, together with the bearing trees shown 7RS84.
- Found 2 1/2" Dia. Bureau of Land Management brass cap monument marked as described in the field notes of B.L.M. dependent resurvey & subdivision of S.4, T.22 N., R.13 E., M.D.M., special instructions Group No. 906, 1985
- (A) Record information per Bureau of Land Management dependent resurvey and subdivision, S.4, T.22 N., R.13 E., M.D.M., special instructions Group No. 906, 1985
- (B) Record information per 7 RS 83
- + Record position per (A) & (B), not recovered on this survey
- Found 6" X 6" C.D.H. R/W Monument

**NOTE:**  
The intent of this Record of Survey is to monument the Plot Plan approved on September 12, 1988 by the Plumas County Zoning Administrator.

NORTH  
1" = 400'

**PARCEL 1**  
108.33 AC.

**PARCEL 2**  
78.43 AC.

- 34" Stump N 51° 15' E 108.57
- 28" Stump S 51° E 151.14
- 16" Jeffery Pine N 69° 45' E 29.04
- 17" Jeffery Pine S 78° 30' E 43.56
- 19" Jeffery Pine S 2° 15' W 5.61
- 29" Jeffery Pine N 64° 45' W 3.63
- 13" Stump N 52° 30' W 9.24
- 1/2" rebar cap LS 2843
- N 88° 45' W 14.19

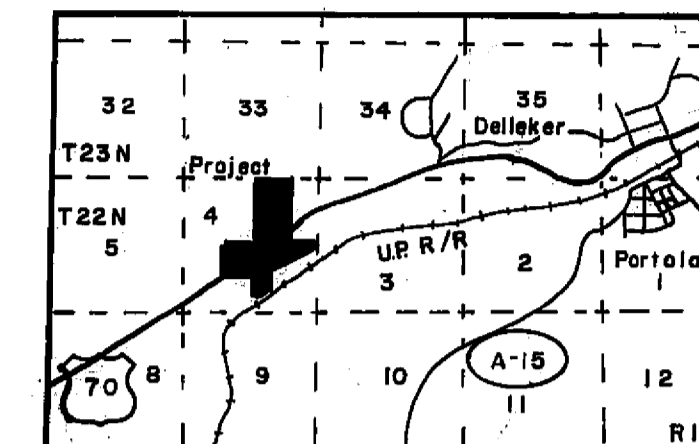

Location Map No Scale

**SURVEYOR'S STATEMENT**

This map correctly represents a survey made by me or under my direction in conformance with requirements of the Land Surveyor's Act at the request of Josephine Steffanic in July 1988.

*Clifford R. Brown*  
Clifford R. Brown RCE 22836



**COUNTY SURVEYOR'S STATEMENT**

This map has been examined in accordance with Section 8766 of the Land Surveyor's Act this 20th day of January, 1989. This survey does not constitute a subdivision under Division 2 of Title 7 of the Government Code.

*Lawrence J. Brock*  
Lawrence J. Brock RCE 13528

**COUNTY RECORDER'S STATEMENT**

Filed this 23rd day of January, 1989, at 11:03 A.M. in Book 8 of Records of Surveys, at page 55, at the request of the County Engineer.

ILA DIGGS  
County Recorder

Fee \$500  
File No. 447

by *Bob Carmack*  
Deputy

**RECORD OF SURVEY**

-FOR-

Martin Espinal et al  
P.O. Box 566  
Portola, CA 96122

within Section 4, T22N, R13E, MDBM

Engineer: Cliff Brown Engineering & Survey  
2335 Ponderosa  
Quincy, CA 95971 283-3959

July 1988

Sheet 1 of 1