

NOTES

BASIS OF BEARING IS TAKEN FROM THE G.L.O. PLAT WHICH IS DUE NORTH ALONG THE TOWNSHIP LINE BETWEEN SECTIONS 25 & 30.

THE ROAD CENTERLINE, AS SHOWN, IS ESTABLISHED FROM THE EXISTING ROAD CENTERLINE AND DOES NOT NECESSARILY MATCH DEED DESCRIPTIONS.

A THOROUGH SEARCH EAST OF SECTION CORNER 1920 3029 PRODUCED NO CORNERS FROM WHICH TO PROPORTION NOR ANY ACCURATE CALLS FROM THE G.L.O. NOTES, THEREFORE THE NORTH POSITION WAS ESTABLISHED BY SINGLE PROPORTION AND THE EAST POSITION WAS ESTABLISHED FROM G.L.O. CALLS TO THE WEST.

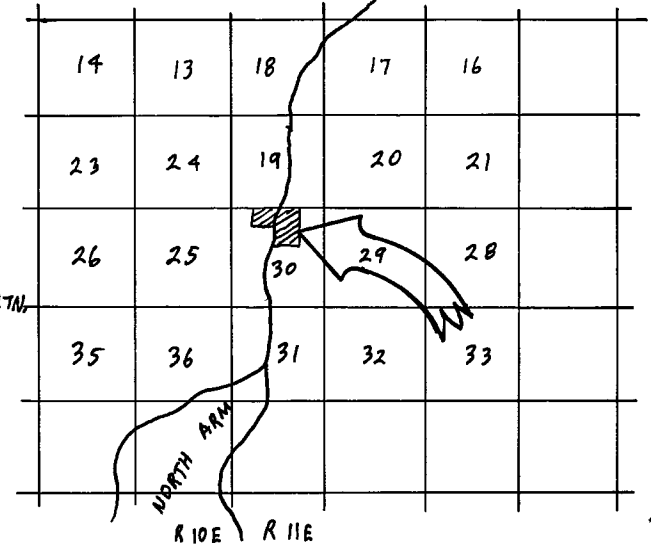

LEGEND

- FOUND CORNER AS IDENTIFIED HEREON ○
- SET 1/2" BEAR CAPPED LS 3297 ◊
- COMPUTED CORNER LOCATION ◌

SURVEYOR'S CERTIFICATE

THIS MAP CORRECTLY REPRESENTS A SURVEY MADE BY ME OR UNDER MY DIRECTION IN CONFORMANCE WITH THE REQUIREMENTS OF THE LAND SURVEYOR'S ACT AT THE REQUEST OF W. WATTENBURG IN APRIL 1979.

Gerald C Henderson
GERALD C. HENDERSON LS 3297

COUNTY SURVEYOR'S CERTIFICATE

THIS MAP HAS BEEN EXAMINED FOR CONFORMANCE WITH THE REQUIREMENTS OF THE LAND SURVEYOR'S ACT THIS 20th DAY OF June 1979.

Lawrence J. Brock
LAWRENCE J. BROCK RCR 13528
PLUMAS COUNTY SURVEYOR

RECORDER'S CERTIFICATE

FILED THIS 20th DAY OF June 1979 AT 12:25 P.M. IN BOOK 5 OF RECORD OF SURVEYS, AT PAGE 52, AT THE REQUEST OF THE COUNTY ENGINEER.

FEE \$5.00

RAYNELLE SLATEN
COUNTY RECORDER

FILE NO. 9665

By Frances Nicol
DEPUTY

RECORD OF SURVEY

FOR
W. WATTENBURG APRIL 1979
PORTION OF SECTION 30, T. 27N., R. 11E., MDM
PLUMAS COUNTY, CALIFORNIA

GERALD C. HENDERSON
CIVIL ENGINEER-LAND SURVEYOR
P. O. BOX 1377
PORTOLA, CALIFORNIA