

LEGEND

SCALE - 1" = 200'

○ Indicates 3/4 Pipe Set and Tagged L.S. 2322

● Indicates CORNER FOUND

CENTER LINE ARC Distance Shown on Curves

NOTE

This map is amended to show the correct name of this Railroad.

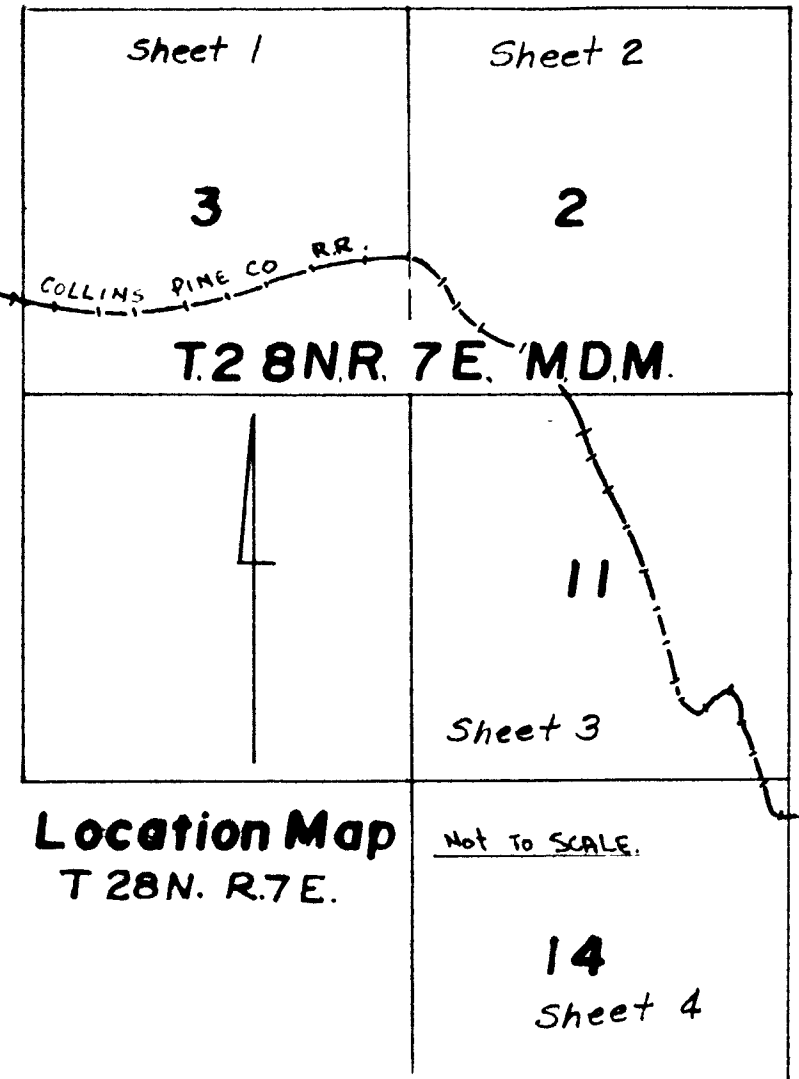

NOTE:

Figures in (parenthesis) are from the Original deed, Vol. 77, page 344, dated Sept 16, 1941.

Red River Lumber Co.
to
Grand Ronde Pine Co.

Figures in [brackets] are from a revised description of the original deed. (Unrecorded)

The purpose of this Survey is to Monument the existing right-of-way "as now located and constructed." (Deeds 77 Page 344)

County Surveyor's Certificate

This map has been examined for conformance with the requirements of the Land Surveyors Act this 7th day of May 1974

Loren J. Sargent
COUNTY SURVEYOR

Surveyor's Certificate

This map correctly represents a Survey made by me or under my direction in conformance with the requirements of the Land Surveyors Act in May 1973 at the request of Waller Reed

Loren J. Sargent
LOREN J. SARGENT L.S. 2322

Recorder's Certificate # 5271

Filed this 2nd day of May 1974 at 2:40 P.M.

In Book 4 of Record of Deeds at the request of *County Engineer*

Prossy Neen Marley by *Frank A. ...* Deputy
Fec #1100 COUNTY RECORDER

AMENDING SURVEY MAP TO AMEND THE TITLE OF A MAP RECORDED IN BOOK 4 OF RECORD OF SURVEYS AT PAGES 43-46

A RECORD OF SURVEY TO MARK THE RIGHT-OF-WAY OF A PORTION OF THE ALMANOR RAILROAD IN SECTIONS 2, 3, 11, 13, AND 14 T. 28 N. R. 7 E. M.D.M. IN THE UNINCORPORATED TERRITORY OF PLUMAS COUNTY, CALIF.

APRIL, 1974
LOREN J. SARGENT, L.S. 2322

SCALE: 1" = 200'

SHEET 1 OF 4 SHEETS