

STATE OF CALIFORNIA  
BUSINESS AND TRANSPORTATION AGENCY  
DEPARTMENT OF TRANSPORTATION

RECORD OF SURVEY  
OF MONUMENTATION

IN PLUMAS COUNTY  
ON ROUTE 89

T.27 N., R.7 E., M.D.M. - SECTIONS 4, 5  
T.28 N., R.6 E., M.D.M. - SECTIONS 13, 24  
T.28 N., R.7 E., M.D.M. - SECTIONS 19, 29, 30, 32

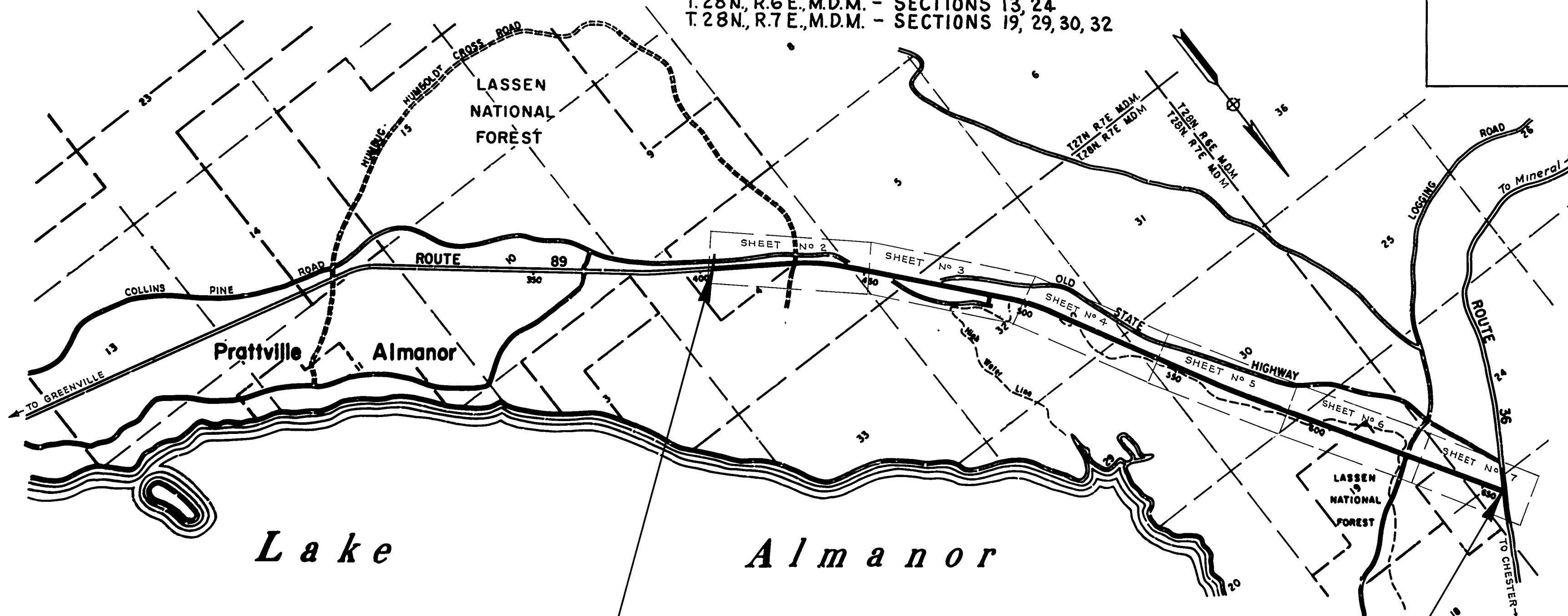
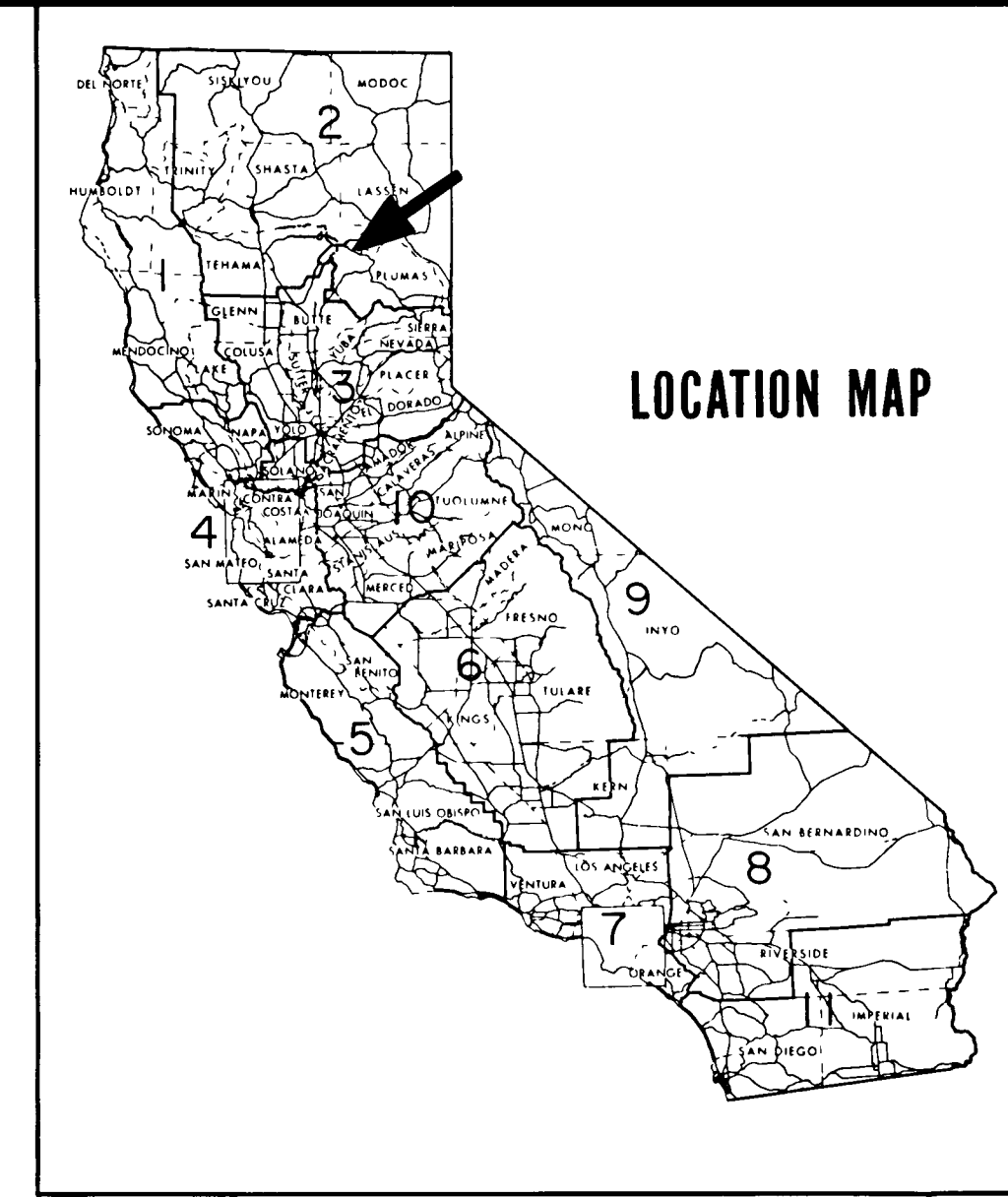

Beginning of Monumentation Project  
Station "D" 404+00 P.O.T.  
P.M. R-37.4

End of Monumentation Project  
Station "D" 657+00.37 P.O.T.  
P.M. R-42.2

SHEET 1 OF 7

SCALE IN FEET

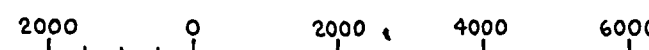

SURVEYOR'S CERTIFICATE  
THIS MAP CORRECTLY REPRESENTS A SURVEY MADE BY ME  
OR UNDER MY DIRECTION IN CONFORMANCE WITH THE  
REQUIREMENTS OF THE LAND SURVEYOR'S ACT AT THE  
REQUEST OF DEPARTMENT OF TRANSPORTATION  
COMPLETED IN NOVEMBER, 1973

*Warren E. Hanson*  
WARREN E. HANSON, R.C.E. 15233  
DISTRICT SURVEYS ENGINEER



COUNTY SURVEYOR'S CERTIFICATE  
THIS MAP HAS BEEN EXAMINED FOR CONFORMANCE WITH THE  
REQUIREMENTS OF THE LAND SURVEYOR'S ACT THIS 4<sup>th</sup>  
DAY OF December, 1973

*Darrell Payne*  
COUNTY SURVEYOR

BY DEPUTY COUNTY SURVEYOR

RECORDER'S CERTIFICATE  
FILED THIS 6<sup>th</sup> DAY OF December, 1973, AT 9:45 A.M.  
IN BOOK 4 OF Rec. Ins. AT PAGE 32639  
AT THE REQUEST OF County Engineer

*Alvin F. New Maskey*  
COUNTY RECORDER

BY DEPUTY COUNTY RECORDER SHEET 1 OF 7