

NOTES

THE BASIS OF BEARING IS THE WEST LINE OF THE EAST 1/2 OF THE WEST 1/2 OF SECTION 19, GIVEN AS N00°07'30"E ON THE FILED MAP OF LAKE ALMANOR PINES SUBDIVISION UNIT NO. TWO.

THE INFORMATION SHOWN ON THIS RECORD OF SURVEY MAP WAS OBTAINED WHILE SURVEYING THE BOUNDARIES OF LAKE ALMANOR PINES SUBDIVISION UNIT NO. TWO AND LAKE ALMANOR COUNTRY CLUB SUBDIVISION UNIT NO. ONE -A.

LEGEND

EXISTING 3/4" IRON PIPE MARKED RCE 7294 °
EXISTING CONCRETE MONUMENT MARKED RCE 7294 /

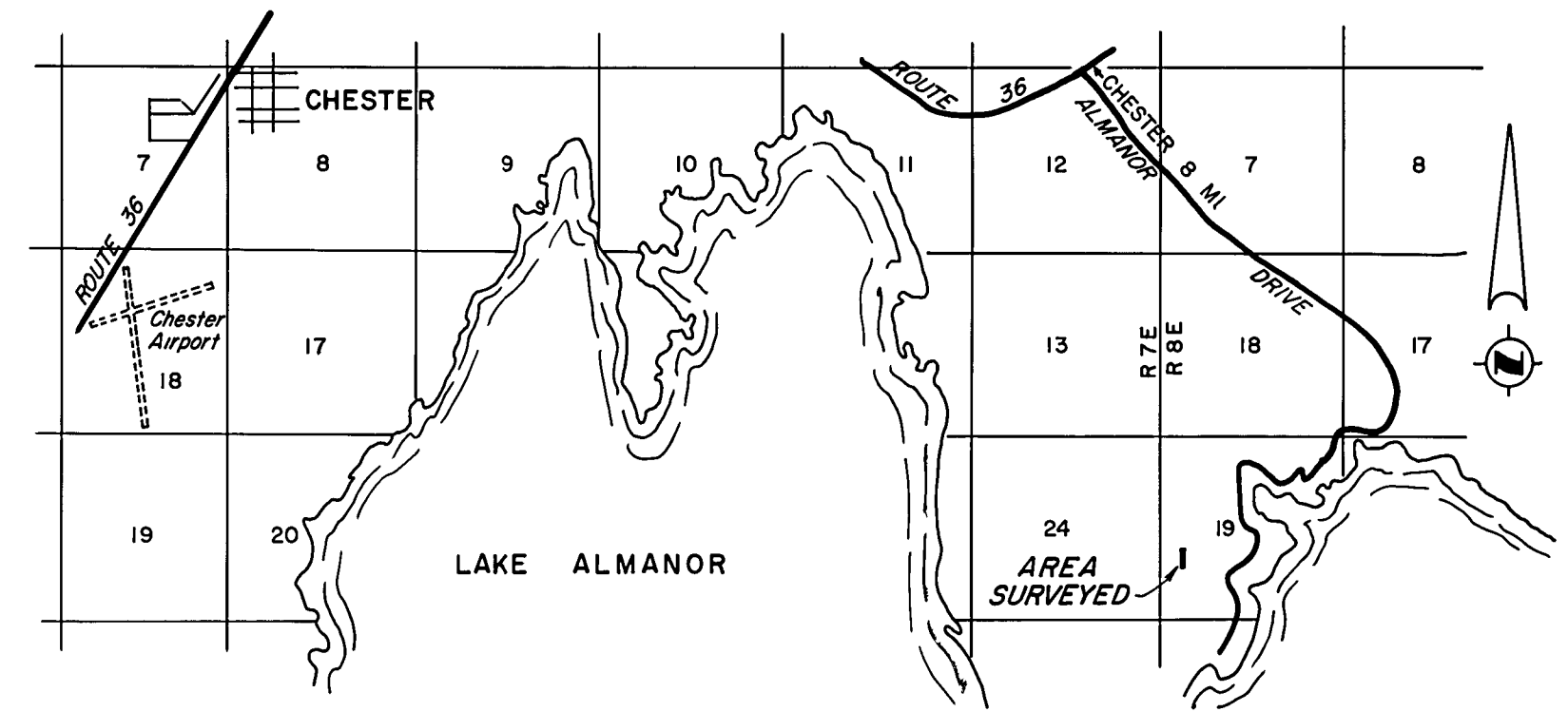

LOCATION MAP

SCALE: 1" = 1 Mile

SURVEYOR'S CERTIFICATE

THIS MAP CORRECTLY REPRESENTS A SURVEY MADE BY ME OR UNDER MY DIRECTION IN CONFORMANCE WITH THE REQUIREMENTS OF THE LAND SURVEYOR'S ACT AT THE REQUEST OF MR. EDWARD CARR FROM OCTOBER, 1965, THROUGH FEBRUARY, 1966. THIS RECORD OF SURVEY IS EXCLUDED FROM THE SUBDIVISION MAP ACT BY SECTION 11535, ARTICLE 3, CHAPTER 2, OF THE BUSINESS AND PROFESSIONAL CODE.

Edward P. Norris
EDWARD P. NORRIS, L.S. 2846

COUNTY ENGINEER'S CERTIFICATE

THIS MAP HAS BEEN EXAMINED FOR CONFORMANCE WITH THE REQUIREMENTS OF THE LAND SURVEYOR'S ACT THIS 20th DAY OF DECEMBER, 1967.

Lawrence J. Brock
LAWRENCE J. BROCK, R.C.E. 13528

RECORDER'S CERTIFICATE

FILED FOR RECORD THIS 22nd DAY OF December, 1967,
AT 3:15 P.M. IN BOOK 9 OF RECORD OF SURVEYS AT PAGE 107
AT THE REQUEST OF WALTER B. GRIMES
RECORDING NO. 2687

FEE 5.00

John Hogan Jonvold
COUNTY RECORDER

BY _____
DEPUTY

RECORD OF SURVEY MAP
A PORTION OF THE S.W. 1/4 OF
SECTION 19, T.28N., R.8 E., M.D.B.&M.
PLUMAS COUNTY, CALIFORNIA

SURVEY OF THE LANDS OF
MR. EDWARD CARR

SCALE: 1" = 100' NOVEMBER, 1967

G WALTER B. **A**
RIMES ASSOC.
CIVIL ENGINEERS & LAND SURVEYORS
1356 MANGROVE AVENUE, CHICO, CALIFORNIA