

**OWNER'S STATEMENT**

We Robert E. Blount and Jean Stelle Blount, having record title interest in the subdivided lands do hereby consent to the preparation and recordation of this map. We are the only persons whose consent is required to pass title to said lands.

Dated DEC. 4, 2008

Robert E. Blount  
Robert E. Blount

Jean Stelle Blount  
Jean Stelle Blount

State of California  
County of NEVADA

On DEC 4, 2008 before me, DONALD PAULI - Notary Public, personally appeared ROBERT E. BLOUNT & JEAN STELLE BLOUNT

JEAN STELLE BLOUNT, who proved to me on the basis of satisfactory evidence to be the persons whose names are subscribed to the within instrument and acknowledged to me that they executed the same in their authorized capacity, and that by their signatures on the instrument the persons, or the entity upon behalf of which the persons acted, executed the instrument.

I certify under PENALTY OF PERJURY under the laws of the State of California that the foregoing paragraph is true and correct.

WITNESS my hand and official seal.

Signature Robert E. Blount

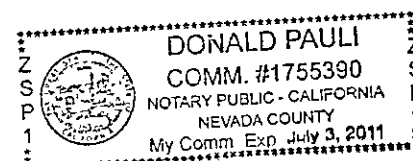
**PLANNED DEVELOPMENT STATEMENT**

The property shown hereon is subject to a Planned Development Permit which is recorded as Document No. 2008-0009257 of Official Records. Future development of this property will be subject to the conditions of said permit.

**COUNTY TAX COLLECTOR'S CERTIFICATE**

I, Ginny Dunbar, Tax Collector of the County of Plumas, State of California, do hereby certify that there are no tax liens against the parcels shown hereon for unpaid state, county, municipal or local taxes or special assessments collected as taxes, except taxes or assessments not yet payable. Taxes or assessments which are a lien but not yet payable are estimated to be in the amount of \$0.

Dated: 12/8/08

Ginny Dunbar  
Ginny Dunbar  
Plumas County Tax Collector

**COUNTY RECORDER'S CERTIFICATE**

Filed this 22 day of December, 2008 at 9:44 A.M. in Book 12 of Parcel Maps, at page 103-105 at the request of the County Surveyor.

Fee \$12.00

Document No. 2008-0009257 By Daura Davis  
Deputy

Kathleen Williams  
County Recorder

**COUNTY SURVEYOR'S STATEMENT**

I have examined this map and find it is substantially the same as it appeared on the tentative map and any approved alterations thereof. All provisions of the Subdivision Map Act and any local ordinances applicable at the time of approval of the tentative map have been complied with and I am satisfied that the map is technically correct.

Dated: 12/8/2008

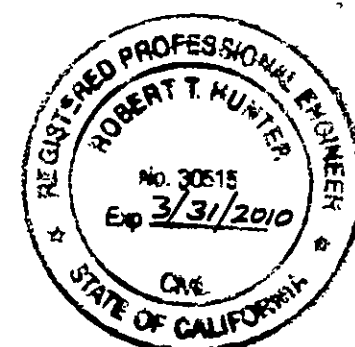

Robert T. Hunter  
Plumas County Surveyor  
License Expires 3/31/2010  
RCE 30515  
Robert T. Hunter

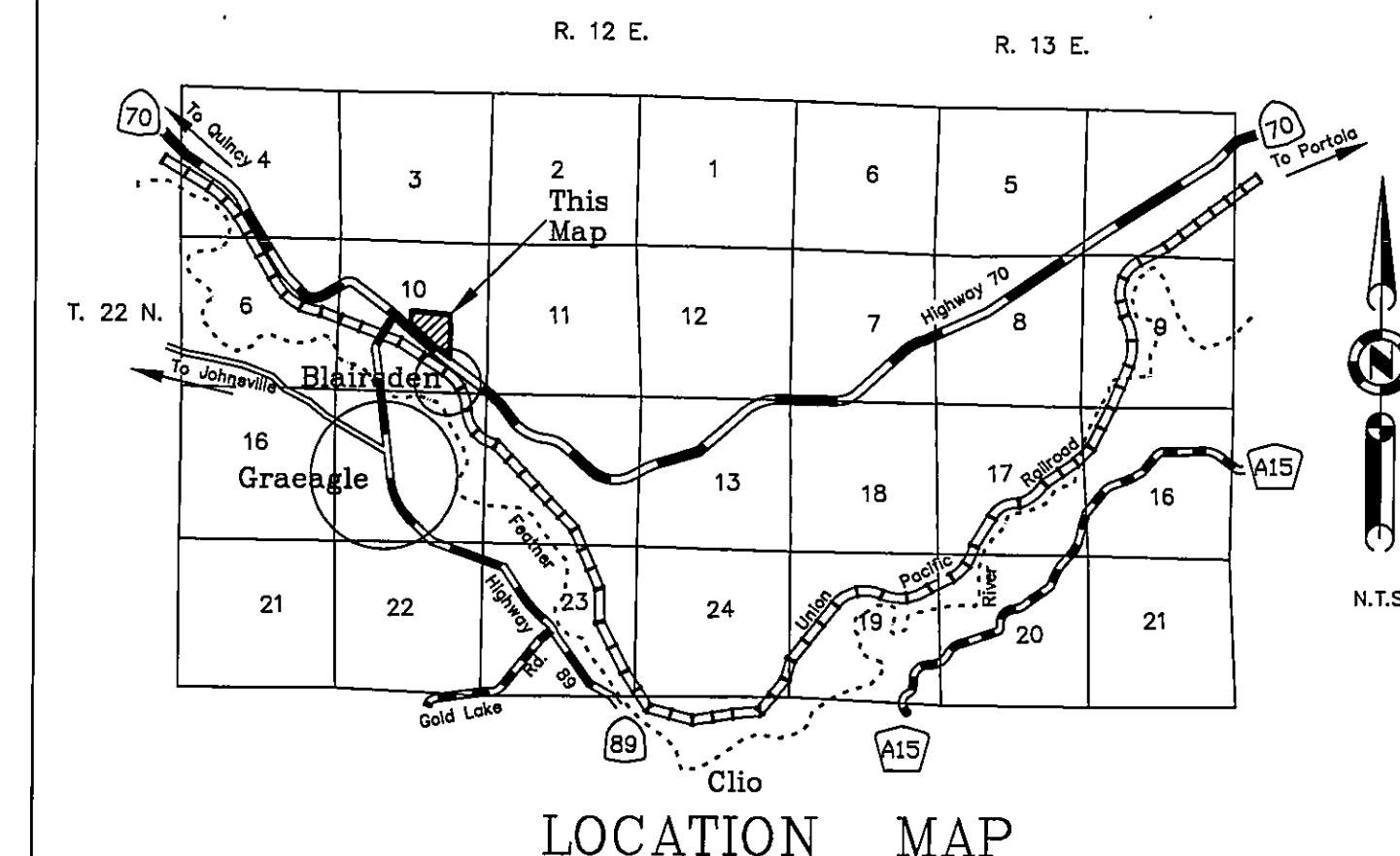
**SURVEYOR'S STATEMENT**

This map was prepared by me or under my direction and is based upon a field survey and was compiled from record data in conformance with the requirements of the Subdivision Map Act and local ordinance at the request of Robert E. Blount and Jean Stelle Blount in August, 2008. All the monuments shown hereon are of the character and occupy the positions indicated and are sufficient to enable the survey to be retraced. I hereby state that this parcel map substantially conforms to the approved or conditionally approved tentative map, if any.

John L. Owen  
John L. Owen L.S. 5620  
License Exp. Date 9-30-10

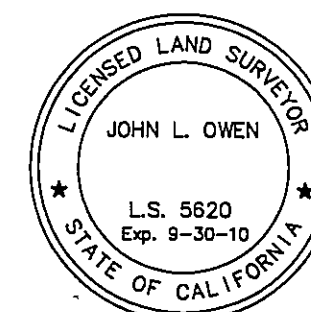

Parcel Map and Planned Development  
for  
Robert E. Blount & Jean Stelle Blount  
Parcel 10, 4 PM 95 and a  
portion of Section 10  
T. 22 N., R. 12 E., M.D.M.  
Plumas County, California  
Scale 1"=100' August, 2008

Hamby Surveying Inc.  
P.O. Box 1209  
Portola, CA 96122  
(530) 832-5571

Sheet 1 of 3