

## County Tax Collector's Certificate

I, Ginny Dunbar, Tax Collector of the County of Plumas, State of California, do hereby certify that there are no tax liens against the Parcels, as shown hereon, for unpaid state, county, municipal, or local taxes or special assessments which are a lien but not yet payable, are estimated to be in the amount of \$ N/A.

Dated: 11/28/06

Ginny Dunbar by Debra I. Bryant Grant ASST. TIC  
Ginny Dunbar  
Plumas County Tax Collector

## County Recorder's Certificate

Filed this 4<sup>th</sup> day of December 2006 at 1:01 p.m. in Book 12 of Parcel Maps, at page, 52-55 at the request of the County Surveyor.

Kathleen Williams  
County Recorder

Fee: 14.00

By: Sue A. Perry  
Deputy

Document No. 2006-0016739

## Surveyor's Statement

This map was prepared by me or under my direction and is based upon a field survey in conformance with the requirements of the Subdivision Map Act and Local Ordinances at the request of E. Daniel Leonhardt and Jesse Segura in November of 2006. All the monuments shown hereon are of the character and occupy the positions indicated and are sufficient to enable the survey to be retraced. I hereby state that this parcel map substantially conforms to the approved or conditionally approved tentative map, if any.

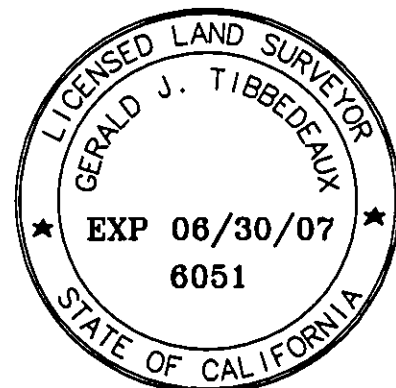

Gerald J. Tibbedeaux  
Gerald Joseph Tibbedeaux  
P.L.S. 6051  
License Exp. Date 6-30-07

## Planned Development Statement

The property shown hereon is subject to a Planned Development Permit which is recorded in Document No. 2006-0008890. Future development of this property will be subject to the conditions of said permit.

## Private Road Statement/Road Maintenance Agreement

The road shown hereon (Easement B, Document # 2006-0010740) is a private road and public utility easement not subject to improvement or maintenance by Plumas County. Such easement will not become effective unless and until reservations and grants are included in the respective deeds.

## Owner's Statement

We, E. Daniel Leonhardt and Jesse Segura, having record title interest in the subdivided lands do hereby consent to the preparation and recordation of this map. We are the only persons whose consent is required to pass title to said lands. We do hereby offer for dedication Easement A shown hereon as a 20 foot wide public utility easement and Easement B as a 60 foot wide private road and public utility easement.

Dated: 11-28-06

E. Daniel Leonhardt  
E. Daniel Leonhardt  
Jesse Segura  
Jesse Segura

## Notary

State of CALIF  
County of PLUMAS

On 11-28-06 before me S. Paulsen personally appeared E. Daniel Leonhardt and Jesse Segura personally known to me or proved on the basis of satisfactory evidence to be the persons whose names are subscribed to the within instrument and acknowledged to me that they executed the same in their authorized capacity, and that by their signatures on the instrument, the persons or entity upon behalf of which the persons acted, executed the instrument.

Witness my Hand and Official Seal.

S. Paulsen  
Signature of Notary

My Commission Expires 7-2-07  
COMM # 1428311

## Trustee's Certificate

CALIFORNIA TRUST COMPANY a California corporation as trustees under a Deed of Trust dated 9/28/2005 and Recorded in Document # 2005-10542 do hereby consent to the preparation and recording of this map. We hereby consent to the dedication of Easement B.

Dated: 11-28-06 Signature(s): DAN, PRES.

## Notary

State of CALIF  
County of PLUMAS

On 11-28-06 before me S. Paulsen personally appeared David D. Winkle personally known to me or proved on the basis of satisfactory evidence to be the persons whose names are subscribed to the within instrument and acknowledged to me that they executed the same in their authorized capacity, and that by their signatures on the instrument, the persons or entity upon behalf of which the persons acted, executed the instrument.

Witness my Hand and Official Seal.

S. Paulsen  
Signature of Notary

My Commission Expires 7-2-07  
COMM # 1428311

## LOCATION MAP - NOT TO SCALE

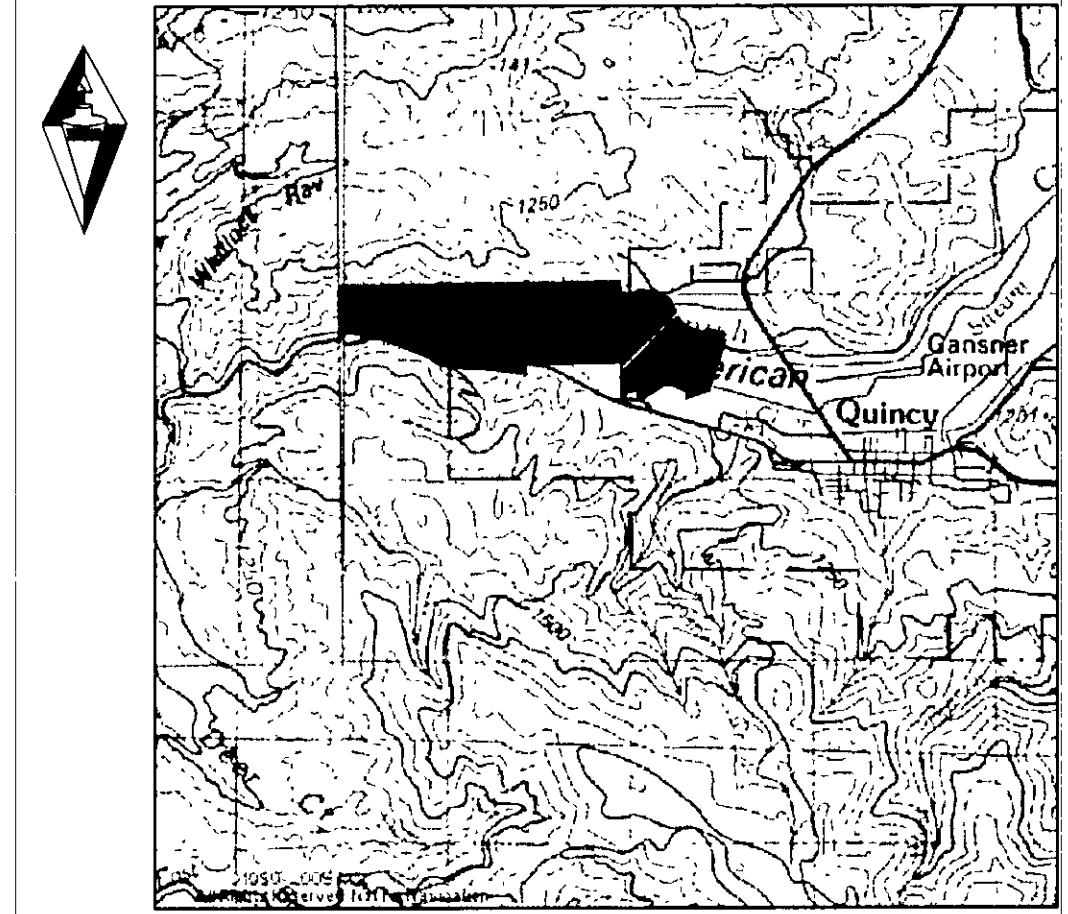

## County Surveyor's Statement

I have examined this map and find it is substantially the same as it appeared on the tentative map and any approved alterations thereof. All provisions of the Subdivision Map Act and any local ordinances applicable at the time of approval of the tentative map have been compiled with and I am satisfied that the map is technically correct. The offers of dedication for public utility easements as shown upon this map are accepted for the uses as noted.

Date: 12/3/06

R. Tom Hunter  
Robert T. Hunter RCE 30515  
Plumas County Surveyor  
Expiration Date 3/31/08



PARCEL MAP PHASE 1  
AND PLANNED UNIT AND PHASED DEVELOPMENT  
FOR  
E. DANIEL LEONHARDT AND JESSE SEGURA

WITHIN SECTION 16 & 17, TOWNSHIP 24 NORTH, RANGE 9 EAST, MOUNT DIABLO MERIDIAN.

A DIVISION OF PARCEL 4, DESCRIBED IN DOCUMENT #2005-0010541, PLUMAS COUNTY RECORDS.

## PLUMAS COUNTY CALIFORNIA

NOVEMBER, 2006

Tibbedeaux Surveying  
PO Box 1960 - 565 Ridge Street  
Portola, CA 96122  
(530) 832-5772

SHEET 1 OF 4