

CONCURRENT MAP OWNERSHIP STATEMENT

A Certificate of Ownership is on file with the County Recorder as Document # 2010-0006432 of Official Records. The certificate was signed by Kenneth Henrici, Dawn Henton and Patricia Henrici and states that he consents to the preparation and recording of this map and he is the only person whose consent is required to pass title to said land.

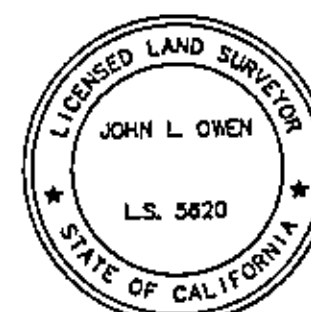

9-29-10

SURVEYOR'S STATEMENT

This map was prepared by me or under my direction and is based upon a field survey in conformance with the requirements of the Subdivision Map Act and Local Ordinances at the request of Dawn Henton in August 2010. All the monuments shown hereon are of the character and occupy the positions indicated and are sufficient to enable the survey to be retraced. I hereby state that this parcel map substantially conforms to the approved or conditionally approved tentative map, if any.

John L. Owen
John L. Owen, L.S. 5620

COUNTY TAX COLLECTOR'S STATEMENT

I, Susan Bryant Grant, Tax Collector of the County of Plumas, State of California, do hereby certify that there are no tax liens against the parcels, as shown hereon for unpaid state, county, municipal or local taxes or special assessments collected as taxes, except taxes or assessments not yet payable. Taxes or assessments which are a lien but not yet payable are estimated to be in the amount of \$ 0.

Dated: 10/20/10

Susan T. Bryant-Grant
Susan Bryant Grant
Plumas County Tax Collector

COUNTY RECORDER'S STATEMENT

Filed this 21st day of October, 2010, at 2:20 p.m.
in Book 12 of Parcel Maps, at page, 133-135 at the request of
the County Surveyor.

Kathleen Williams
County Recorder

Fee: \$12.00Document No. 2010-0006431

By: Daura L. Foster
Deputy

Road Maintenance Statement

The road shown hereon is subject to a Road Maintenance Agreement which is recorded as Document No. 2010-0006433, of Official Records.

Private Road Statement

The road shown hereon as Rebecca Lane is a private easement not subject to improvement or maintenance by Plumas County. Such easement will not become effective unless and until reservations and grants are included in the respective deeds.

PLANNED Development Permit Statement

The property shown hereon is subject to a Planned Development Permit which is Recorded as Document # 2010-06434. Future development of this property will be subject to the conditions of said permit.

COUNTY SURVEYOR'S STATEMENT

I have examined this map and find it is substantially the same as it appeared on the tentative map and any approved alterations thereof. All provisions of the Subdivision Map Act and any local ordinances applicable at the time of approval of the tentative map have been complied with and I am satisfied that the map is technically correct.

Dated: 10/18/2010

Robert T. Hunter
Robert T. Hunter R.C.E. 30515
Plumas County Surveyor

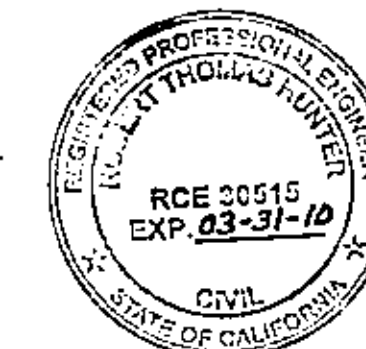

Parcel Map
for

Kenneth Henrici, Dawn Henton
and Patricia Henrici

Document # 2008-1057

Northeast 1/4 of the Southeast 1/4
of Section 28 and a portion of Parcel 2
as shown in Book 5 of Parcel Maps, Page 4
Southeast of the centerline of Butterfly Creek
Township 25 North, Range 9 East, M.D.M.

Plumas County ~ California

Scale 1" = 200' April, 2010

Hamby Surveying Inc.
P.O. Box 1209
Portola, CA 96122
(530) 832-5571

SHEET 1 OF 3