

**COUNTY TAX COLLECTOR'S STATEMENT**

I, Ginny Dunbar, Tax Collector of the County of Plumas, State of California, do hereby certify that there are no tax liens against the parcels shown hereon for unpaid state, county, municipal or local taxes of special assessments collected as taxes, except taxes or assessments not yet payable. Taxes or assessments which are a lien but not yet payable are estimated to be in the amount of 1,244.44.

Dated 3/5/03 by Antia Stringfellow, Asst  
Ginny Dunbar  
Plumas County Tax Collector

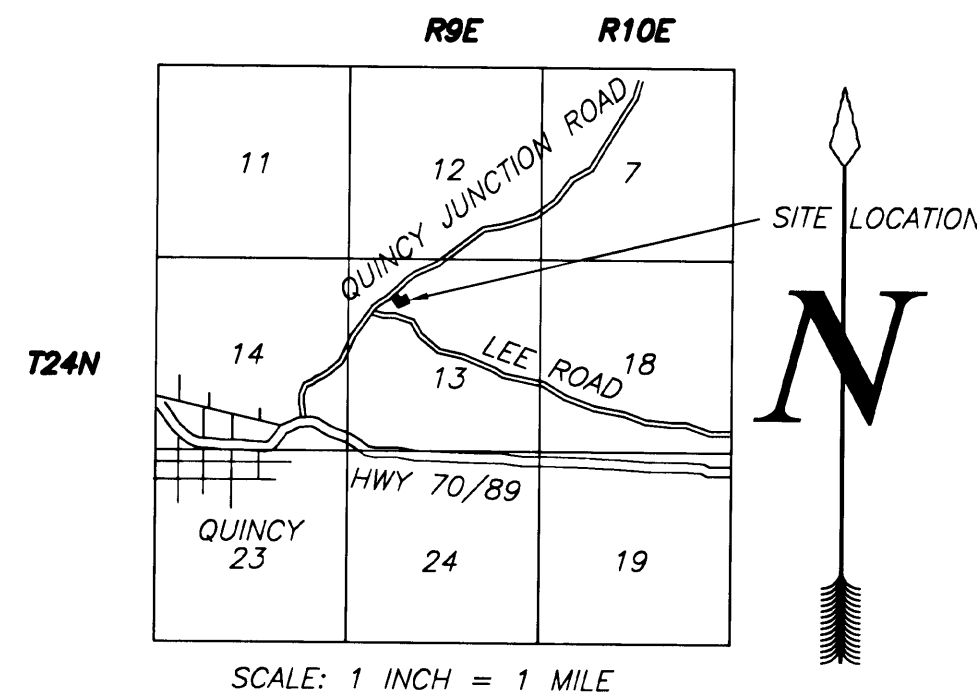

SCALE: 1 INCH = 1 MILE

**OWNER'S STATEMENT**

A Certificate of ownership is on file with the County Recorder as Document No. 2003-2434. The certificate was signed by Donald C. Nelson and Joseph Shramek and states that they consented to the preparation and recording of this map, that they are the only persons whose consent is required to pass title to said land.

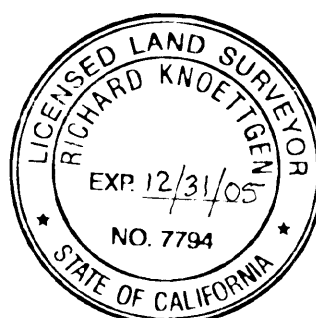

**SURVEYOR'S STATEMENT**

This map was prepared by me or under my direction and is based upon a field survey in conformance with the requirements of the Subdivision Map Act and local ordinance at the request of Gregory Kinne on July 12, 2002. All monuments shown hereon are of the character and occupy the positions indicated and are sufficient to enable the survey to be retraced. I hereby state that this parcel map substantially conforms to the approved or conditionally approved tentative map, if any.

Richard Knoettgen  
RICHARD KNOETTGEN LICENSE NUMBER L 7794



**COUNTY SURVEYOR'S STATEMENT**

I have examined this map and find that it is substantially the same as it appeared on the tentative map and any approved alterations thereof. All provisions of the Subdivision Map Act and any local ordinance applicable at the time of approval of the tentative map have been complied with and I am satisfied that the map is technically correct.

Dated 3/4/03 by R. Tom Hunter  
R. Tom Hunter R.C.E. 30515  
Plumas County Surveyor  
License Exp. Date 03/31/04

**COUNTY RECORDER'S STATEMENT**

Filed this 5th day of March, 2003 at 3:35 P.m.  
in Book 11 of Parcel Maps, at page 118-119,  
at the request of the County Surveyor.

Fee: \$ 10.00  
File No: 2003-2435  
Kathleen Williams  
County Recorder  
By: [Signature]  
Deputy

**PARCEL MAP**

FOR  
DONALD C. NELSON AND JOSEPH SHRAMEK  
A DIVISION OF PARCEL 4, 9 PM 49  
T24N R9E S13 MDM  
PLUMAS COUNTY, CALIFORNIA

KNOETTGEN LAND SURVEYING  
PO BOX 312 QUINCY CALIFORNIA 95971  
(530) 283-4418

SEPTEMBER 2002

SHEET 1 OF 2