

OWNERS STATEMENT
I, RANDAL E. BARLOW, HAVING RECORD TITLE INTEREST IN THE HEREON SUBDIVIDED LANDS DO HEREBY CONSENT TO THE PREPARATION AND RECORDATION OF THIS MAP. I DO HEREBY OFFER FOR DEDICATION THE 30 FOOT PUBLIC UTILITY EASEMENT AS SHOWN.

DATED: 18 JUNE 2001
[Signature]
RANDAL E. BARLOW

NOTARY

STATE OF CALIFORNIA
COUNTY OF PLUMAS

ON June 18, 2001 BEFORE ME *Cynthia L. Stockton* PERSONALLY APPEARED RANDAL E. BARLOW, PERSONALLY KNOWN TO ME OR PROVED ON THE BASIS OF SATISFACTORY EVIDENCE TO BE THE PERSON WHOSE NAME IS SUBSCRIBED TO THE WITHIN INSTRUMENT AND ACKNOWLEDGED TO ME THAT HE EXECUTED THE SAME IN HIS AUTHORIZED CAPACITY, AND THAT BY HIS SIGNATURE ON THE INSTRUMENT THE PERSONS OR ENTITY UPON BEHALF OF WHICH THE PERSON ACTED, EXECUTED THE INSTRUMENT. WITNESS MY HAND AND OFFICIAL SEAL.

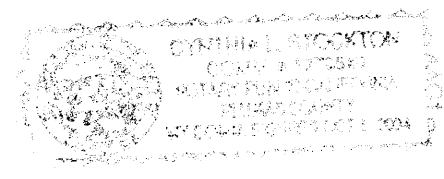

Cynthia L. Stockton
SIGNATURE OF NOTARY
MY COMMISSION EXPIRES

TRUSTEE'S CERTIFICATE

AS TRUSTEE UNDER A DEED OF TRUST DATED JANUARY 28, 2000 AND RECORDED IN BOOK 798 OF OFFICIAL RECORDS, AT PAGE 681 DOES HEREBY CONSENT TO THE PREPARATION AND RECORDING OF THIS PARCEL MAP FOR RANDAL E. BARLOW, WE CONSENT TO THE DEDICATION OF OR GRANTING OF THE 30 FOOT WIDE PUBLIC UTILITY EASEMENT SHOWN HEREON.

DATED: 6-18-2001
[Signature]
S Paulsen
ASST SEC.

NOTARY

STATE OF CALIFORNIA
COUNTY OF PLUMAS

ON June 18, 2001 BEFORE ME *Cynthia L. Stockton* PERSONALLY APPEARED *Steve Paulsen* PERSONALLY KNOWN TO ME OR PROVED ON THE BASIS OF SATISFACTORY EVIDENCE TO BE THE PERSON WHOSE NAME IS SUBSCRIBED TO THE WITHIN INSTRUMENT AND ACKNOWLEDGED TO ME THAT HE EXECUTED THE SAME IN HIS AUTHORIZED CAPACITY, AND THAT BY HIS SIGNATURE ON THE INSTRUMENT THE PERSONS OR ENTITY UPON BEHALF OF WHICH THE PERSON ACTED, EXECUTED THE INSTRUMENT. WITNESS MY HAND AND OFFICIAL SEAL.

Cynthia L. Stockton
SIGNATURE OF NOTARY
MY COMMISSION EXPIRES

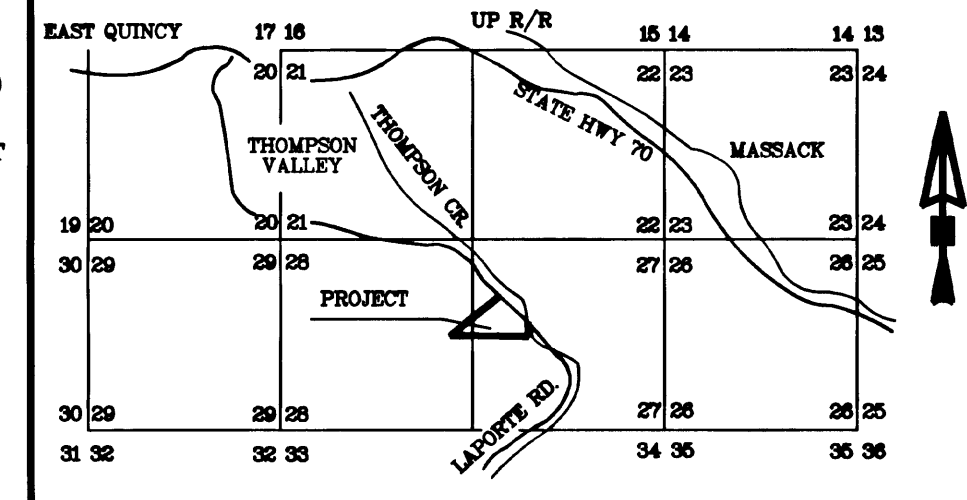

LOCATION MAP (NOT TO SCALE)
T. 24N., R. 10E., M.D.M.

BASIS OF BEARINGS

THE NORTHEASTERLY SIDELINE OF COUNTY ROAD No. 511 (QUINCY - LAPORTE ROAD), FROM THE MOST SOUTHERLY CORNER OF PARCEL 21 TO THE BEGINNING OF CURVE IN PARCEL 22, SHOWN AS N 48°-02'-18" W IN BOOK 7 OF PARCEL MAPS AT PAGE 38, PLUMAS COUNTY RECORDS, IS THE BASIS OF BEARINGS SHOWN ON THIS MAP.

LEGEND

- FOUND 3/4 INCH IRON PIPE AND CAP MARKED L.S. 3202 / OR AS NOTED + COMPUTED LOCATION NOTHING FOUND OR SET
- FOUND 1/2 INCH IRON PIPE AND TAG MARKED R.C.E. 13528 (A) RECORD INFORMATION PER BOOK 7 OF PARCEL MAPS, PAGE 38
- SET 1/2 INCH REBAR AND CAP MARKED P.L.S. 6051 [No.] KEY TO CORNER NOTES

CORNER NOTES

- [1] FOUND 3/4" IP AND CAP L.S. 3202 DISTURBED, REPLACED WITH 1/2" REBAR AND CAP P.L.S. 6051
- [2] FOUND 3/4" IP AND CAP L.S. 3202 DISTURBED, REPLACED WITH 1/2" REBAR AND CAP P.L.S. 6051
- [3] SET 1/2" REBAR AND CAP P.L.S. 6051 AT THE SE. COR. OF THE SW. 1/4 OF THE NW. 1/4 SEC. 27 FROM WHICH FOUND:
1 INCH IP & CAP L.S. 3202, S 74-20-48 W A DISTANCE OF 7.28 FEET
BT 11 INCH CEDAR WITH BLAZE S 35-46 E A DISTANCE OF 18.2 FEET
BT 28 INCH FIR WITH BLAZE S 27-08 W A DISTANCE OF 22.3 FEET
- [4] FOUND B.L.M. BRASS CAP MARKED FOR THE S. 1/4 CORNER OF SECTION 27, DATE 1971 FROM WHICH FOUND:
BT 24 INCH CEDAR N 14 W A DISTANCE OF 7.3 FEET
BT 10 INCH FIR N 59 E A DISTANCE OF 7.3 FEET
BT 24 INCH CEDAR S 2 E A DISTANCE OF 29.7 FEET
- [5] FOUND 1 INCH IRON PIPE AND CAP LS 3202 FROM WHICH FOUND:
BT 30" FIR WITH BLAZE N 03-09 E A DISTANCE OF 36.0 FEET
BT 17" OAK WITH BLAZE N 42-57 E A DISTANCE OF 23.46 FEET
BT 30" FIR STUMP WITH K-TAG S 59-26 W A DISTANCE OF 37.6 FEET
- [6] NOTHING FOUND OR SET FROM WHICH FOUND:
3/4 INCH IRON PIPE AND TAG LS 3202 N 48-02-18 W A DISTANCE OF 0.92 FEET

NOTE

THE 20' P.U.E.'S SHOWN ON 7 P.M. 39 THAT ARE ADJACENT TO THE SOUTHERLY AND EASTERLY BOUNDARY OF PARCEL 20 ARE ABANDONED BY THE FILING OF THIS MAP. (68445 (J) G. C.)

DATED: 6/22/01

R Tom Hunter
R TOM HUNTER
DESIGNER

PARCEL 2
13.14 Ac.

PARCEL 1
7.15 Ac.

5 FOOT WIDE ROAD & UTILITY EASEMENT (471 O.R. 103)

NOTE
THE 20 FOOT WIDE EASEMENT ALONG THOMPSON CREEK FOR MAINTENANCE OF A DIVERSION AND DITCH, INCLUDING INGRESS THERETO AND EGRESS THEREFROM IS RECORDED IN BOOK 411 OF OFFICIAL RECORDS AT PAGE 287.

COUNTY RECORDER'S STATEMENT

FILED THIS 22nd DAY OF June, 2001 AT 1:30 PM IN BOOK 11 OF PARCEL MAPS AT PAGE 102-193 AT THE REQUEST OF THE COUNTY SURVEYOR.

JUDITH WELLS
COUNTY RECORDER

BY: *[Signature]*
DEPUTY

FEE \$ 10.00
FILE No. 2001-04879

COUNTY TAX COLLECTOR'S CERTIFICATE

I, BARBARA J. COATES, TAX COLLECTOR OF THE COUNTY OF PLUMAS, STATE OF CALIFORNIA, DO HEREBY CERTIFY THAT THERE ARE NO TAX LIENS AGAINST THE PARCELS AS SHOWN HEREON, FOR UNPAID STATE COUNTY, MUNICIPAL, OR LOCAL TAXES OR SPECIAL ASSESSMENTS COLLECTED AS TAXES, EXCEPT TAXES OR ASSESSMENTS NOT YET PAYABLE. TAXES OR ASSESSMENTS WHICH ARE A LIEN BUT NOT YET PAYABLE, ARE ESTIMATED TO BE IN THE AMOUNT OF \$ 751.50

DATED: 6-18-01

Barbara J. Coates
Barbara J. Coates
BARBARA J. COATES
PLUMAS COUNTY TAX COLLECTOR

COUNTY SURVEYOR'S STATEMENT

I HAVE EXAMINED THIS MAP AND FIND IT IS SUBSTANTIALLY THE SAME AS IT APPEARED ON THE TENTATIVE MAP AND ANY APPROVED ALTERATIONS THEREOF. ALL PROVISIONS OF THE SUBDIVISION MAP ACT AND ANY LOCAL ORDINANCE APPLICABLE AT THE TIME OF APPROVAL OF THE TENTATIVE MAP HAVE BEEN COMPLIED WITH AND I AM SATISFIED THAT THE MAP IS TECHNICALLY CORRECT. THE OFFER OF DEDICATION OF THE 30 FOOT WIDE PUBLIC UTILITY EASEMENT (P.U.E.) IS ACCEPTED FOR THE USES NOTED.

DATED: 6/22/01

R Tom Hunter
R TOM HUNTER, R.C.E. 30515
PLUMAS COUNTY SURVEYOR
LICENSE EXPIRES 03/31/04



SURVEYOR'S STATEMENT

THIS MAP WAS PREPARED BY ME OR UNDER MY DIRECTION AND IS BASED ON A FIELD SURVEY IN CONFORMANCE WITH THE REQUIREMENTS OF THE SUBDIVISION MAP ACT AND LOCAL ORDINANCE AT THE REQUEST OF RANDAL E. BARLOW IN MAY, 2001. ALL OF THE MONUMENTS SHOWN HEREON ARE OF THE CHARACTER AND OCCUPY THE POSITIONS INDICATED AND ARE SUFFICIENT TO ENABLE THE SURVEY TO BE RETRACED. I HEREBY STATE THAT THIS PARCEL MAP SUBSTANTIALLY CONFORMS TO THE APPROVED OR CONDITIONALLY APPROVED TENTATIVE MAP, IF ANY.

Gerald J. Tibbodeaux
GERALD JOSEPH TIBBODEAUX
P.L.S. 6051
LICENSE EXPIRES 6/30/01

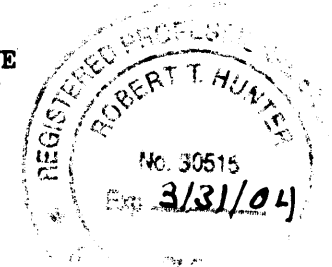

PARCEL MAP AND PLANNED DEVELOPMENT FOR

RANDAL E. BARLOW
A DIVISION OF PARCEL 20, BOOK 7 OF PARCEL MAPS, PAGE 38
WITHIN SECTIONS 27 & 28, T. 24N., R. 10E., MDM
PLUMAS COUNTY CALIFORNIA
DECEMBER 2000
SCALE 1 INCH = 100 FEET

Tibbodeaux Surveying
P.O. Box 1960 - 565 Ridge St.
Portola, CA 96122
(530) 832-5772

D:\00-34RB\00-34-3

SHEET 1 OF 2