

COUNTY TAX COLLECTOR'S STATEMENT

I, Barbara J Coates, Tax Collector of the County of Plumas, State of California, do hereby certify that there are no tax liens against the parcels shown hereon for unpaid state, county, municipal or local taxes or special assessments collected as taxes, except taxes or assessments not yet payable. Taxes or assessments which are a lien but not yet payable are estimated to be in the amount of 2561.00.

Dated: 9-22-98

Barbara J. Coates By: Minny Dunbar,
Barbara J. Coates, asst.
Plumas County Tax Collector

SURVEYOR'S STATEMENT

This map was prepared by me or under my direction and is based upon a field survey in conformance with the requirements of the Subdivision Map Act and local ordinance at the request of Harold and Marjorie Hacker in December, 1997. All the monuments shown hereon are of the character and occupy the positions indicated and are sufficient to enable the survey to be retraced. I hereby state that this parcel map substantially conforms to the approved or conditionally approved tentative map, if any.

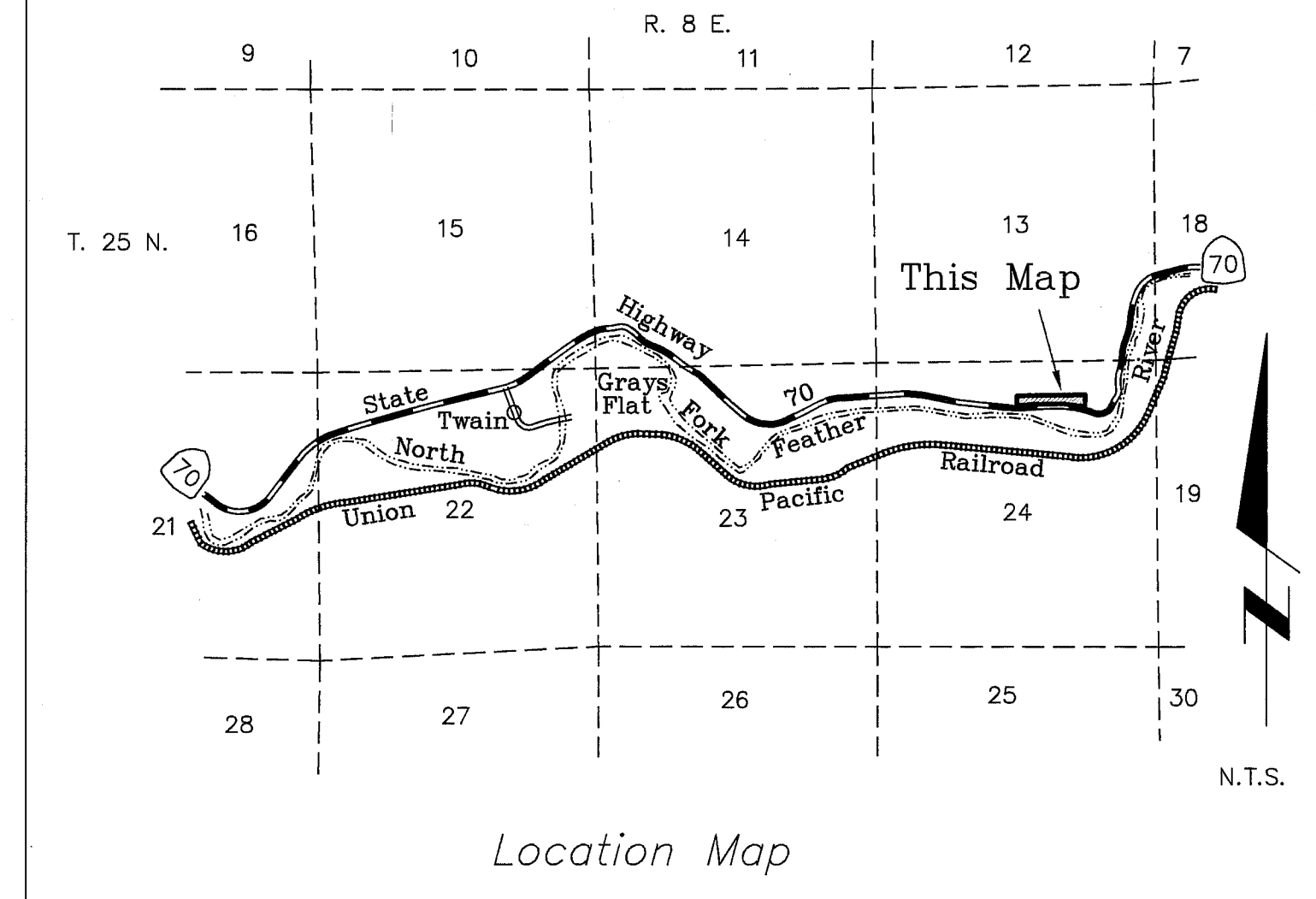

OWNER'S STATEMENT

Certificates of Ownership are on file with the County Recorder in Book 753 of Official Records at pages 283-286. The certificates were signed by Peggy Crowder, Clifton D. Damron, Rodney D. Damron and Jacklyn Pellegrini and states that they consented to the preparation and recording of this map, and that they are the only persons whose consent is required to pass title to said land.

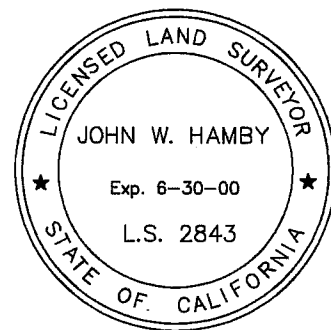

John W. Hamby
John W. Hamby L.S. 2843

COUNTY SURVEYOR'S STATEMENT

This map has been examined by me and I am satisfied that the map is technically correct. I hereby state that the subdivision as shown is substantially the same as it appeared on the tentative map and any approved alterations thereof and that all provisions of Subdivision Map Act and local ordinances applicable at the time of approval of the tentative map have been complied with.

Dated: 9/22/98

R. Tom Hunter
R. Tom Hunter R.C.E. 30515
Plumas County Surveyor
License Expiration Date 3/31/00

COUNTY RECORDER'S STATEMENT

Filed this 22nd day of September 1998, at 2:55 p.m.
in Book 11 of Parcel maps at page, 43-45 at the request of
the County Surveyor

Fee: \$12.00

Judith Wells
County Recorder

File No. 7567

By: Thomas R. Coates
Deputy



Parcel Map
for
Peggy Crowder, Clifton D. Damron,
Rodney D. Damron and Jacklyn Pellegrini

A portion of the NW 1/4 of the NE 1/4 of
Section 24, T. 25 N., R. 8 E., M.D.M.
Plumas County, California
Scale 1"=200' December, 1997

Hamby Surveying Inc.
P.O. Box 1209
Portola, CA 96122
(916) 832-5571