

**COUNTY SURVEYOR'S STATEMENT**

I HAVE EXAMINED THIS MAP AND FIND IT IS SUBSTANTIALLY THE SAME AS IT APPEARED ON THE TENTATIVE MAP AND ANY APPROVED ALTERATIONS THEREOF. ALL PROVISIONS OF THE SUBDIVISION MAP ACT AND ANY LOCAL ORDINANCES APPLICABLE AT THE TIME OF APPROVAL OF THE TENTATIVE MAP HAVE BEEN COMPLIED WITH AND I AM SATISFIED THAT THE MAP IS TECHNICALLY CORRECT.

THE OFFER OF DEDICATION OF CARLOS COURT AND VALLEY VIEW DRIVE FOR PUBLIC ROAD, DRAINAGE AND PUBLIC UTILITY PURPOSES, AS SHOWN ON THE MAP, IS Accepted FOR THE PURPOSES NOTED.

DATED: Sept 10, 1993  
R Tom Hunter  
R. TOM HUNTER, R.C.E. 30515  
PLUMAS COUNTY SURVEYOR  
LICENSE EXP. DATE: 3/31/96

**ENGINEER'S STATEMENT**

THIS MAP WAS PREPARED BY ME OR UNDER MY DIRECTION AND IS BASED UPON A FIELD SURVEY IN CONFORMANCE WITH THE REQUIREMENTS OF THE SUBDIVISION MAP ACT AND LOCAL ORDINANCE AT THE REQUEST OF RANDAL BARLOW IN APRIL 1993. ALL OF THE MONUMENTS SHOWN HEREON ARE OF THE CHARACTER AND OCCUPY THE POSITIONS INDICATED AND ARE SUFFICIENT TO ENABLE THE SURVEY TO BE RETRACED. I HEREBY STATE THAT THIS PARCEL MAP SUBSTANTIALLY CONFORMS TO THE APPROVED OR CONDITIONALLY APPROVED TENTATIVE MAP, IF ANY.

SIGNED: Larry A. Fites  
LARRY A. FITES R.C.E. 13225  
LICENSE EXP. DATE 3/31/97

**COUNTY RECORDER'S STATEMENT**

FILED THIS 7th DAY OF DECEMBER, 1993, AT 11:15 a.m. IN BOOK 10 OF PARCELS MAPS, AT PAGE 89-91, AT THE REQUEST OF THE COUNTY SURVEYOR.

FEE: 9.00  
FILE NO. 9704  
JUDITH WELLS  
COUNTY RECORDER  
BY: Jay A. Sney  
DEPUTY

**COUNTY TAX COLLECTOR'S CERTIFICATE**

I, BARBARA J. COATES, TAX COLLECTOR OF THE COUNTY OF PLUMAS, STATE OF CALIFORNIA, DO HEREBY CERTIFY THAT THERE ARE NO TAX LIENS AGAINST THE PARCELS, AS SHOWN HEREON, FOR UNPAID STATE, COUNTY, MUNICIPAL, OR LOCAL TAXES OR SPECIAL ASSESSMENTS COLLECTED AS TAXES, EXCEPT TAXES OR ASSESSMENTS NOT YET PAYABLE. TAXES OR ASSESSMENTS WHICH ARE A LIEN BUT NOT YET PAYABLE, ARE ESTIMATED TO BE IN THE AMOUNT OF \$ none.

DATED: 11-29-93  
Barbara J. Coates by: Jimmy Dunbar  
BARBARA J. COATES  
PLUMAS COUNTY TAX COLLECTOR

A TRUSTEE'S CERTIFICATE IS ON FILE WITH THE COUNTY RECORDER IN BOOK 616 OF OFFICIAL RECORDS AT PAGE 785.

**OWNER'S STATEMENT**

I HEREBY STATE THAT I AM THE OWNER OF THE LAND SHOWN ON THIS PARCEL MAP AND CONSENT TO THE PREPARATION AND RECORDATION OF THIS MAP, AND THAT I AM THE ONLY PERSON WHOSE CONSENT IS REQUIRED TO PASS CLEAR TITLE TO SAID LANDS.

CARLOS COURT AND VALLEY VIEW DRIVE, AS SHOWN ON THE MAP, ARE HEREBY OFFERED FOR DEDICATION FOR PUBLIC ROAD, DRAINAGE AND PUBLIC UTILITY PURPOSES.

DATED: 9 September 1993  
Randal E. Barlow  
RANDAL E. BARLOW

STATE OF CALIFORNIA  
COUNTY OF PLUMAS

ON SEPT 9, 1993, BEFORE ME LAURIE A. WHITENTON PERSONALLY APPEARED RANDAL E. BARLOW PERSONALLY KNOWN TO ME (OR PROVED TO ME ON THE BASIS OF SATISFACTORY EVIDENCE) TO BE THE PERSON WHOSE NAME IS SUBSCRIBED TO THE WITHIN INSTRUMENT AND ACKNOWLEDGED TO ME THAT HE EXECUTED THE SAME IN HIS AUTHORIZED CAPACITY, AND THAT BY HIS SIGNATURE ON THE INSTRUMENT THE PERSON, OR THE ENTITY UPON BEHALF OF WHICH THE PERSON ACTED, EXECUTED THE INSTRUMENT.

WITNESS MY HAND AND OFFICIAL SEAL.

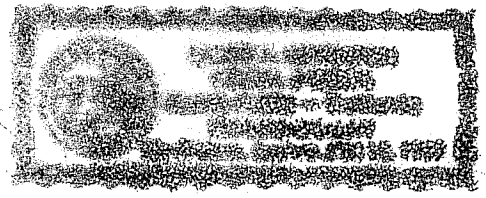
SIGNATURE Laurie A. Whitenton (SEAL)  

**TRUSTEE'S CERTIFICATE**

FIDELITY NATIONAL TITLE INSURANCE COMPANY, A CORPORATION AS TRUSTEE UNDER A DEED OF TRUST DATED JULY 10, 1992, AND RECORDED IN BOOK 577 OF OFFICIAL RECORDS AT PAGE 639, DOES HEREBY CONSENT TO THE PREPARATION AND RECORDING OF THIS MAP AND CONSENT TO THE DEDICATION OF CARLOS COURT AND VALLEY VIEW DRIVE AS A PUBLIC ROAD, DRAINAGE AND PUBLIC UTILITY EASEMENTS, AS SHOWN ON THE MAP, FOR THE PURPOSES NOTED.

DATED: SEPT 9, 93  
BY: S. Paulsen  
S. PAULSEN  
VICE PRESIDENT

STATE OF CALIFORNIA  
COUNTY OF PLUMAS

ON SEPT 9, 1993, BEFORE ME LAURIE A. WHITENTON PERSONALLY APPEARED S. PAULSEN PERSONALLY KNOWN TO ME (OR PROVED TO ME ON THE BASIS OF SATISFACTORY EVIDENCE) TO BE THE PERSON WHOSE NAME IS SUBSCRIBED TO THE WITHIN INSTRUMENT AND ACKNOWLEDGED TO ME THAT HE EXECUTED THE SAME IN HIS AUTHORIZED CAPACITY, AND THAT BY HIS SIGNATURE ON THE INSTRUMENT THE PERSON, OR THE ENTITY UPON BEHALF OF THE WHICH THE PERSON ACTED, EXECUTED THE INSTRUMENT.

WITNESS MY HAND AND OFFICIAL SEAL.

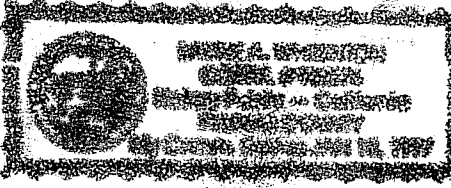
SIGNATURE Laurie A. Whitenton (SEAL)  

**AREA TABULATION**

PARCELS 1 THROUGH 4 . . . . .	19.46 ACRES
PUBLIC ROAD EASEMENT . . . . .	0.60 ACRES
TOTAL . . . . .	20.06 ACRES

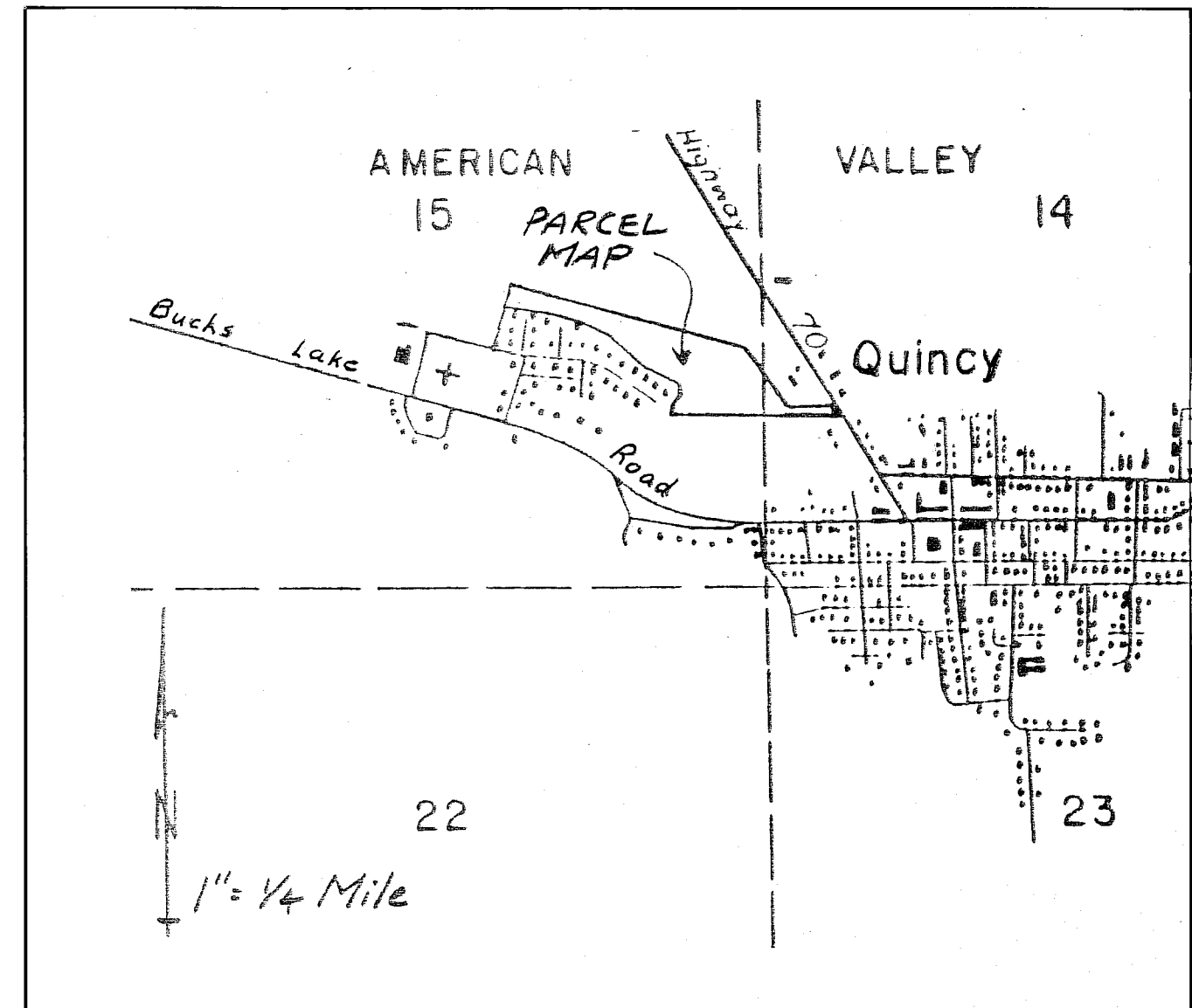

**LOCATION MAP**

**PARCEL MAP**

A PLANNED DEVELOPMENT

FOR

**RANDAL BARLOW**

PORTION OF THE SOUTH 1/2 OF SECTION 15 AND THE SOUTHWEST 1/4 SECTION 14, T. 24 N., R. 9 E., M.D.M. PLUMAS COUNTY, CALIFORNIA.

PREPARED BY:

LARRY FITES ENGINEERING  
P.O. BOX 20308  
GRAEAGLE, CALIFORNIA 96103  
R.C.E. 13225

JUNE 1993 SHEET 1 OF 3