

NORTH  
1" = 100'

BASIS OF BEARINGS Per 7PM38  
(N3°06'52"E 800.00')

PARCEL 1  
14.52 ac. gross  
14.21 ac. net

PARCEL 2  
5.52 ac. gross  
4.81 ac. net.

Abandoned Easement (423 OR 47-64)  
(20' P.U.E. per 7PM38)

EASEMENT DATA

Course	Bearing	Length ft			
A	S52°42'00"E	27.69'	T	N62°03'43"E	213.91'
B	S48°00'00"E	157.75'	U	N62°03'43"E	226.09'
C	S76°00'00"E	217.52'	V	N49°58'48"E	228.16'
D	S57°00'00"E	64.66'	W	N49°58'48"E	177.84'
E	N57°00'00"W	36.30'	X	N3°06'52"E	128.00'
F	N76°00'00"W	222.44'	Y	N63°28'00"E	226.07'
G	N48°00'00"W	170.25'	Z	N55°03'00"E	141.56'
H	N52°42'00"W	52.91'	AA	N69°19'00"E	169.40'
I	S52°42'00"E	40.30'	AB	N48°32'00"E	231.19'
J	S48°00'00"E	164.00'	AC	N12°26'00"E	185.09'
K	S76°00'00"E	219.98'	AD	N13°52'00"E	332.12'
L	S57°00'00"E	50.48'	AE	S61°22'00"E	54.45'
M	N49°58'48"E	62.74'	AF	S70°58'00"E	222.00'
N	N62°03'43"E	66.08'	AG	S66°02'30"E	60.69'
O	N49°58'48"E	540.57'	AH	S67°16'57"E	282.22'
P	N49°58'48"E	1009.43'			
Q	N56°00'00"E	93.44'	AJ	N20°14'30"E	185.36'
R	N56°00'00"E	76.90'	AK	S88°44'30"E	104.30'
S	N56°00'00"E	796.19'	AL	N45°36'00"E	137.12'
			AM	N0°16'00"W	106.52'
			AN	N46°10'00"E	142.68'
			AP	N35°33'00"E	81.55'

LEGEND

- set 1/2 rebar RCE 22836
- ( ) Record per 7PM38 B measured except as noted.
- found 1/2 iron pipe RCE 13528
- pickup box
- found 1/2" iron pipe LS3202

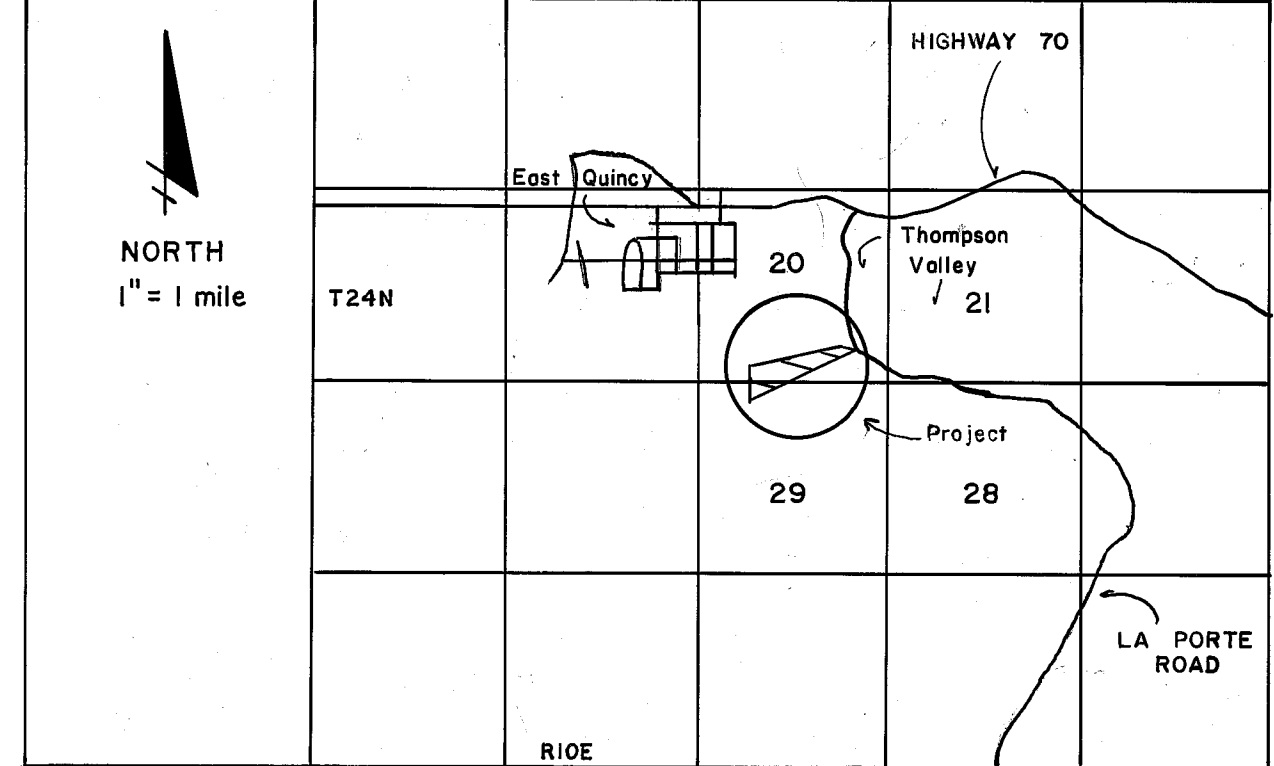

SURVEYOR'S CERTIFICATE

This map was prepared by me or under my direction and is based upon a field survey in conformance with the requirements of the Subdivision Map Act and Local Ordinance at the request of Louanne E. Rowe in Dec. 1988. All of the monuments shown hereon are of the character and occupy the positions indicated and are sufficient to enable the survey to be retraced. I hereby state that this parcel map substantially conforms to the approved or conditionally approved tentative map, if any.

*Clifford R. Brown*  
Clifford R. Brown RCE 22836

COUNTY SURVEYOR'S CERTIFICATE

This map conforms with the requirements of the Subdivision Map Act and Local Ordinance.

Dated 12/5/89

*Lawrence J. Brock*  
Lawrence J. Brock RCE 13528  
Plumas County Surveyor

COUNTY TAX COLLECTOR'S CERTIFICATE

I, Barbara J. Coates, Tax Collector of the County of Plumas, State of California, do hereby certify that there are no tax liens against the parcels, as shown hereon, for unpaid state, county, municipal, or local taxes or special assessments collected as taxes, except taxes or assessments not yet payable. Taxes or assessments which are a lien but not yet payable, are estimated to be in the amount of none.

Dated 12-11-89

*Barbara J. Coates*  
*By: Sunny Schorer*  
Barbara J. Coates  
Plumas County Tax Collector

COUNTY RECORDER'S CERTIFICATE

Filed this 11th day of DECEMBER, 1989, at 2:30 p.m. in Book 10 of PARCEL MAPS, at page 1-3, at the request of the County Engineer.

ILA DIGGS  
County Recorder

Fee \$9.00

File No. 8781

*James P. del Valle*  
Deputy

PARCEL MAP AND PLANNED DEVELOPMENT

-FOR-

LOUANNE E. ROWE  
P.O. Box 614  
Quincy, CA 95971

A division of two parcels within T24N R10E, S20 & S29 near Quincy, Plumas County, California

Engineer: Cliff Brown Engineering & Survey  
2335 Ponderosa  
Quincy, CA 95971 283-3959

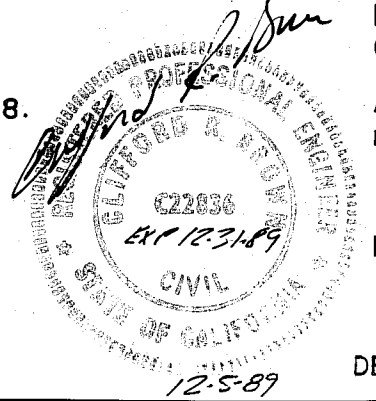

DEC 1988

Sheet 1 of 3

- NOTES:
- SUPPLEMENTAL INFORMATION:  
An Owner's Statement is on file with the County Recorder in Book 513 of Official Records at page 35. The certificate was signed by Louanne E. Rowe and stated that she consents to the preparation and recording of this map.
  - This is a division of Parcel 6 of 7PM38.

10 PM 1