

(N89°32'48"W 2204.13')
BASIS OF BEARINGS 9 PM 89

ROAD EASEMENT DATA

| Course | Delta or Bearing | Radius | | | Arc Length or Distance | | | CL Tan |
|--------|------------------|---------|---------|---------|------------------------|---------|---------|--------|
| | | Lt | CL | Rt | Lt | CL | Rt | |
| A | S78°28'43"E | | | | 11.67' | 79.25' | 65.93' | |
| B | S6°02'53" | 70' | 100' | 130' | 68.48' | 97.82' | 127.17' | 53.22' |
| C | N45°28'24"E | | | | 146.30' | 146.30' | 146.30' | |
| D | 22°26'43" | 230' | 200' | 170' | 90.10' | 78.35' | 66.60' | 78.34' |
| E | N67°55'07"E | | | | 163.04' | 163.04' | 163.04' | |
| F | 40°45'16" | 160' | 130' | 100' | 113.81' | 92.47' | 71.13' | |
| G | S71°19'37"E | | | | 382.85' | 382.85' | 382.85' | |
| H | 28°30'57" | 141.57' | 171.57' | 201.57' | 70.46' | 85.39' | 100.32' | |
| I | N80°09'26"E | | | | 141.43' | 141.43' | 141.43' | |
| J | 119°09'45" | 90' | 60' | 30' | 185.61' | 123.74' | 61.87' | |
| K | S18°19'11"W | | | | 223.04' | 313.04' | 223.04' | |
| L | 143°07'49" | | 50' | | | | 124.90' | |

COUNTY TAX COLLECTOR'S CERTIFICATE

I, Barbara J. Coates, Tax Collector of the County of Plumas, State of California, do hereby certify that there are no tax liens against the Parcels, as shown hereon, for unpaid state, county, municipal, or local taxes or special assessments collected as taxes, except taxes or assessments not yet payable. Taxes or assessments which are a lien but not yet payable, are estimated to be in the amount of None.

Dated 1-11-89

Barbara J. Coates
By: Penny Schaefer
Barbara J. Coates
Plumas County Tax Collector

SURVEYOR'S CERTIFICATE

This map was prepared by me or under my direction and is based upon a field survey in conformance with the requirements of the Subdivision Map Act and Local Ordinance at the request of Robert & Nansea Metts in May 1988. All of the monuments shown hereon are of the character and occupy the positions indicated and are sufficient to enable the survey to be retraced. I hereby state that this parcel map substantially conforms to the approved or conditionally approved tentative map, if any.

Clifford R. Brown
Clifford R. Brown RCE 22836

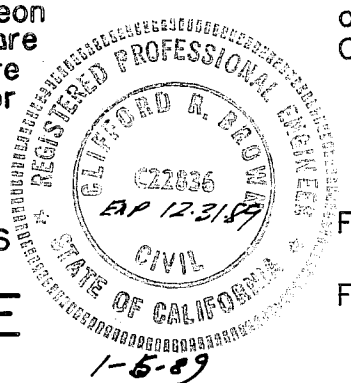

COUNTY RECORDER'S CERTIFICATE

Filed this 11TH day of JANUARY, 1989, at 8:55 A.m. in Book 9 of PARCEL MAPS, at page 123-124, at the request of the County Engineer.

Fee \$ 7.00

File No. 219

ILA DIGGS
County Recorder

Stephen Williams
Deputy

COUNTY SURVEYOR'S CERTIFICATE

This map conforms with the requirements of the Subdivision Map Act and Local Ordinance.

Dated 1-10-89

Lawrence J. Brock
Lawrence J. Brock RCE 13528
Plumas County Surveyor

PARCEL MAP

-FOR-

Robert & Nansea Metts
P.O. Box 144
Chilcoat, CA 96105

A division of Four parcels within a portion of Section 24, T23N, R16E, MDBM Near Chilcoat, Plumas County, California

Engineer: Cliff Brown Engineering & Survey
Rt. 1, Box 480B
Quincy, CA 95971 283-3959

June 1988

Sheet 1 of 2

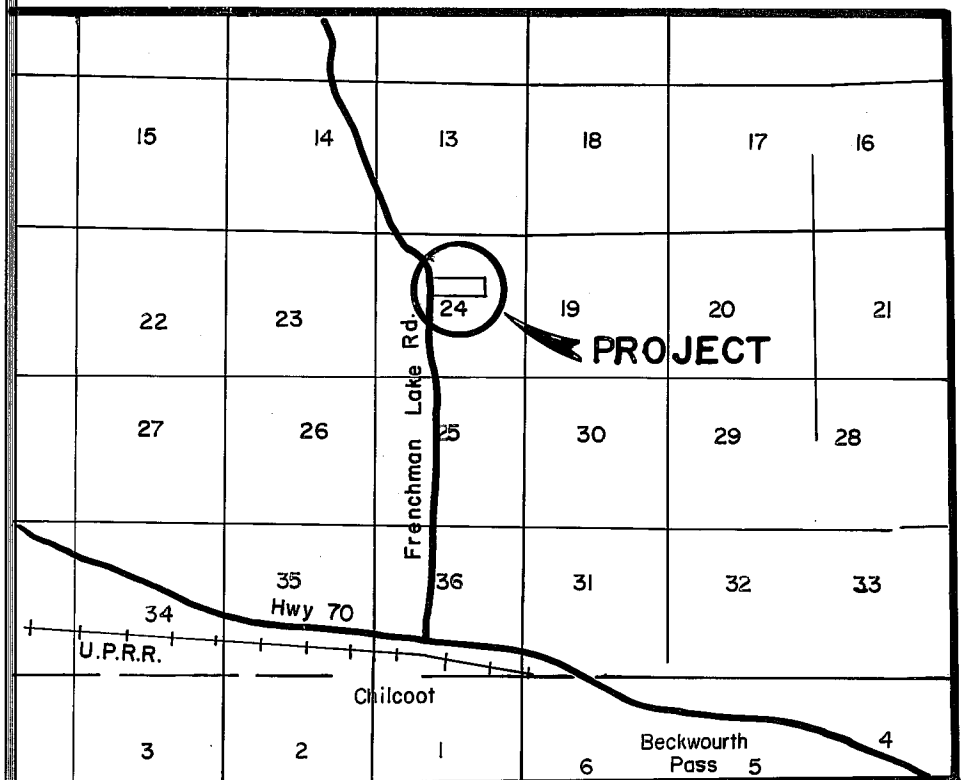

Location Map
3/4" = 1 mile

SUPPLEMENTAL INFORMATION:
A Certificate of Ownership is on file with the County Recorder in Book 494 of Official Records at page 517. The certificate was signed by Robert & Nansea Metts and stated that they consent to the preparation and recording of this map.