

SURVEYOR'S CERTIFICATE:

This map was prepared by me or under my direction and is based upon information of record in conformance with requirements of the Subdivision Map Act and local ordinances at the request of Wes Harberts on September 26, 1986. All of the monuments shown hereon are of the character and occupy the positions indicated and are sufficient to enable the survey to be retraced. I hereby state that the parcel map procedures of the local agency have been complied with and that this parcel map conforms to the approved tentative map and the conditions of approval thereof which were required to be fulfilled prior to filing the parcel map, if any.

John W. Hamby
John W. Hamby - L.S. 2843

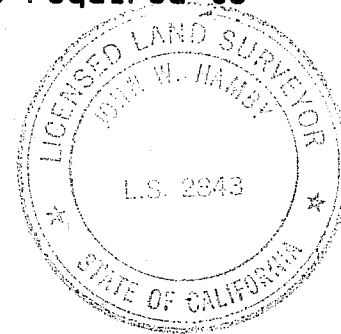

COUNTY SURVEYOR'S CERTIFICATE:

This map conforms with the requirements of the Subdivision Map Act and local ordinances.

Dated 1-15-87

Lawrence J. Brock
Lawrence J. Brock - R.C.E. 13528
Plumas County Surveyor

COUNTY TAX COLLECTOR'S CERTIFICATE:

I, Barbara J. Cokor, Tax Collector of the County of Plumas, State of California, do hereby certify that there are no tax liens against the parcels, as shown hereon, for unpaid County, Municipal or Local Taxes or Special Assessments collected as taxes, except taxes or assessments not yet payable. Taxes or assessments which are a lien but not yet payable, are estimated to be in the amount of none.

Dated 1-7-87

Barbara J. Cokor by: Ginny Schoeder
Barbara J. Cokor
Plumas County Tax Collector

COUNTY RECORDER'S CERTIFICATE:

Filed this 20th day of January, 1987, at 9:06 A.M. in Book 9 of Parcel Maps, at Page 69 & 70 at the request of the County Engineer.

Fee \$ 7.00
File No 5466

Ila Diggs
County Recorder

by Bob Cammack
Deputy

NOTES

This map is compiled from record information shown in Book 6 of Records of Surveys on Pages 68 and 71.

Parcel 1 shall not be further subdivided nor developed with structural improvements that result in ground disturbance unless and until an archaeological survey of said property is conducted and a report of findings along with mitigation measures, if any, is provided to the County or unless the General Plan constraint designation is formally removed.

A certificate of ownership is on file with the County Recorder in Book 459 of Official Records at page 145. The certificate was signed by William W. Harberts and Evelyn Mae Harberts and stated that they consent to the preparation and recording of this map, and that they are only persons whose consent is required to pass title to said land.

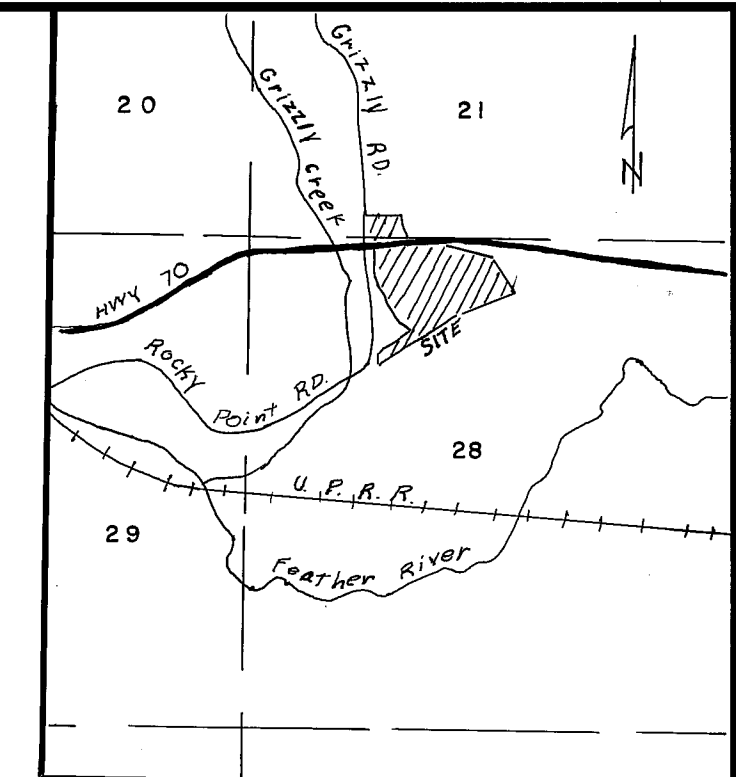

LOCATION MAP N.T.S.

PARCEL MAP
FOR

HARBERTS FAMILY TRUST

BEING A PORTION
OF
THE NORTHWEST 1/4 OF SECTION 28
AND
THE SOUTHWEST 1/4 OF SECTION 21
T. 23 N., R. 14 E., M.D.B.&M.

PLUMAS COUNTY CALIFORNIA

JUNE 1986

By:
Hamby Surveying Incorporated
P.O. Box 1209 Ph. (916) 832-5571
Portola California 96122