

COUNTY TAX COLLECTOR'S CERTIFICATE

I, BARBARA J. COKOR, TAX COLLECTOR OF THE COUNTY OF PLUMAS, STATE OF CALIFORNIA, DO HEREBY CERTIFY THAT THERE ARE NO TAX LIENS AGAINST THE PARCELS, AS SHOWN HEREON, FOR UN-PAID COUNTY, MUNICIPAL, OR LOCAL TAXES OR SPECIAL ASSESSMENTS COLLECTED AS TAXES EXCEPT TAXES OR ASSESSMENTS NOT YET PAYABLE. TAXES OR ASSESSMENTS WHICH ARE A LIEN BUT NOT YET PAYABLE ARE ESTIMATED TO BE IN THE AMOUNT OF \$ none.

DATED 2-27-86

Barbara J. Cokor by: Ginny Schroder
BARBARA J. COKOR
PLUMAS COUNTY TAX COLLECTOR

OWNER'S CERTIFICATE

WE HEREBY CERTIFY THAT WE ARE THE OWNERS OF THE REAL PROPERTY WITHIN THE LIMITS OF THIS MAP. WE HEREBY CONSENT TO THE PREPARATION AND RECORDING OF THIS MAP AND ARE THE ONLY PERSONS WHOSE CONSENT IS REQUIRED TO PASS TITLE TO SAID LANDS.

THE ACCESS SHOWN WITHIN THIS MAP, WHICH PURPORT TO BE EASEMENTS AND APPURTENANT TO SAID PROPERTY WILL BE CONVEYED TO ALL GRANTEEES OF THE AFFECTED PROPERTY AS SHOWN HEREON AND FOR THE PURPOSES NOTED.

DATED February 27, 1986

Ivan Lambert
IVAN LAMBERT
Regina Lambert
REGINA LAMBERT

NOTARY:

STATE OF California
COUNTY OF Plumas } ss.

ON THIS THE 27 DAY OF February 1986, BEFORE ME,

Dulphine E. Esler
THE UNDERSIGNED NOTARY PUBLIC PERSONALLY APPEARED
Ivan Lambert and Regina Lambert,

PERSONALLY KNOWN TO ME
 PROVED TO ME ON THE BASIS OF SATISFACTORY EVIDENCE TO BE THE PERSONS WHOSE NAMES are SUBSCRIBED TO THE WITHIN INSTRUMENT, AND ACKNOWLEDGED THAT they EXECUTED IT.
WITNESS MY HAND AND OFFICIAL SEAL.

Dulphine E. Esler
NOTARY SIGNATURE

LOCATION MAP

SCALE: 1" = 2000 FT.

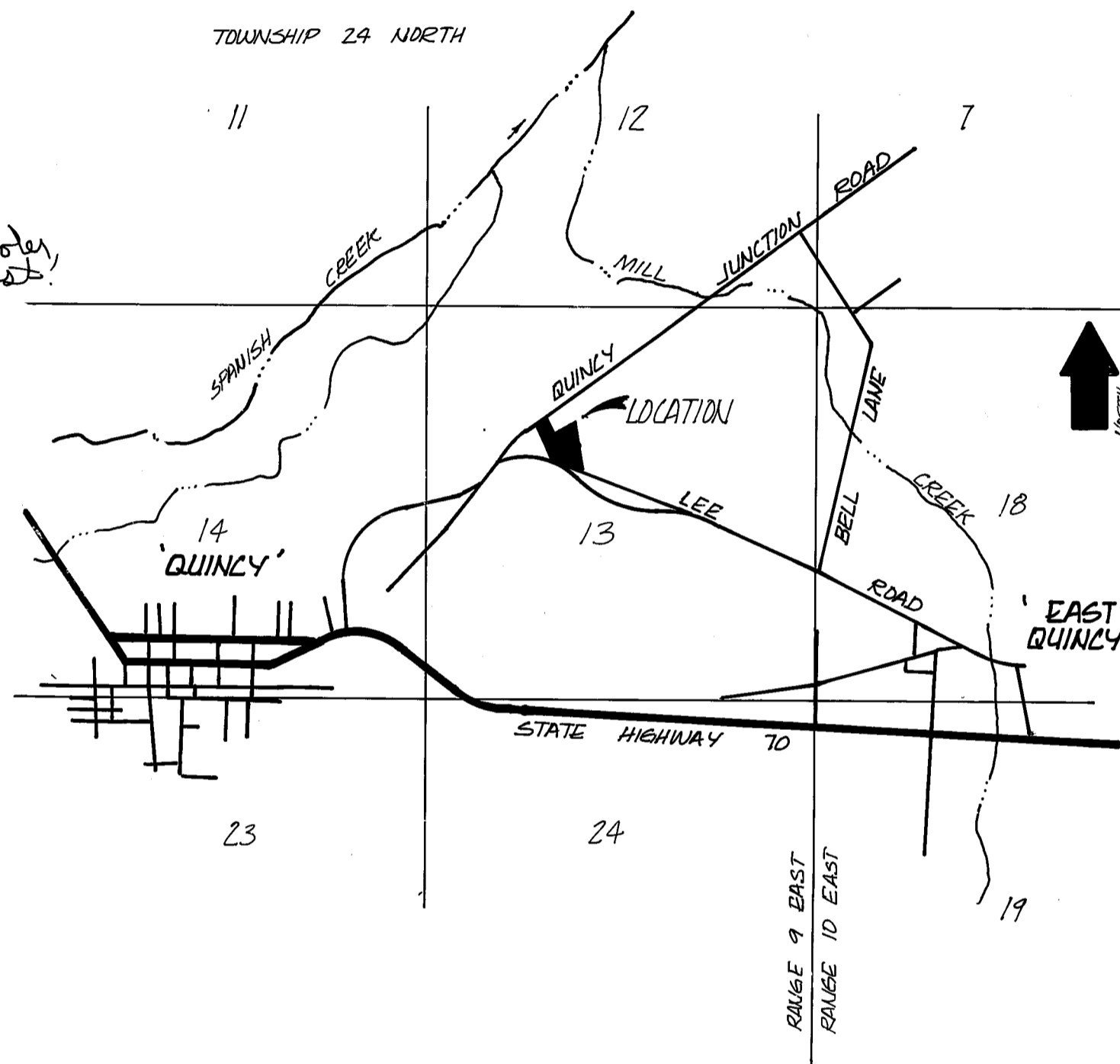

SURVEYOR'S CERTIFICATE

THIS MAP WAS PREPARED BY ME OR UNDER MY DIRECTION AND IS BASED UPON A FIELD SURVEY IN CONFORMANCE WITH THE REQUIREMENTS OF THE SUBDIVISION MAP ACT AND LOCAL ORDINANCES AT THE REQUEST OF IVAN & REGINA LAMBERT ON NOVEMBER 2, 1985. ALL OF THE MONUMENTS SHOWN HEREON ARE OF THE CHARACTER AND OCCUPY THE POSITIONS INDICATED AND ARE SUFFICIENT TO ENABLE THE SURVEY TO BE RETRACED. I HEREBY STATE THAT THIS PARCEL MAP SUBSTANTIALLY CONFORMS TO THE APPROVED OR CONDITIONALLY APPROVED TENTATIVE MAP, IF ANY.

Mark D. Filsinger
MARK D. FILSINGER
LS 4976
Exp. 12-31-89

COUNTY SURVEYOR'S CERTIFICATE

THIS MAP CONFORMS WITH THE REQUIREMENTS OF THE SUBDIVISION MAP ACT AND LOCAL ORDINANCES.

DATED Feb. 27, 1986

Lawrence J. Brock by R. Tom Slanta RCE 30515
LAWRENCE J. BROCK, R.C.E. 13528
PLUMAS COUNTY SURVEYOR

PARCEL MAP

FOR
IVAN & REGINA LAMBERT

LOCATED IN THE NORTHWEST QUARTER OF SECTION 13, TOWNSHIP 24 NORTH, RANGE 9 EAST, MOUNT DIABLO MERIDIAN, PLUMAS COUNTY, CALIFORNIA.

MARK D. FILSINGER
LAND SURVEYOR

473 BELL LANE P.O. BOX 3108
QUINCY CALIF. 95971 (916) 283-0754

COUNTY RECORDER'S CERTIFICATE

FILED THIS 27th DAY OF February, 1986, AT 11:37 A.M. IN BOOK 9 OF Parcel Maps, AT PAGE 48 & 49, AT THE REQUEST OF THE COUNTY ENGINEER.

FEE: \$ 7.00
FILE No: 5112

ILA DIGGS
COUNTY RECORDER

BY Patricia Lacey
DEPUTY