

- LEGEND**
- Fd. 3/4" I.P. LS 3202 (5 RS 31)
  - ⊗ Fd 1/2" rebar RCE 26870 (5 M 78)
  - Set 1/2" rebar RCE 22836
  - △ Calc. point
  - Approx. leach exclusion area
  - ( ) Record (5 RS 31)
  - (-a) Record (5 M 78)

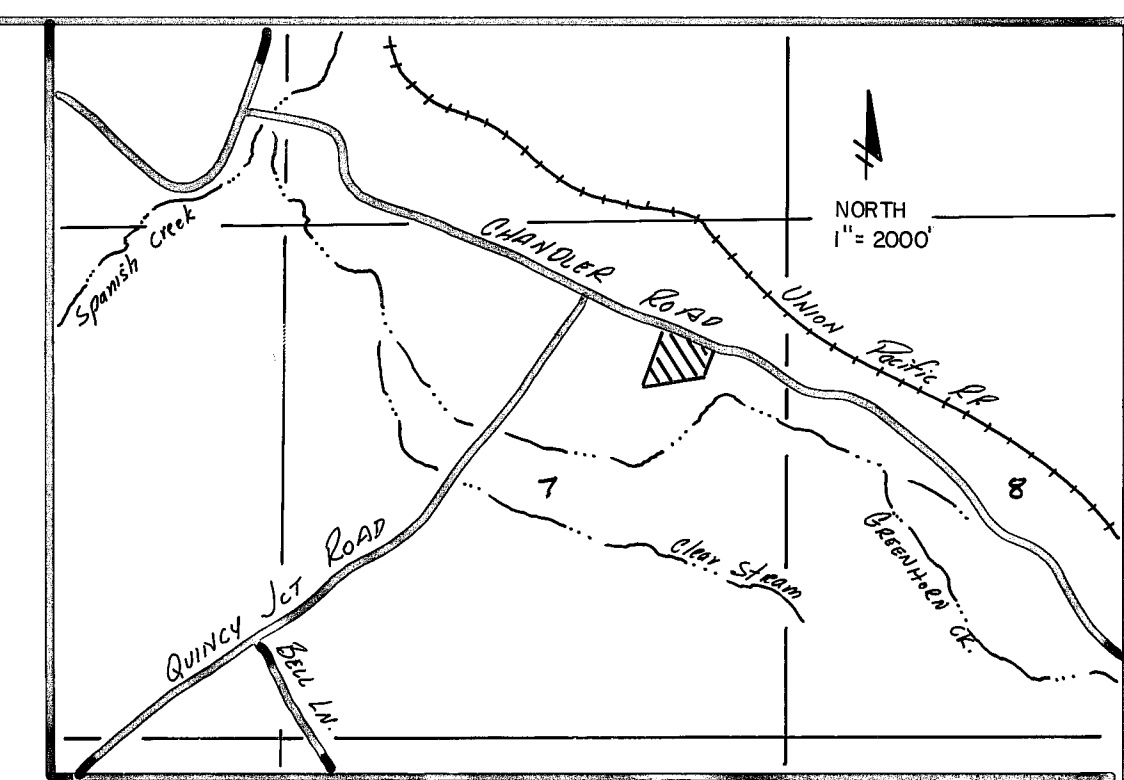

**COUNTY RECORDER'S CERTIFICATE**

Filed this 15<sup>TH</sup> day of November 1985, at 2:15 P.m.  
in Book 9 of Parcel Maps at Page 39 at the request  
of the County Engineer.

Fee \$5<sup>00</sup>  
File No. 3427

Ila Diggs, County Recorder  
by Beth Cammack  
Deputy

**ENGINEER'S CERTIFICATE**

This map was prepared by me or under my direction and is based upon a field survey in conformance with the requirements of the Subdivision Map Act and Local Ordinance at the request of Robert L. and Dorothy L. McDonald in August 1985. All of the monuments shown hereon are of the character and occupy the positions indicated and are sufficient to enable the survey to be retraced. I hereby state that the parcel map procedures of the local agency have been complied with and that this parcel map conforms to the approved tentative map and the conditions of approval thereof which were required to be fulfilled prior to the filing of the parcel map.

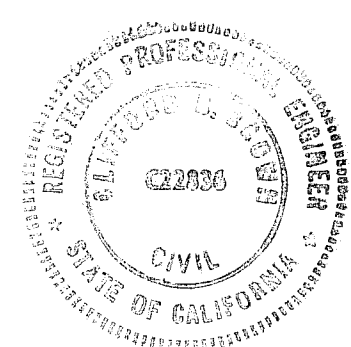

Clifford R. Brown  
Clifford R. Brown RCE 22836

**COUNTY SURVEYOR'S CERTIFICATE**

This map conforms with the requirements of the Subdivision Map Act and Local Ordinance.

dated 11-15-85

Lawrence J. Brock  
Lawrence J. Brock RCE 13528  
Plumas County Surveyor

**PARCEL MAP**

A DIVISION OF THREE PARCELS  
for  
**ROBERT L. and DOROTHY L. McDONALD**

A portion of Section 7, T24N, RIOE, MDBM  
Plumas County, California

Clifford R. Brown Engineering & Survey  
Rt. 1 Box 480 B  
Quincy, CA 95971

**COUNTY TAX COLLECTOR**

I, Barbara J. Cokor, Tax Collector of the County of Plumas, State of California, do hereby certify that there are no tax liens against the parcels as shown hereon for unpaid County, Municipal or Local Taxes or Special Assessments collected as taxes, except taxes or assessments not yet payable. Taxes or assessments which are a lien but not yet payable are estimated to be in the amount of none.

dated Nov. 15, 1985

Barbara J. Cokor by Ginny Schoeder, asst.  
Barbara J. Cokor  
Plumas County Tax Collector

**NOTES:**

1. Leach exclusion areas are all areas within 50' of property lines, and water courses, within a distance of four times the height of any cutbank, and all slopes in excess of 30%, and areas within the primary flood plain, and 100' from wells.
2. A certificate of ownership is on file with the County Recorder in Book 433 of Official Records at page 367. The certificate was signed by Robert L. and Dorothy L. McDonald and stated that they consent to the preparation and recording of this map, and that they are the only persons whose consent is required to pass title to said land.