

NOTES

1. A Certificate of ownership is on file with the County Recorder in Book 429 of Official Records at page 607. The certificate was signed by Ernest G. Leonhardt and stated that he consents to the preparation and recording of this map, and that he is the only person whose consent is required to pass title to said land.
2. Leach Exclusion Areas include 100' from wells, and areas shown hereon as having seasonal ground water less than 8' deep.
3. No building permits authorizing development upon the parcels shown hereon shall be issued and processed by the County of Plumas until such time that said properties are annexed into the Quincy Fire Protection District.
4. Roads show hereon, North Mill Creek Road is a private easement, not subject to improvement or maintenance by Plumas County. Such easements will not become effective unless and until reservations and grants are included in the respective deeds.

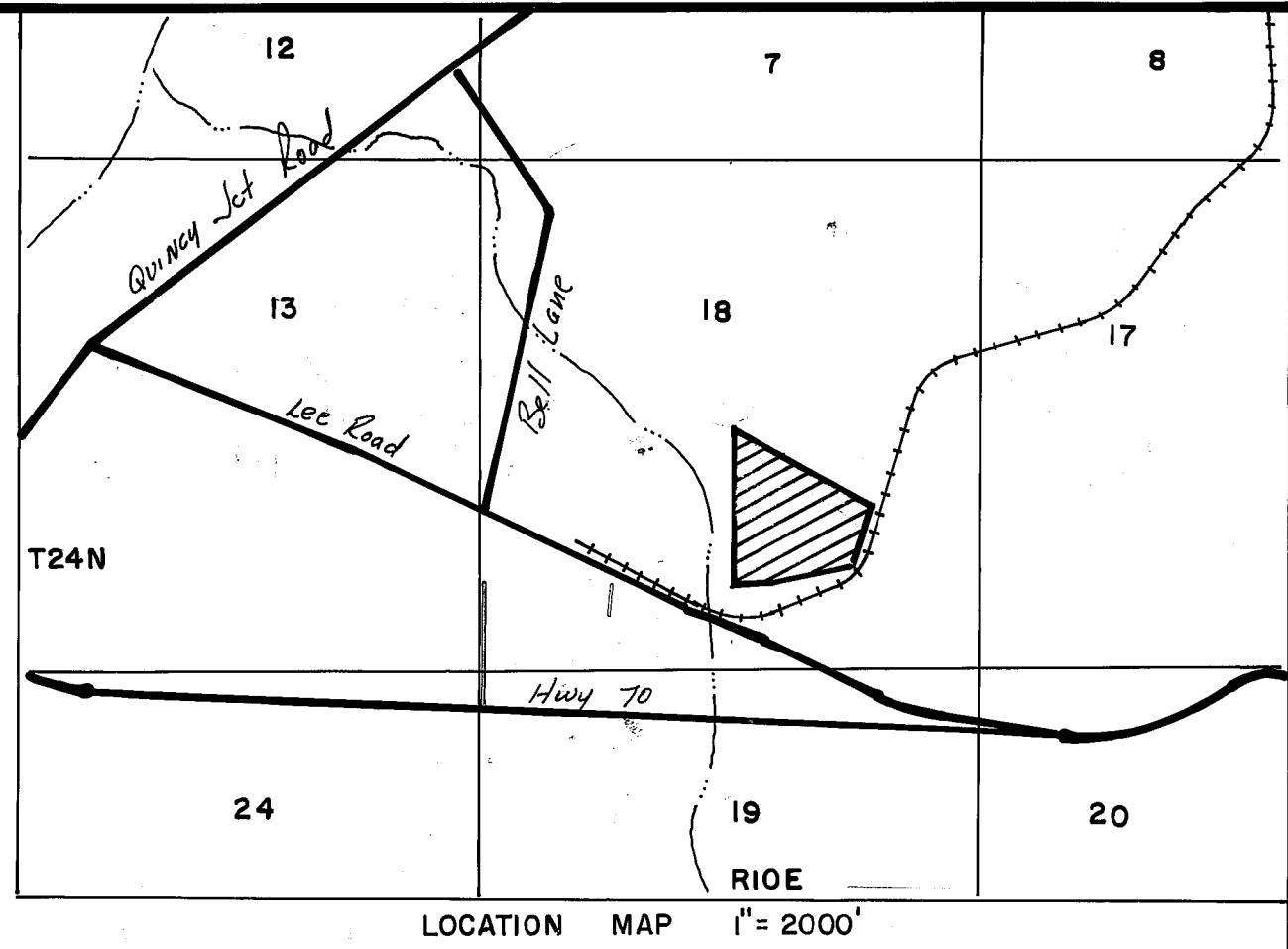

ENGINEER'S CERTIFICATE

This map was prepared by me or under my direction and is based upon a field survey in conformance with the requirements of the Subdivision Map Act and Local Ordinance at the request of Ernest G. Leonhardt in May 1983. All of the monuments shown hereon are of the character and occupy the positions indicated and are sufficient to enable the survey to be retraced. I hereby state that the parcel map procedures of the local agency have been complied with and that this parcel map conforms to the approved tentative map and the conditions of approval thereof which were required to be fulfilled prior to the filing of the parcel map.



Clifford R. Brown
Clifford R. Brown RCE 22836

COUNTY SURVEYOR'S CERTIFICATE

This map conforms with the requirements of the Subdivision Map Act and Local Ordinance.
 dated 8/27/85
Lawrence J. Brock
 Lawrence J. Brock RCE 13528
 Plumas County Surveyor

COUNTY RECORDER'S CERTIFICATE

Filed this 27 day of August 1985, at 3:00 P.M. in Book 9 of Parcel Maps at Page 32 at the request of the County Engineer.
 ILA DIGGS, County Recorder
 Fee \$5.00
 File No. 1251 by *Patricia Lacey*
 Deputy

PARCEL MAP

A DIVISION OF TWO PARCELS
 for
ERNEST G. LEONHARDT
 A portion of Section 18, T24N, R10E MDBM PLUMAS Co., CALIF.

COUNTY TAX COLLECTOR

I, Barbara J. Cokor, Tax Collector of the County of Plumas, State of California, do hereby certify that there are no tax liens against the parcels as shown hereon for unpaid County, Municipal or Local Taxes or Special Assessments collected as taxes, except taxes or assessments not yet payable. Taxes or assessments which are a lien but not yet payable are estimated to be in the amount of \$ 731.00.

Dated August 21, 1985
Barbara J. Cokor by Penny Schooler
 Barbara J. Cokor
 Plumas County Tax Collector

Clifford R. Brown
 Consulting Civil Engineering / Surveying
 Rt. 1 Box 480B Quincy, Calif.