

MAP NOTES:

- ◆ FOUND SECTIONAL SUBDIVISION POINT AS NOTED.
- FOUND MONUMENT AS NOTED.
- SET 1/2" REBAR W/ PLASTIC CAP STAMPED R.C.E. 15265
- COMPUTED CORNER LOCATION
- (R) RADIAL BEARING
- R/S RECORD OF SURVEY - BOOK AND PAGE
- () INDICATES RECORD DATA PER OFFICIAL RECORDS, VOLUME 327, PAGE 589, UNLESS OTHERWISE INDICATED.
- WATERCOURSE W/ DIRECTION OF FLOW
- OVERFLOW AREA
- APPROXIMATE BOUNDARY OF AREAS WITH A GROUND SLOPE 30 PERCENT OR GREATER.

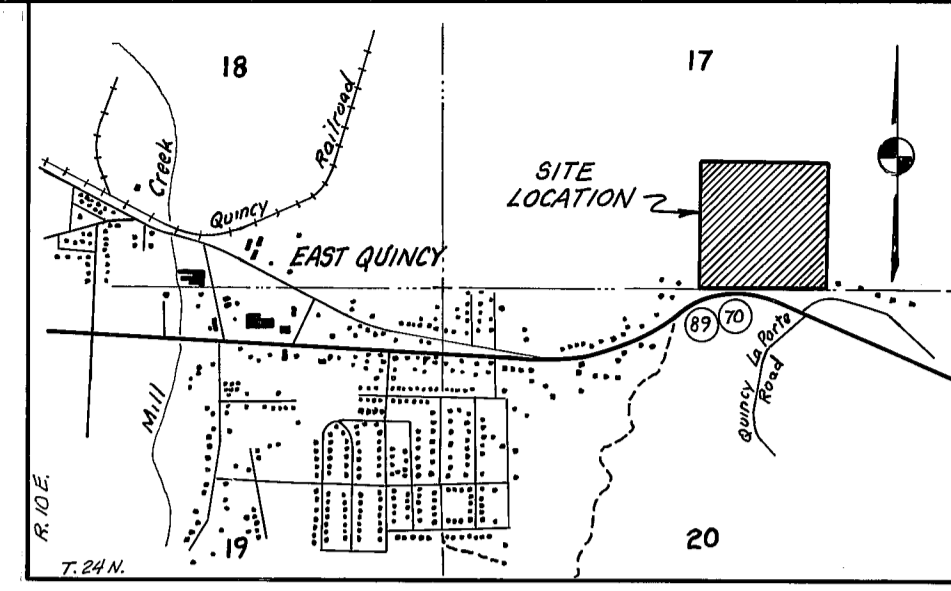

SITE LOCATION MAP
SCALE: 1" = 2000'

COUNTY SURVEYOR'S CERTIFICATE
THIS MAP CONFORMS WITH THE REQUIREMENTS OF THE SUBDIVISION MAP ACT AND LOCAL ORDINANCE.

DATED: December 5, 1980
SIGNED: *Lawrence J. Brock*
LAWRENCE J. BROCK R.C.E. 13528
PLUMAS COUNTY SURVEYOR

ENGINEER'S CERTIFICATE
THIS MAP WAS PREPARED BY ME OR UNDER MY DIRECTION AND IS BASED UPON A FIELD SURVEY IN CONFORMANCE WITH THE REQUIREMENTS OF THE SUBDIVISION MAP ACT AND LOCAL ORDINANCE AT THE REQUEST OF RODDY & NANCY MAC IN JUNE, 1980. I HEREBY STATE THAT THIS PARCEL MAP SUBSTANTIALLY CONFORMS TO THE APPROVED OR CONDITIONALLY APPROVED TENTATIVE MAP, IF ANY.

Richard A. Lundy
RICHARD A. LUNDY R.C.E. 15265

RECORDER'S CERTIFICATE
FILED THIS 5TH DAY OF December, 1980, AT 3:25 P.M. IN BOOK 7 OF PARCEL MAPS AT PAGE 114, AT THE REQUEST OF THE COUNTY ENGINEER.

FEEL: \$500
FILE NO.:
BY: *Frances Nicol*
FRANCES NICOL
DEPUTY
ILA DIGGS
COUNTY RECORDER

COUNTY TAX COLLECTOR'S CERTIFICATE
I, LOIS ALEXANDER, TAX COLLECTOR OF THE COUNTY OF PLUMAS, STATE OF CALIFORNIA, DO HEREBY CERTIFY THAT THERE ARE NO TAX LIENS AGAINST THE PARCELS, AS SHOWN HEREON, FOR UNPAID COUNTY, MUNICIPAL, OR LOCAL TAXES OR SPECIAL ASSESSMENTS COLLECTED AS TAXES, EXCEPT TAXES OR ASSESSMENTS NOT YET PAYABLE. TAXES OR ASSESSMENTS WHICH ARE A LIEN BUT NOT YET PAYABLE, ARE ESTIMATED TO BE IN THE AMOUNT OF \$ NONE.

DATED: 12/5/80
Lois Alexander
LOIS ALEXANDER
PLUMAS COUNTY TAX COLLECTOR

- GENERAL NOTES:**
1. THE BASIS OF BEARINGS SHOWN ON THIS MAP IS THE SOUTH LINE OF SECTION 17, TOWNSHIP 24 NORTH, RANGE 10 EAST, GIVEN AS N89°29'19"W IN BOOK 5 OF RECORDS OF SURVEY AT PAGE 114, PLUMAS COUNTY RECORDS.
 2. A CERTIFICATE, SIGNED AND ACKNOWLEDGED BY THE OWNERS, CONSENTING TO THE PREPARATION AND RECORDATION OF THIS PARCEL MAP, DATED AUGUST 6, 1980, IS ON FILE IN THE COUNTY ENGINEER'S OFFICE.
 3. LEACH EXCLUSION AREAS EXIST ON ALL THOSE PORTIONS OF THE PROPERTY: LYING WITHIN 50 FEET OF ALL WATERCOURSES; LYING WITHIN 50 FEET OF ALL PARCEL LOT LINES EXCEPT THE MOST W/XY LINE OF PARCELS 1 AND 4 AND THE MOST S/W LINE OF PARCELS 2 AND 4; HAVING A GROUND SURFACE SLOPE GREATER THAN 30%; OR HAVING A SEASONAL HIGH GROUND WATER LEVEL WITHIN THREE FEET OF THE GROUND SURFACE.
 4. ROADS SHOWN HEREON ARE PRIVATE EASEMENTS THAT ARE ESTABLISHED BY A DECLARATION FILED CONCURRENTLY WITH OR PRIOR TO RECORDATION OF THE MAP. SUCH EASEMENTS MAY NOT BECOME FULLY EFFECTIVE UNLESS AND UNTIL RESERVATIONS AND GRANTS ARE INCLUDED IN THE RESPECTIVE DEEDS. SUCH EASEMENTS ARE ALSO DRAINAGE AND PUBLIC UTILITY EASEMENTS.
 5. NO FURTHER ENTITLEMENTS WILL BE GRANTED BY THE COUNTY FOR PARCEL 1 UNTIL THE PROPERTY IS ANNEXED INTO THE QUINCY FIRE PROTECTION DISTRICT.



PARCEL MAP

FOR
RODDY & NANCY MAC
BEING THE S-W 1/4 OF THE S-E 1/4 OF SECTION 17, T.24N., R.10E., M.D.B., M. IN PLUMAS COUNTY, CALIFORNIA

BY:
LUNDY ENGINEERING INCORPORATED
P.O. BOX 308
GRAEAGLE, CALIFORNIA, 96103

CERTIFICATE OF CORRECTION RECORDED 6-30-98 BOOK 744 D.R. RECORDED 11/17/74