

MAP NOTES

- ◇ - FOUND SECTIONAL SUBDIVISION POINT AS NOTED.
- - FOUND 1/2" REBAR W/PLASTIC CAP STAMPED R.C.E. 15265, PER 7 PM 61 UNLESS OTHERWISE INDICATED.
- - SET 1/2" REBAR W/PLASTIC CAP STAMPED R.C.E. 15265.
- ⊕ - COMPUTED LOCATION
- () - RECORD DATA PER 7 PM 61, UNLESS OTHERWISE INDICATED.

1PM23 - PARCEL MAP - BOOK AND PAGE.
1R1523 - RECORD OF SURVEY - BOOK AND PAGE.

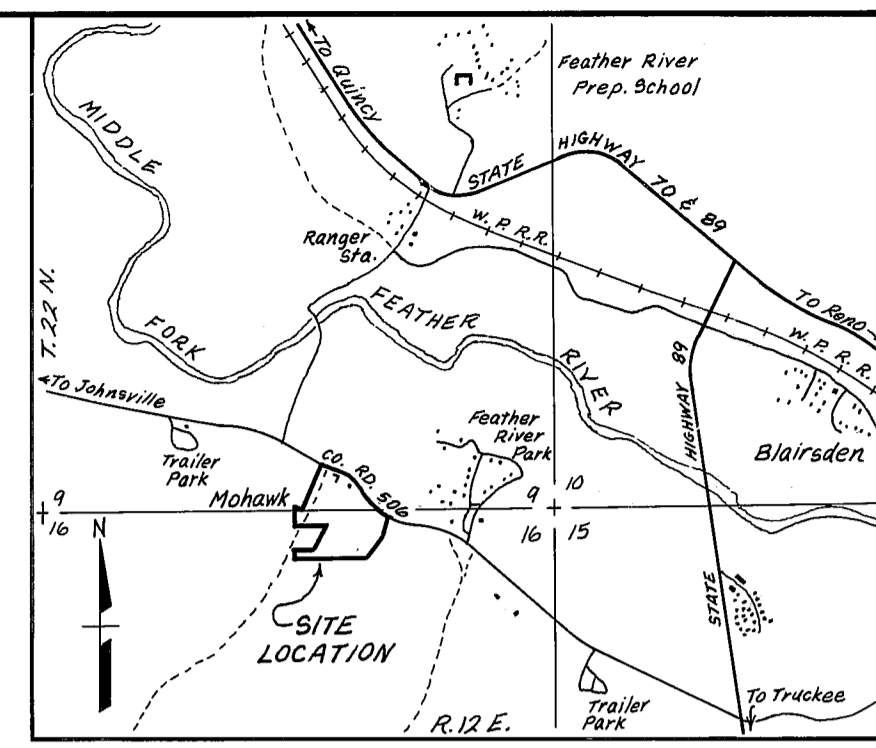

LOCATION MAP
SCALE 1" = 2000'

- GENERAL NOTES**
1. A CERTIFICATE, SIGNED AND ACKNOWLEDGED BY THE OWNER'S, CONSENTING TO THE PREPARATION AND RECORDATION OF THIS PARCEL MAP, DATED JULY 10, 1980, IS ON FILE IN THE COUNTY ENGINEER'S OFFICE.
 2. THE BASIS OF BEARINGS FOR THIS MAP IS THE NORTH-SOUTH CENTERLINE OF SECTION 16, GIVEN AS N00°01'07"W IN BOOK 5 OF RECORDS OF SURVEY AT PAGE 47 PLUMAS COUNTY RECORDS.
 3. ALL DISTANCES SHOWN IN PARENTHESIS ARE RECORD AND MEASURED.
 4. LEACH EXCLUSION AREAS EXIST ON ALL THOSE PORTIONS OF THE PROPERTY: LYING WITHIN 100 FEET OF THE ANNUAL HIGH WATER LINE OF SMITH CREEK, AND OF SMITH CREEK OVERFLOW; LYING WITHIN A 100 FOOT RADIUS OF THE EXISTING WELL; LYING WITHIN 50 FEET OF THE WESTERLY EXTERIOR BOUNDARY LINE; HAVING A SEASONAL HIGH GROUND WATER LEVEL WITHIN THREE FEET OF THE GROUND SURFACE; LYING WITHIN 5 FEET OF WATER LINES; AND AS OTHERWISE EXCLUDED BY THE UNIFORM PLUMBING CODE.
 5. PARCEL 1A IS A PORTION OF PARCEL 1 AND SHALL NOT BE SEPARATELY SOLD, LEASED OR FINANCED WITHOUT PRIOR COUNTY APPROVAL, NOR IS SAID PARCEL BUILDABLE UNTIL A PUBLIC SEWAGE COLLECTION SYSTEM SERVES IT.

COUNTY SURVEYOR'S CERTIFICATE

THIS MAP CONFORMS WITH THE REQUIREMENTS OF THE SUBDIVISION MAP ACT AND LOCAL ORDINANCE.

DATED: Sept. 19, 1980 SIGNED: Lawrence J. Brock
LAWRENCE J. BROCK R.C.E. 13528
PLUMAS COUNTY SURVEYOR
by: R. Tom Hunter R.C.E. 30515

ENGINEER'S CERTIFICATE

THIS MAP WAS PREPARED BY ME OR UNDER MY DIRECTION AND IS BASED UPON A FIELD SURVEY IN CONFORMANCE WITH THE REQUIREMENTS OF THE SUBDIVISION MAP ACT AND LOCAL ORDINANCE AT THE REQUEST OF WILLIAM M. AND ANN W. SHERRARD IN MAY, 1980. I HEREBY STATE THAT THIS PARCEL MAP SUBSTANTIALLY CONFORMS TO THE APPROVED OR CONDITIONALLY APPROVED TENTATIVE MAP, IF ANY.

Richard A. Lundy
RICHARD A. LUNDY R.C.E. 15265

COUNTY TAX COLLECTOR'S CERTIFICATE

I, LOIS ALEXANDER, TAX COLLECTOR OF THE COUNTY OF PLUMAS, STATE OF CALIFORNIA, DO HEREBY CERTIFY THAT THERE ARE NO TAX LIENS AGAINST THE PARCELS AS SHOWN HEREON, FOR UN-PAID COUNTY, MUNICIPAL, OR LOCAL TAXES OR SPECIAL ASSESSMENTS COLLECTED AS TAXES, EXCEPT TAXES OR ASSESSMENTS NOT YET PAYABLE. TAXES OR ASSESSMENTS WHICH ARE A LIEN BUT NOT YET PAYABLE, ARE ESTIMATED TO BE IN THE AMOUNT OF \$ 2462.00.

DATED: 9-19-80 SIGNED: Lois Alexander By Barbara J. Coker
LOIS ALEXANDER
PLUMAS COUNTY TAX COLLECTOR Deputy

COUNTY RECORDER'S CERTIFICATE

FILED THIS 19th DAY OF September, 1980, AT 11:48 A.M. IN BOOK 7 OF PARCEL MAPS, AT PAGE 95, AT THE REQUEST OF THE COUNTY ENGINEER.

FEE: \$ 5.00
FILE NO. 2300

ILA DIGGS
COUNTY RECORDER
BY: Midred Cotten
DEPUTY

PARCEL MAP
FOR
WILLIAM M. SHERRARD AND ANN W. SHERRARD
BEING ALL OF PARCEL 1 OF BOOK 7 OF PARCEL MAPS AT PAGE 61
WITHIN SECTIONS 9 AND 16, T.22N., R.12E., M.D.B.&M.
PLUMAS COUNTY, CALIFORNIA

LUNDY ENGINEERING INC.
P.O. BOX 308
GRAEAGLE, CALIFORNIA
R.C.E. 15265