

NOTES

1. CERTIFICATE OF OWNER'S CONSENT TO PREPARATION AND RECORDING OF THIS MAP, DATED 9-27-79, IS ON FILE IN THE COUNTY ENGINEER'S OFFICE.
2. ALL BEARINGS AND DISTANCES ON THIS MAP ARE RECORD OR CALCULATED FROM 6 PM 79.
3. LEACH EXCLUSION AREAS SHOWN ON THIS MAP ARE APPROXIMATE; THEY ARE TO INCLUDE SLOPES OF 30% OR MORE AND AREAS WITHIN 50' OF INTERMITTENT DRAINAGES, AND 100' OF YEAR-ROUND STREAMS.
4. EASEMENT NO. 1: A 20' WIDE STRIP TO BE DEDICATED AS A PUBLIC UTILITY EASEMENT.

LEGEND

- FOUND POINT AS NOTED
- ✱ FOUND 1/2" REBAR W/CAP MARKED 3297

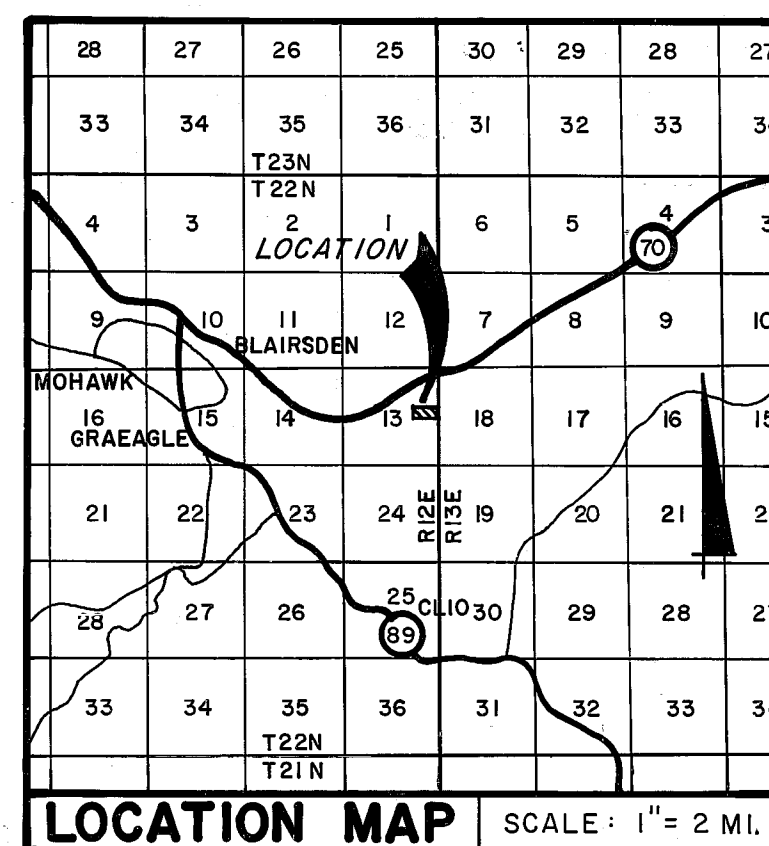

ENGINEER'S CERTIFICATE

THIS MAP WAS PREPARED BY ME OR UNDER MY DIRECTION AND IS BASED UPON RECORD INFORMATION IN CONFORMANCE WITH THE REQUIREMENTS OF THE SUBDIVISION MAP ACT AT THE REQUEST OF RUDELL BROOKS IN JULY, 1979. I HEREBY STATE THAT THE PARCEL MAP PROCEDURES OF THE LOCAL AGENCY HAVE BEEN COMPLIED WITH AND THAT THIS PARCEL MAP CONFORMS TO THE APPROVED TENTATIVE MAP AND THE CONDITIONS OF APPROVAL THEREOF WHICH WERE REQUIRED TO BE FULFILLED PRIOR TO THE FILING OF THE PARCEL MAP.

Joseph G. Brandt
JOSEPH G. BRANDT R.C.E. 26870

COUNTY SURVEYOR'S CERTIFICATE

THIS MAP CONFORMS WITH THE REQUIREMENTS OF THE SUBDIVISION MAP ACT AND LOCAL ORDINANCE.

DATED *September 27, 1979*
LAWRENCE J. BROCK RCE 13528
PLUMAS COUNTY SURVEYOR

COUNTY TAX COLLECTOR'S CERTIFICATE

I, LOIS ALEXANDER, TAX COLLECTOR OF THE COUNTY OF PLUMAS, STATE OF CALIFORNIA, DO HEREBY CERTIFY THAT THERE ARE NO TAX LIENS AGAINST THE PARCELS, AS SHOWN HEREON, FOR UNPAID COUNTY, MUNICIPAL, OR LOCAL TAXES OR SPECIAL ASSESSMENTS COLLECTED AS TAXES, EXCEPT TAXES OR ASSESSMENTS NOT YET PAYABLE. TAXES OR ASSESSMENTS WHICH ARE A LIEN BUT NOT YET PAYABLE ARE ESTIMATED TO BE IN THE AMOUNT OF \$285.00.

Lois Alexander
LOIS ALEXANDER
PLUMAS COUNTY TAX COLLECTOR
by *Jeri Sprague, Deputy*

COUNTY RECORDER'S CERTIFICATE

FILED THIS 4th DAY OF October, 1979, AT 1:55 P.M. IN BOOK 7 OF PARCEL MAPS AT PAGE 19, AT THE REQUEST OF THE COUNTY ENGINEER.

RAYNELLE SLATEN
COUNTY RECORDER

FEE \$5.00
FILE NO. 8773

BY *Isabelle Andrews*
DEPUTY

PARCEL MAP OF

A SUBDIVISION INTO TWO PARCELS
OF

A PORTION OF THE E. 1/2 OF SEC. 13, T22N, R12E MDM

PLUMAS COUNTY, CALIFORNIA

FOR

RUDELL BROOKS
ET UX

brandt & associates
CIVIL ENGINEERS~SURVEYORS

75 COURT STREET
QUINCY, CALIFORNIA 95971

P.O. BOX 749
916-283-1111

W.O. No. 790509

DATE: JULY, 1979
SHEET 1 OF 1