

COUNTY TAX COLLECTOR'S CERTIFICATE

I, LOIS ALEXANDER, TAX COLLECTOR OF THE COUNTY OF PLUMAS, STATE OF CALIFORNIA, DO HEREBY CERTIFY THAT THERE ARE NO TAX LIENS AGAINST THE PARCELS, AS SHOWN HEREON, FOR UNPAID COUNTY, MUNICIPAL, OR LOCAL TAXES OR SPECIAL ASSESSMENTS COLLECTED AS TAXES, EXCEPT TAXES OR ASSESSMENTS NOT YET PAYABLE. TAXES OR ASSESSMENTS WHICH ARE A LIEN BUT NOT YET PAYABLE, ARE ESTIMATED TO BE IN THE AMOUNT OF \$210.00

DATED: 6/18/79

Lois Alexander
PLUMAS COUNTY TAX COLLECTOR

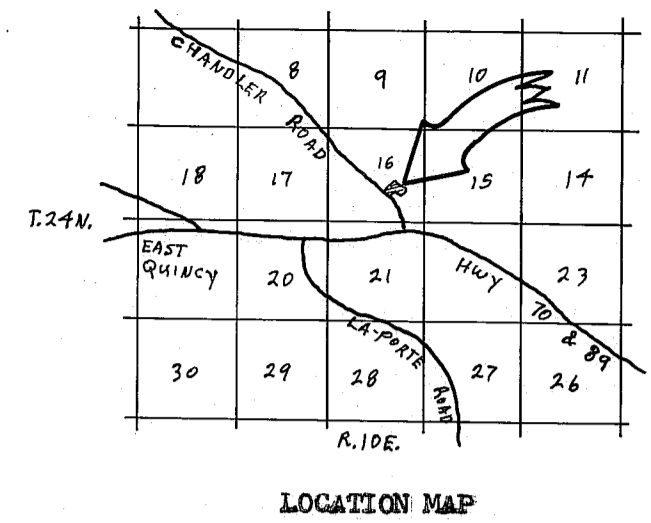

SURVEYOR'S CERTIFICATE

THIS MAP WAS PREPARED BY ME OR UNDER MY DIRECTION AND WAS COMPILED FROM RECORD DATA AND IS BASED UPON A FIELD SURVEY IN CONFORMANCE WITH THE REQUIREMENTS OF THE SUBDIVISION MAP ACT AND LOCAL ORDINANCE AT THE REQUEST OF RONALD VOSS IN MAY 1979. I HEREBY STATE THAT THE PARCEL MAP PROCEDURES OF THE LOCAL AGENCY HAVE BEEN COMPLIED WITH AND THAT THIS PARCEL MAP CONFORMS TO THE APPROVED TENTATIVE MAP AND THE CONDITIONS OF APPROVAL THEREOF WHICH WERE REQUIRED TO BE FULFILLED PRIOR TO THE FILING OF THE PARCEL MAP.

Gerald C. Henderson
GERALD C. HENDERSON LS 3297

COUNTY SURVEYOR'S CERTIFICATE

THIS MAP CONFORMS WITH THE REQUIREMENTS OF THE SUBDIVISION MAP ACT AND LOCAL ORDINANCE.

DATED: 6-20-79

Lawrence J. Brock
LAWRENCE J. BROCK RCE 13528
PLUMAS COUNTY SURVEYOR

RECORDER'S CERTIFICATE

FILED THIS 20th DAY OF June 1979, AT 3:45 P.M. IN BOOK 7 OF PARCEL MAPS, AT PAGE 2, AT THE REQUEST OF THE COUNTY ENGINEER.

FEE \$ 5.00

FILE NO. 9711

RAYNELE SLATEN
COUNTY RECORDER

BY *Isabelle Andrews*
DEPUTY

NOTES

BASIS OF BEARING IS TAKEN FROM THAT CERTAIN MAP FILED IN BOOK 6 OF PARCEL MAPS AT PAGE 87, PLUMAS COUNTY RECORDS.

CERTIFICATE OF OWNER'S CONSENT TO PREPARATION AND RECORDING OF THIS MAP IS ON FILE IN THE COUNTY ENGINEER'S OFFICE DATED: 5-31-79

SEPTIC TANK/LEACHFIELD PERMITS FOR INSTALLATION MAY REQUIRE A SPECIAL DESIGN SYSTEM TO BE SUBMITTED AND APPROVED TO THE SATISFACTION OF THE COUNTY SANITARIAN PRIOR TO ISSUANCE.

ROADS SHOWN HEREON ARE PRIVATE EASEMENTS THAT ARE ESTABLISHED BY A DECLARATION FILED CONCURRENT WITH, OR PRIOR TO RECORDATION OF THE FINAL MAP. SUCH EASEMENTS MAY NOT BECOME FULLY EFFECTIVE UNLESS AND UNTIL RESERVATIONS AND GRANTS ARE INCLUDED IN THE RESPECTIVE DEEDS.

LEACH EXCLUSION AREAS ARE ALL AREAS WITHIN 100' OF WELLS, WITHIN 50' OF WATERCOURSES, WITHIN 50' OF PROPERTY LINES EXCEPT AS NOTED. WITHIN A DISTANCE OF 4 TIMES THE HEIGHT OF CUT BANKS, AND FOR ALL SLOPES OF 30% OR GREATER.

LEGEND

FOUND CORNER AS NOTED

FOUND 1/2" REBAR CAPPED LS 3297

SET 1/2" REBAR CAPPED LS 3297

COMPUTED CORNER LOCATION

WATERCOURSE

○

○

◇

○

w.c.

PARCEL MAP

OF A SUBDIVISION INTO TWO PARTS
FOR
RONALD VOSS ETUX MAY 1979
PORTION OF SECTION 16, T. 24N., R. 10E., MDN
PARCEL 4 IN BOOK 6 OF PARCEL MAPS AT PAGE 87
PLUMAS COUNTY, CALIFORNIA

GERALD C. HENDERSON
CIVIL ENGINEER-LAND SURVEYOR
P. O. BOX 1377
PORTOLA, CALIFORNIA