

COUNTY TAX COLLECTOR'S CERTIFICATE
 I, TAX COLLECTOR OF THE COUNTY OF PLUMAS, STATE OF CALIFORNIA, DO HEREBY CERTIFY THAT THERE ARE NO TAX LIENS AGAINST THE PARCELS, AS SHOWN HEREON, FOR UNPAID COUNTY, MUNICIPAL, OR LOCAL TAXES OR SPECIAL ASSESSMENTS COLLECTED AS TAXES, EXCEPT TAXES OR ASSESSMENTS NOT YET PAYABLE. TAXES OR ASSESSMENTS WHICH ARE A LIEN BUT NOT YET PAYABLE, ARE ESTIMATED TO BE IN THE AMOUNT OF \$305.00

Lois Alexander
 LOIS ALEXANDER
 PLUMAS COUNTY TAX COLLECTOR

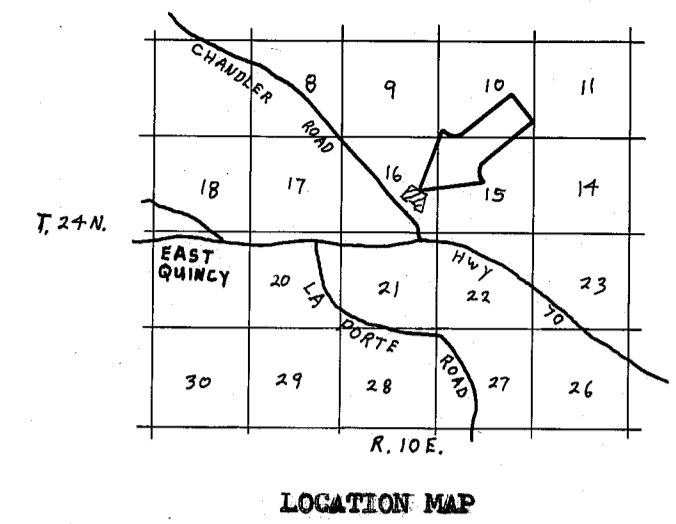

SURVEYOR'S CERTIFICATE

THIS MAP WAS PREPARED BY ME OR UNDER MY DIRECTION AND WAS COMPILED FROM RECORD DATA AND IS BASED UPON A FIELD SURVEY IN CONFORMANCE WITH THE REQUIREMENTS OF THE SUBDIVISION MAP ACT AT THE REQUEST OF GEORGE McELROY IN FEBRUARY 1978. I HEREBY STATE THAT THE PARCEL MAP PROCEDURES OF THE LOCAL AGENCY HAVE BEEN COMPLIED WITH AND THAT THIS PARCEL MAP CONFORMS TO THE APPROVED TENTATIVE MAP AND THE CONDITIONS OF APPROVAL THEREOF WHICH WERE REQUIRED TO BE FULFILLED PRIOR TO THE FILING OF THE PARCEL MAP.

Gerald C. Henderson
 GERALD C. HENDERSON LS 3297

COUNTY SURVEYOR'S CERTIFICATE

THIS MAP CONFORMS WITH THE REQUIREMENTS OF THE SUBDIVISION MAP ACT AND LOCAL ORDINANCE.

DATED 10-24-78

Clifford L. Summ LS 33836
 PLUMAS COUNTY SURVEYOR

RECORDER'S CERTIFICATE

FILED THIS 24th DAY OF October, 1978, AT 2:30 P.M. IN BOOK 6 OF PARCEL MAPS, AT PAGE 88, AT THE REQUEST OF THE COUNTY ENGINEER.

FEE \$50

RAYNELLE SLATEN
 COUNTY RECORDER

FILE NO. 3858

BY *Isabelle Andrews*
 DEPUTY

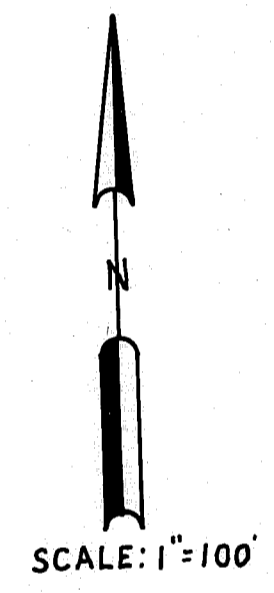

NOTES

BASIS OF BEARING IS TAKEN FROM THAT CERTAIN MAP FILED IN BOOK 5 OF PARCEL MAPS AT PAGE 134, PLUMAS COUNTY RECORDS.

CERTIFICATE OF OWNER'S CONSENT TO PREPARATION AND RECORDING OF THIS MAP IS ON FILE IN THE COUNTY ENGINEER'S OFFICE. Dated April 4, 1978

ROADS SHOWN HEREON ARE PRIVATE EASEMENTS THAT ARE ESTABLISHED BY A DECLARATION FILED CONCURRENT WITH, OR PRIOR TO RECORDATION OF THE FINAL MAP. SUCH EASEMENTS MAY NOT BECOME FULLY EFFECTIVE UNLESS AND UNTIL RESERVATIONS AND GRANTS ARE INCLUDED IN THE RESPECTIVE DEEDS.

ENGINEERED LEACH AREAS MAY BE REQUIRED FOR PARCELS 2 AND 3.

LEACH EXCLUSION AREAS ARE ALL AREAS WITHIN 100' OF EXISTING AND DESIGNATED WELLS AND SPRINGS, WITHIN 50' OF WATERCOURSES, WITHIN 50' OF PROPERTY LINES, WITHIN A DISTANCE OF 1/4 TIMES THE HEIGHT OF CUT BANKS, AND FOR ALL SLOPES OF 30% OR GREATER.

LEGEND

- FOUND CORNER AS DESCRIBED HEREON
- COMPUTED CORNER LOCATION
- ◇ SET 1/2" REBAR CAPPED LS 3297
- WATERCOURSE
- LEACH SETBACK LINE

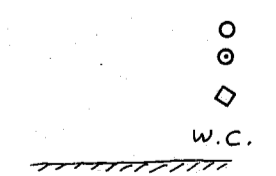

PARCEL MAP

OF A SUBDIVISION INTO FOUR PARTS
 FOR
 GEORGE & PATRICIA McELROY FEBRUARY 1978
 PORTION OF SECTION 16, T. 24N., R. 10E., MEM
 PARCEL 3 IN BOOK 5 OF PARCEL MAPS AT PAGE 134
 PLUMAS COUNTY, CALIFORNIA

GERALD C. HENDERSON
 LICENSED LAND SURVEYOR
 P. O. BOX 1377
 PORTOLA, CALIFORNIA

Dec 25th 1978
 297 OR 471

6 PM 88