

SURVEYOR'S CERTIFICATE

THIS MAP WAS PREPARED BY ME OR UNDER MY DIRECTION AND IS BASED UPON A FIELD SURVEY IN CONFORMANCE WITH THE REQUIREMENTS OF THE SUBDIVISION MAP ACT AT THE REQUEST OF JACOB S. & EVELYN HYAMS AND IRWIN & RUTH LEVENSON ON 8-2-75. I HEREBY CERTIFY THAT IT CONFORMS TO THE APPROVED TENTATIVE MAP AND THE CONDITIONS OF APPROVAL THEREOF.

Richard A. Lundy
R.C.E. No. 15265

COUNTY TAX COLLECTOR'S CERTIFICATE

I, TAX COLLECTOR OF THE COUNTY OF PLUMAS, STATE OF CALIFORNIA, DO HEREBY CERTIFY THAT THERE ARE NO TAX LIENS AGAINST THE PARCELS, AS SHOWN HEREON, FOR UNPAID COUNTY, MUNICIPAL, OR LOCAL TAXES OR SPECIAL ASSESSMENTS COLLECTED AS TAXES, EXCEPT TAXES OR ASSESSMENTS NOT YET PAYABLE. TAXES OR ASSESSMENTS WHICH ARE A LIEN BUT NOT YET PAYABLE, ARE ESTIMATED TO BE IN THE AMOUNT OF \$None.

Douglas S. Redstreak
DOUGLAS S. REDSTRAKE
PLUMAS COUNTY TAX COLLECTOR

RECORDER'S CERTIFICATE

FILED THIS 17TH DAY OF November, 1975, AT 9:20 A.M. IN BOOK 5 OF Land Maps, AT Pg. 53 THE REQUEST OF JACOB S. & EVELYN HYAMS AND IRWIN & RUTH LEVENSON.

SIGNED *Dorothy Neer Marley*
DOROTHY NEER MARLEY
COUNTY RECORDER

FEE: \$5.00
FILE NO: 1075

Lana L. Brown

COUNTY SURVEYOR'S CERTIFICATE

THIS MAP CONFORMS WITH THE REQUIREMENTS OF THE SUBDIVISION MAP ACT AND LOCAL ORDINANCE.

DATED: 11-14-75

SIGNED: *Larry A. Fites*
LARRY A. FITES, RCE # 13227
COUNTY ENGINEER

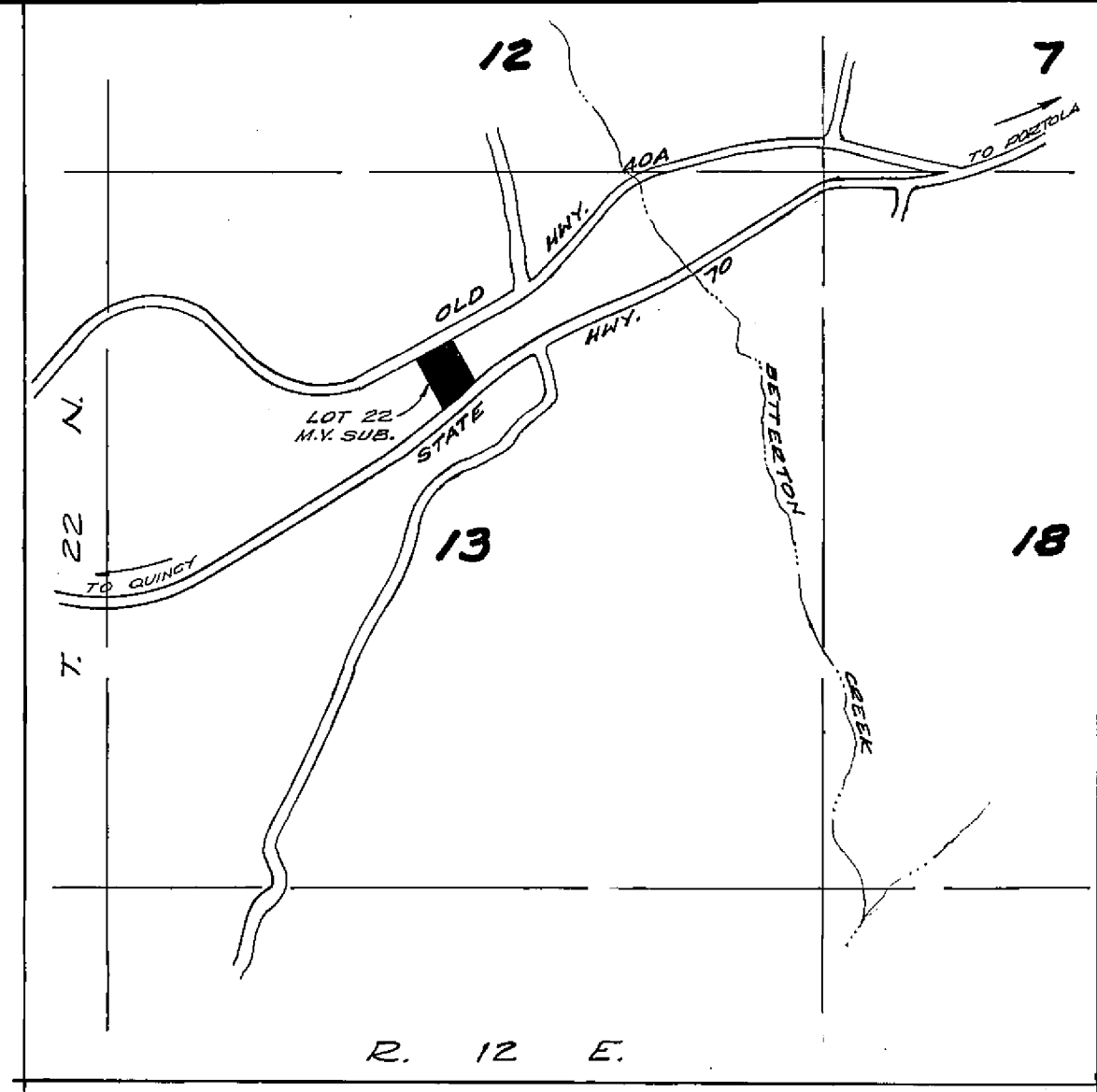

LOCATION MAP
SCALE 1" = 1320'

NOTE: BASIS OF BEARING BOOK 3 OF PARCEL MAPS AT PAGE 4, PLUMAS COUNTY RECORDS.

LEGEND

- FOUND PROPERTY CORNER
- SET PROPERTY CORNER
- WELL
- LEACH EXCLUSION AREA
- EASEMENT LINE



PARCEL MAP
OF
A SUBDIVISION INTO TWO PARTS
OF
LOT 22, MOHAWK VISTA SUBDIVISION

FOR
JACOB S. & EVELYN HYAMS
AND
IRWIN & RUTH LEVENSON
RECORD OWNERS
SEC. 13, T. 22 N., R. 12 E., M.D.M.