

MAP NOTES

- FOUND 1" IRON PIPE, Tagged L.S. 3202
- ⊗ FOUND 3/8" REINFORCING ROD
- SET CORNER, Tagged R.C.E. 8596
- BASIS OF BEARINGS, Bk. 4 P.M. P. 82A

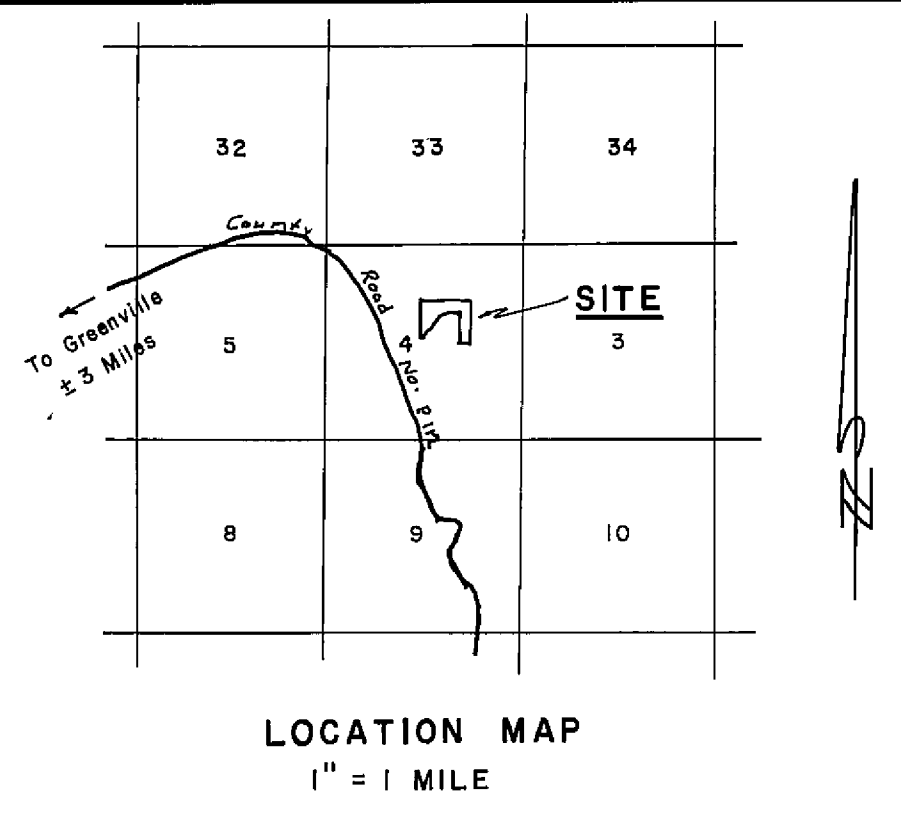

SURVEYOR'S CERTIFICATE

THIS MAP WAS PREPARED BY ME OR UNDER MY DIRECTION (AND IS BASED UPON A FIELD SURVEY) IN CONFORMANCE WITH THE SUBDIVISION MAP ACT AT THE REQUEST OF CAROLE BUNTING, MARCH 20, 1975. I HEREBY CERTIFY THAT IT CONFORMS TO THE APPROVED TENTATIVE MAP AND THE CONDITIONS OF APPROVAL THEREOF; THAT ALL PROVISIONS OF APPLICABLE STATE LAW AND LOCAL ORDINANCES HAVE BEEN COMPLIED WITH.

Darrell P. Payne
DARRELL P. PAYNE, R.C.E. 8596

COUNTY TAX COLLECTOR'S CERTIFICATE

I, THE UNDERSIGNED, COUNTY TAX COLLECTOR OF THE COUNTY OF PLUMAS, STATE OF CALIFORNIA, DO HEREBY CERTIFY THAT THERE ARE NO TAX LIENS AGAINST PARCEL 1 OR 2 AS SHOWN HEREON OR UNPAID STATE, COUNTY, MUNICIPAL OR LOCAL TAXES, OR SPECIAL ASSESSMENTS NOT YET PAYABLE. TAXES OR ASSESSMENTS WHICH ARE A LIEN BUT NOT YET PAYABLE, ARE ESTIMATED TO BE IN THE AMOUNT OF \$170.00.

Douglas S. Redstreak
DOUGLAS S. REDSTREAKE
PLUMAS COUNTY TAX COLLECTOR

PARCEL MAP
OF
SUBDIVISION OF TWO PARCELS

FOR
CAROLE E. BUNTING

RECORD OWNER
THE W. 1/2, N.E. 1/4, SECTION 4, T.26N., R.10E., M.D.M.

PARCEL 1 AND 2 BEING PARCEL B OF BOOK 4 OF P.M., PAGE 82A
PLUMAS COUNTY CALIFORNIA

COUNTY SURVEYOR'S CERTIFICATE

THIS MAP CONFORMS WITH THE REQUIREMENTS OF THE SUBDIVISION MAP ACT AND LOCAL ORDINANCE.

DATED: 7-10-75
Larry A. Fites
LARRY A. FITES, R.C.E. 13225
PLUMAS COUNTY SURVEYOR

COUNTY RECORDER'S CERTIFICATE

FILED THIS 10TH DAY OF July, 1975, AT 4:30 P.M. IN BOOK 5 OF PARCEL MAPS AT PAGE 20 AT THE REQUEST OF DARRELL P. PAYNE.

Fee: \$5.00
FILE NO. 180
Dorothy Heer Harley
PLUMAS COUNTY RECORDER by *Barry Laplander*