

**LEGEND**

- Found 1/2" Steel Pin and plastic cap, R.C.E. 11173
- Set 1/2" Steel Pin with plastic cap stamped "R.C.E.11173"
- Survey point only. No monument set
- O.R. Official Records, Plumas County records
- Bk. Book
- p. Page
- R.C.E. Registered Civil Engineer

**NOTE**

Tentative Parcel Map approved by Plumas County Planning Commission August 2, 1972.

**COUNTY TAX COLLECTOR'S CERTIFICATE**

I, the undersigned, County Tax Collector of the County of Plumas, State of California, do hereby certify that there are no tax liens against Parcels 1A, 1B, or 1C as shown hereon, or unpaid state, county municipal or local taxes, or spl. assessments collected as taxes, except taxes or assessments not yet payable. Taxes or assessments which are a lien but not yet payable, are estimated to be in the amount of NONE.

*Douglas S. Redstroake*  
 Douglas S. Redstroake  
 Plumas County Tax Collector

**SURVEYOR'S CERTIFICATE**

This map was prepared by me or under my direction (and is based upon a field survey) in conformance with the Subdivision Map Act at the request of Luther Love, August 14, 1972. I hereby certify that it conforms to the approved tentative map and the conditions of approval thereof; that all provisions of applicable state law and local ordinances have been complied with.

*John C. Simpson*  
 John C. Simpson  
 R.C.E. 11173

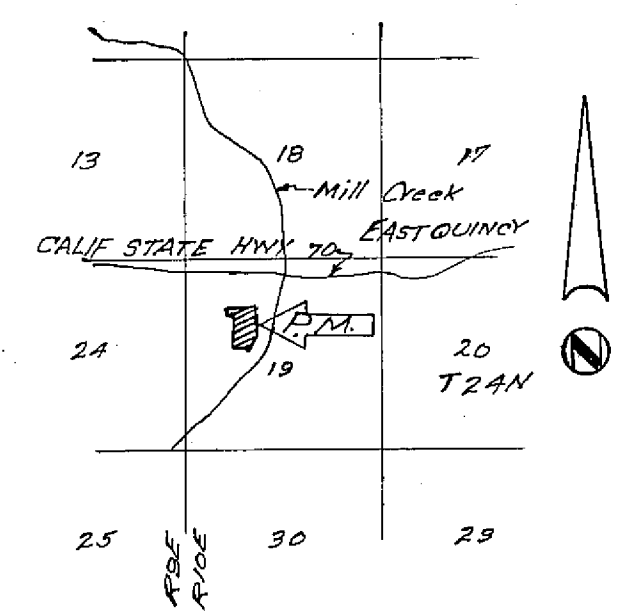

LOCATION MAP  
 No SCALE

**NOTE**

Bearings are grid bearings, Calif. State Coordinate System, Zone 1.  
 Distances are ground distances. Deduct 0.015' per 100' to obtain grid distances.

**RECORDER'S CERTIFICATE**

Filed this 14 day of September, 1972, at 12:15 P.M. in Book 3 of Parcel Maps at Page 2 at the request of John C. Simpson.

*Dorothy Newmarley*  
 Plumas County Recorder

**COUNTY SURVEYOR'S CERTIFICATE**

This map has been examined this 5<sup>th</sup> day of Sept, 1972, for conformance with the requirements of Section 11575 of the Subdivision Map Act.

*Danell V. Payne*  
 Plumas County Surveyor



**PARCEL MAP**  
 OF  
**SUBDIVISION OF THREE PARCELS**

FOR  
**LUTHER LOVE AND RUBY M. LOVE**  
 RECORD OWNERS  
 WITHIN THE NW 1/4, SEC. 19, T.24N, R.10E, M.D.M.  
 PLUMAS COUNTY, CALIFORNIA

JOHN C. SIMPSON, PE.  
 CIVIL ENGINEER  
 P.O. BOX 719  
 QUINCY, CALIFORNIA

Fee \$5.00  
 File No. 913

3pm120